



SESAME APARTMENTS

LONDON, SW11



SESAME APARTMENTS BATTERSEA, SW11

A beautifully presented two-bedroom, two-bathroom apartment with a balcony and secure underground parking, located moments from the River Thames.



2



2



1

EPC

B

Local Authority: London Borough of Wandsworth

Council Tax band: E

Tenure: Leasehold, approximately 987 year remaining

Service charge: £4,541.74 per annum, reviewed annually, next review due 2026

Ground rent: £450 per annum, reviewed annually, next review due 2026

Guide Price: £595,000



A BRIGHT TWO-BEDROOM APARTMENT WITH A BALCONY

This lovely lateral apartment is located on the fifth floor of a contemporary residential development in Battersea. The bright open-plan kitchen reception room boasts sleek integrated appliances and provides access to a west-facing balcony. There are two double bedrooms with built-in storage; the principal bedroom has an ensuite shower room and there is an additional bathroom to service the second bedroom. The property further benefits from storage cupboards in the hallway, and a secure underground parking space.

Sesame Apartments is a contemporary residential development with lift access and a concierge, enviably positioned close to the south bank of the River Thames between Battersea and Wandsworth Bridges. This sought-after riverside location offers an exceptional blend of tranquillity and convenience, with beautiful river walks and green open spaces such as Battersea Park and Wandsworth Park within easy reach.







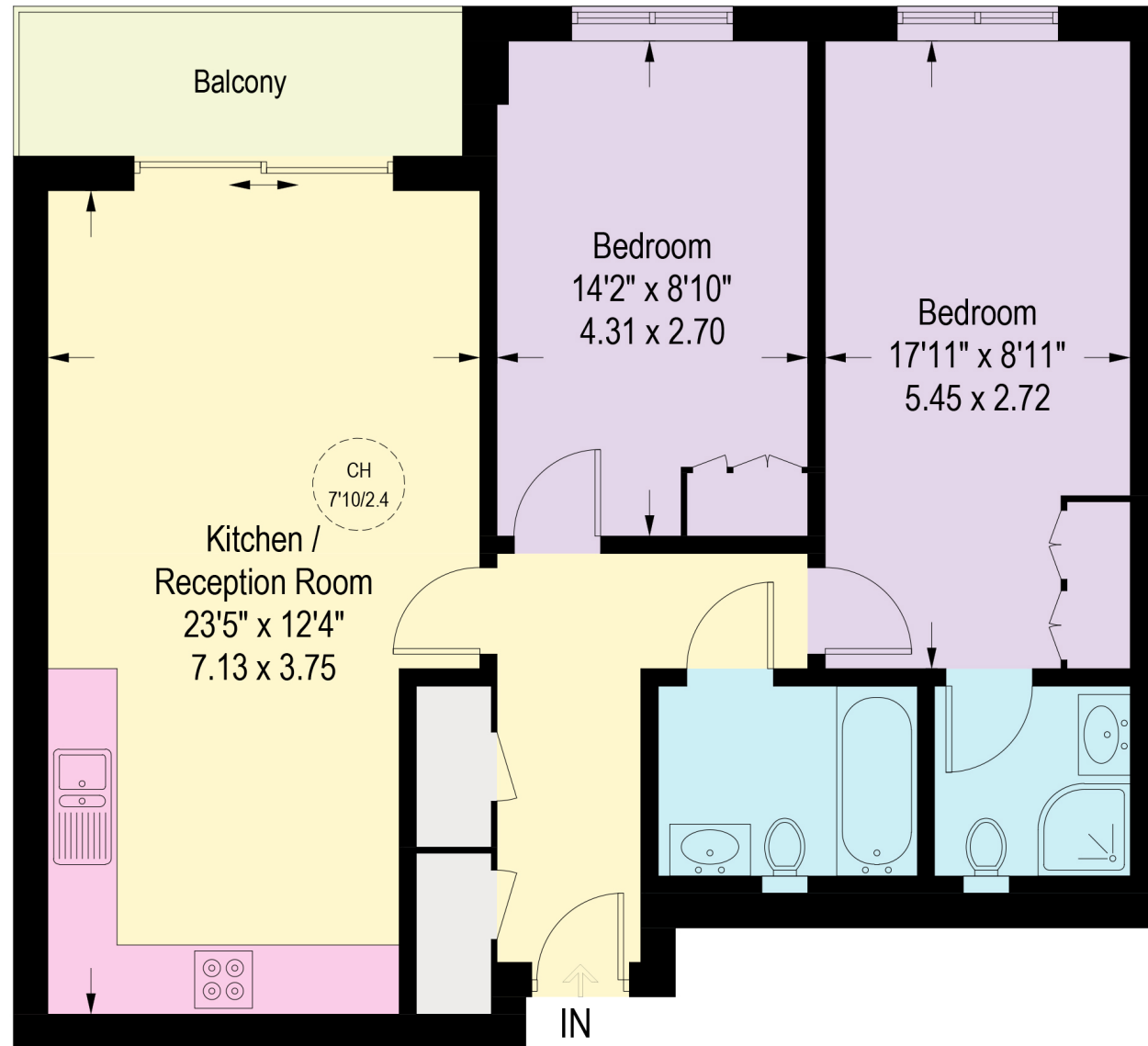

Fifth Floor

Approximate Gross Internal Area = 69.77 sq m / 751 sq ft

This plan is for layout guidance only. Not drawn to scale unless stated. Windows and door openings are approximate. Whilst every care is taken in the preparation of this plan, please check all dimensions, shapes and compass bearings before making any decisions reliant upon them. (ID767266)

We would be delighted
to tell you more.

Sarah Gerrett

+44 203 866 2924

sarah.gerrett@knightfrank.com

Knight Frank Battersea & Clapham

346 Queenstown Road

London, SW11 8BY

knightfrank.co.uk

Your partners in property

1. Particulars: These particulars are not an offer or contract, nor part of one. You should not rely on statements given by Knight Frank in the particulars, by word of mouth or in writing ("information") as being factually accurate about the property, its condition or its value. Neither Knight Frank nor any joint agent has any authority to make any representations about the property, and accordingly any information given is entirely without responsibility on the part of Knight Frank. 2. Material Information: Please note that the material information is provided to Knight Frank by third parties and is provided here as a guide only. While Knight Frank has taken steps to verify this information, we advise you to confirm the details of any such material information prior to any offer being submitted. If we are informed of changes to this information by the seller or another third party, we will use reasonable endeavours to update this as soon as practical. 3. Photos, Videos etc: The photographs, property videos and virtual viewings etc. show only certain parts of the property as they appeared at the time they were taken. Areas, measurements and distances given are approximate only. 4. Regulations etc: Any reference to alterations to, or use of, any part of the property does not mean that any necessary planning, building regulations or other consent has been obtained. A buyer must find out by inspection or in other ways that these matters have been properly dealt with and that all information is correct. 5. Fixtures and fittings: A list of the fitted carpets, curtains, light fittings and other items fixed to the property which are included in the sale (or may be available by separate negotiation) will be provided by the Seller's Solicitors. 6. VAT: The VAT position relating to the property may change without notice. 7. To find out how we process Personal Data, please refer to our Group Privacy Statement and other notices at <https://www.knightfrank.com/legals/privacy-statement>.

Particulars dated May 2024. Photographs and videos dated May 2024. All information is correct at the time of going to print. Knight Frank is the trading name of Knight Frank LLP. Knight Frank LLP is a limited liability partnership registered in England and Wales with registered number OC305934. Our registered office is at 55 Baker Street, London W1U 8AN. We use the term 'partner' to refer to a member of Knight Frank LLP, or an employee or consultant. A list of members names of Knight Frank LLP may be inspected at our registered office. If you do not want us to contact you further about our services then please contact us by either calling 020 3544 0692, email to marketing.help@knightfrank.com or post to our UK Residential Marketing Manager at our registered office (above) providing your name and address.