



**3 BEDROOM SEMI-DETACHED HOUSE  
WITH SINGLE GARAGE AND SUNNY  
GARDEN.      GUIDE PRICE £500,000**

9 Oakwood Close, Redhill, RH1 4BE

Offered chain-free, this spacious 3-bedroom semi-detached home presents an exciting opportunity for those looking to modernise and make it their own. Situated on a generous plot with a sunny west-facing garden, the property also benefits from a single garage and off-street parking. Inside, the well-proportioned accommodation includes two reception rooms, a kitchen, three generous bedrooms, and a bathroom with a separate WC. Outside, there is a delightful west facing garden with patio and lawn. Full of potential and perfectly located for families or investors alike—this is one not to miss.



lewis  
white

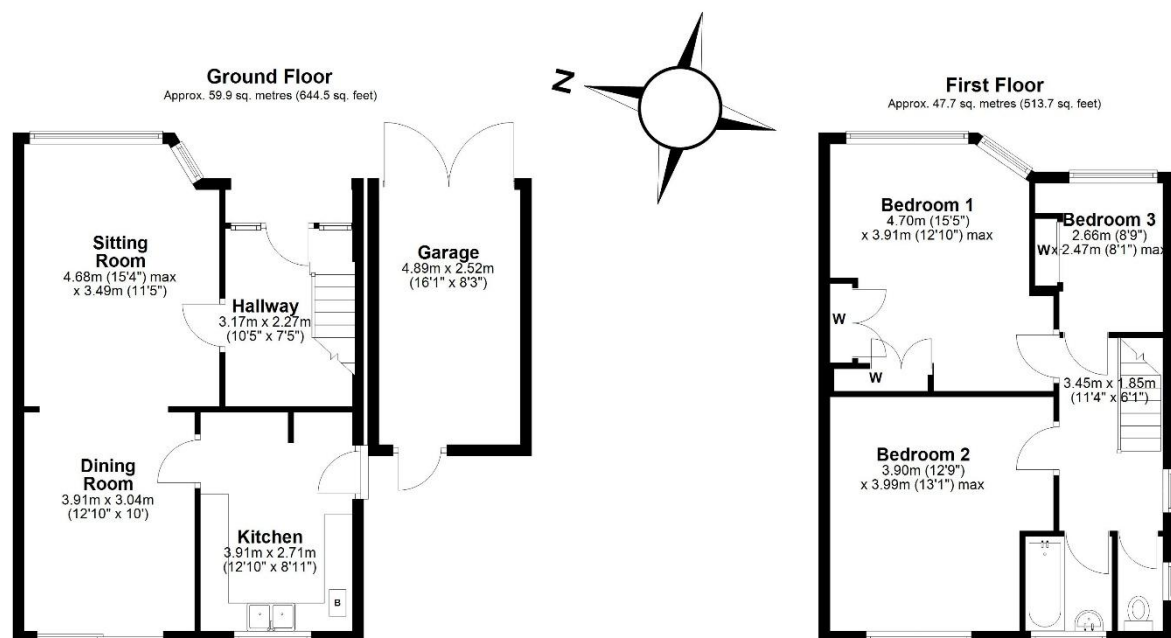

Total area: approx. 107.6 sq. metres (1158.2 sq. feet)



Council tax band: E EPC: D.

Lewis White Estate Agents, Somers House, Linkfield Corner, RH1 1BB. 01737 245779 [info@lewiswhite.net](mailto:info@lewiswhite.net) [www.lewiswhite.net](http://www.lewiswhite.net)