

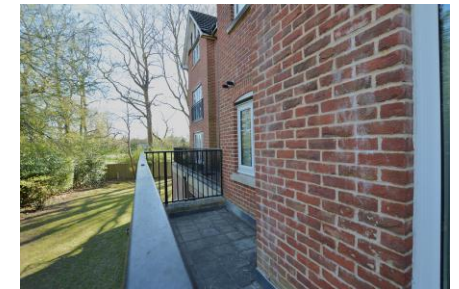

# SPACIOUS 1ST FLOOR, 1 BEDROOM APARTMENT

29 Clarke House, Woodlands Road, RH10 8BG  
Guide price £185,000

Stylish and spacious, this beautifully presented 1-bedroom, 1st-floor apartment boasts a private balcony and an airy open-plan living space, perfect for relaxing or entertaining. The sleek modern kitchen offers ample storage, while the generously sized double bedroom is bathed in morning sunlight. Thoughtfully designed with two hallway storage cupboards, this home also benefits from lift access, residents' gardens, and allocated parking. Offered chain-free for a seamless move—don't miss out on this gem! Service charge/ ground rent £97.26 per month. EPC C. Council Tax B. 83 year lease. Chain free.



lewis  
white

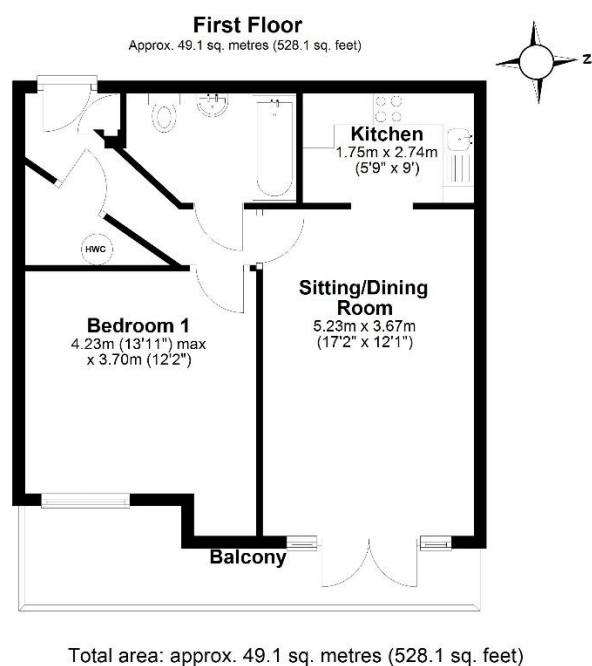

83 year lease, maintenance charge/ ground rent of £97.26 per month Council tax B, EPC C. Electric heating and double glazed.