



**ENERGY EFFICIENT 3 BEDROOM SEMI-
DETACHED HOUSE WITH SINGLE
GARAGE. GUIDE PRICE £450,000**

22 Wilton Road, Redhill, Surrey, RH1 6QR

Welcome to this sleek three-bedroom home, designed for contemporary living with energy efficiency in mind. Built just 11 years ago, this residence offers comfort, style, and sustainability. Step into the heart of the home, a sleek fitted kitchen with space for dining. High-quality fixtures and modern appliances make cooking a delight, while ample storage ensures everything has its place. Unwind in the inviting living room, illuminated by natural light from French doors leading to a charming courtyard garden. This private courtyard garden is perfect for enjoying sunny days or hosting intimate gatherings. Upstairs, three bedrooms provide peaceful retreats, with the master bedroom offering a serene escape. The contemporary bathroom features modern fixtures and a soothing atmosphere for relaxation. A single garage and private driveway offer parking and storage, while gas central heating and double-glazed windows ensure energy efficiency and comfort throughout the year. Situated in a sought-after Neighbourhood, this home provides easy access to schools, parks, and amenities. Excellent transport links make commuting effortless, enhancing the convenience of this prime location. Don't miss out on this opportunity to own a modern, energy-efficient property that perfectly combines style and sustainability. Schedule a viewing today and experience the epitome of contemporary living. (library photos)





Bathroom



Rear garden



Bedroom 1

Ground Floor

Approx. 40.0 sq. metres (430.2 sq. feet)

First Floor

Approx. 40.1 sq. metres (431.3 sq. feet)

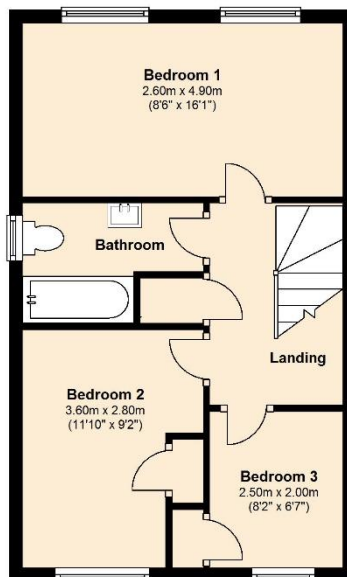
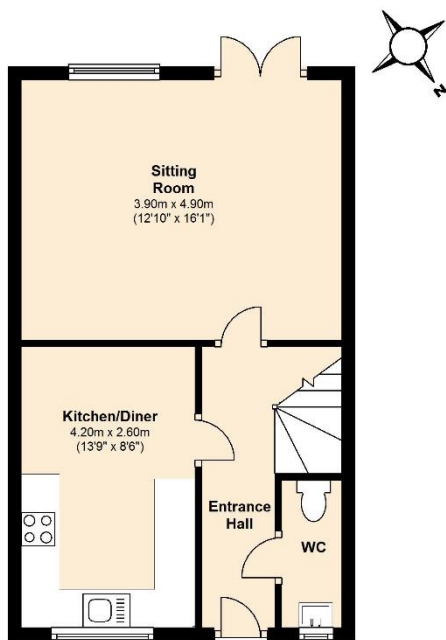

Total area: approx. 76.8 sq. metres (827.0 sq. feet)

These drawings are not to scale and are for representational purposes only. Brian Blunden
Plan produced using The Mobile Agent.



Council tax band: C EPC: C.

Lewis White Estate Agents, Somers House, Linkfield Corner, RH1 1BB. 01737 245779 info@lewiswhite.net www.lewiswhite.net