



SPACIOUS 2ND FLOOR, 2 BEDROOM APARTMENT

17 Harlow Court, Wray Comon Road, Reigate,
Surrey, RH2 0RJ £345,000

Stunning second-floor apartment boasting 2 spacious bedrooms with fitted wardrobes, this beauty offers a dream kitchen - fully refitted including appliances. South-facing sitting room bathed in sunshine with your very own Juliette balcony. The modern bathroom has a white suite, while the generous hallway provides ample storage with its fitted cupboards. Stay cosy with gas central heating and double glazing, outside enjoy the perks of communal grounds for a touch of greenery. Both Reigate and Redhill stations and town centres a short stroll away. Private garage for your chariot, and a Share of freehold (987 year lease) maintenance charge of £1,600 per annum and £0 ground rent. Council tax C. EPC: C. Chain free.



lewis
white

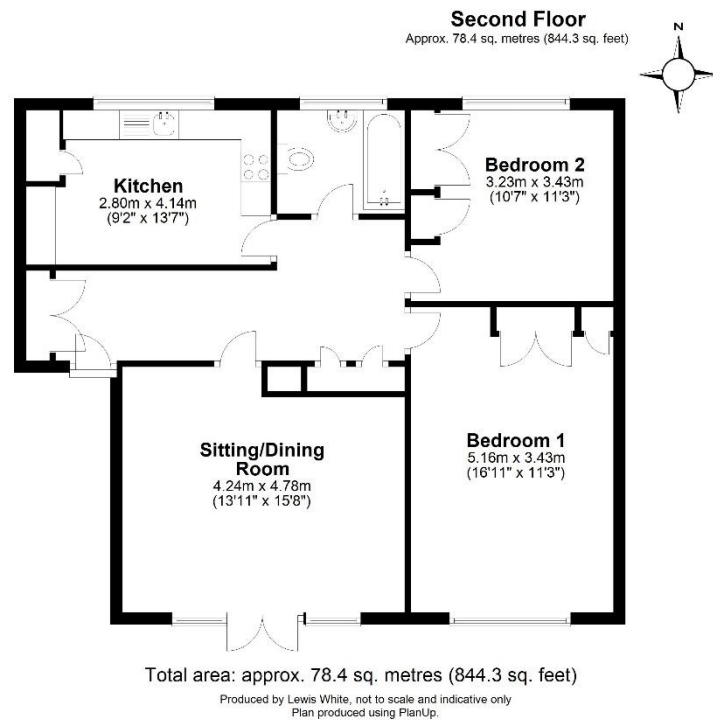

Share of freehold (987 year lease) maintenance charge of £1,600 per annum and £0 ground rent. Council tax C, EPC D.