



Offered TO LET is this fantastic and very modern ground floor maisonette. This home offers entrance hall, open plan lounge-kitchen with fridge/freezer, washer/dryer/cooker/hob and microwave fitted. The bedroom is fitted with wardrobes and brand-new carpets, whilst the bathroom is four piece immaculate suite, allocated parking. DONT MISS OUT ON THIS CALL FOR YOUR VIEWING ASAP!!

**Price Monthly Rental Of £900**



GROUND FLOOR

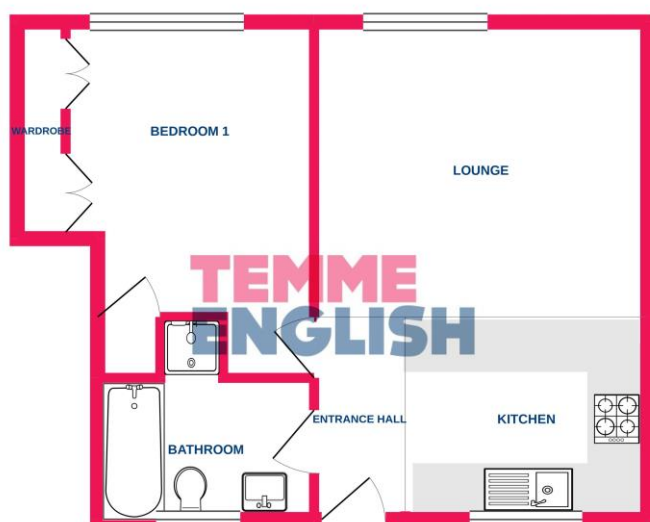

Whilst every attempt has been made to ensure the accuracy of the floorplan contained herein, measurements of doors, windows, rooms and any other items are approximate and no responsibility is taken for any error, omission or misstatement. This plan is for illustrative purposes only and should be used as such for the only prospective purchaser. The services, systems and appliances shown have not been tested and no guarantee as to their operability or efficiency can be given.  
Made with floorplan 11/2020

- **Stunning Interior**
- **Entrance Hall**
- **Open Plan Living Area (20'1 x 11'3)**
- **Modern Kitchen with Integrated Appliances**
- **Trendy Lounge area**
- **Stunning Four Piece Bathroom**
- **Master Bedroom (14'0 Max, 11'8)**
- **Allocated Parking Space**
- **Brand New Carpets Fitted To Bedroom**

