



Oakleigh Park North, Whetstone, N20 9BB  
Asking Price £475,000 Share of Freehold

Council Tax Band E

**REAL ESTATES**  
Est.1981

Estate Agents · Residential Sales · Investments · Lettings

**\*CHAIN FREE \*** A 2 bedroom ground floor apartment situated in one of Whetstone's most desirable road, within easy reach of the High Street, bus routes and local shops.

The property offers spacious accommodation including an entrance hallway, living room with direct access onto a private patio and communal gardens, kitchen/breakfast room, master bedroom with en-suite bathroom and further bedroom and family bathroom.

The development is surrounded by well tended and mature communal gardens and benefits from a SHARE OF FREEHOLD.

Early viewing advised via seller's sole agent.





# Oakleigh Park North, London, N20

Approximate Area = 807 sq ft / 74.9 sq m  
For identification only - Not to scale

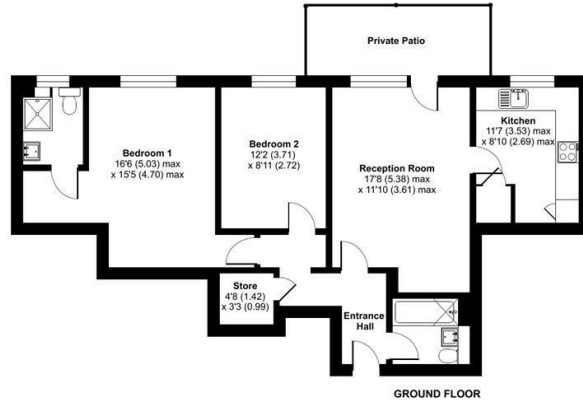

Certified Property Measurer  
Floor plan produced in accordance with RICS Property Measurement Standards incorporating International Property Measurement Standards (IPMS Residential). © rinchcom 2023. Produced for Real Estates. REF: 878893.

Energy Efficiency Rating		Current	Potential
Very energy efficient - lower running costs	A		88
Energy efficient - lower running costs	B		
Decent energy efficiency - lower running costs	C	67	
Some energy efficiency - lower running costs	D		
Low energy efficiency - higher running costs	E		
Very low energy efficiency - higher running costs	F		
Least energy efficient - higher running costs	G		

EU Directive



Real EstatesTottenham Office:  
32 Tottenham Lane  
Tottenham N20 9QJ

ll : 0208 445 3132  
e : info@realestates-wsp.co.uk  
w : www.realestates-wsp.co.uk