



Laurel Way, Totteridge, N20 8HT
Offers In Excess Of £1,000,000 Freehold Council Tax Band G

REAL ESTATES
Est.1981

Estate Agents · Residential Sales · Investments · Lettings

A 4 BEDROOM DETACHED FAMILY HOME in the heart of Totteridge, offering generous living accommodation and a south facing rear garden benefiting from a planning permission in place for a new build property in excess of 3000 sq ft.

Laurel Way is conveniently located for both Woodside Park and Totteridge & Whetstone Northern Line tube stations, Greenbelt and primary school catchment area.

* GUEST CLOAKROOM * FITTED KITCHEN * THRU LOUNGE/DINING ROOM * CONSERVATORY * LEAN-TO (UTILITY ROOM) * STUDY * TV ROOM * 4 BEDROOMS * 2 BATHROOMS (1 EN SUITE) * OFF STREET PARKING FOR 3 CARS *

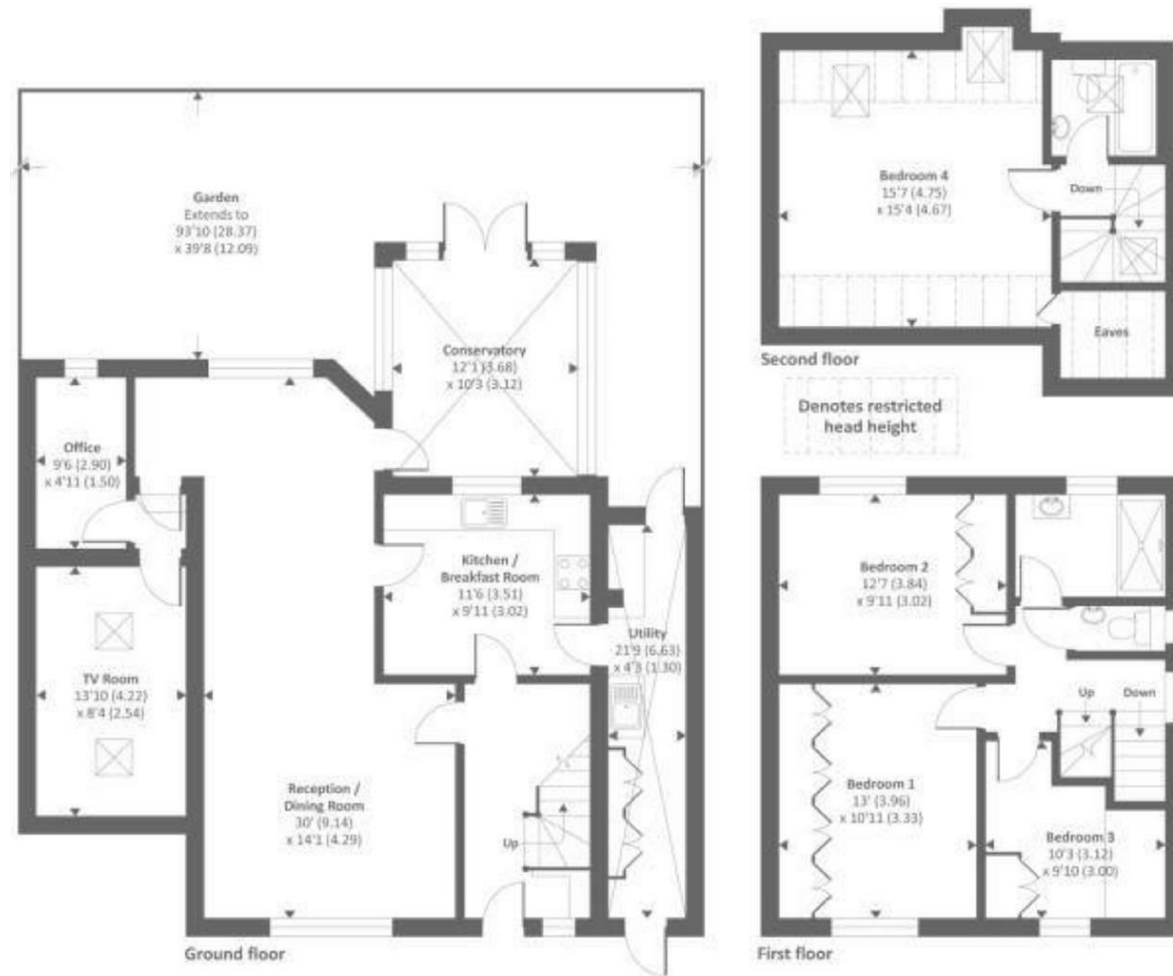

Approx. Gross internal floor area 1771 SQFT / 164.5 SQM (Excludes restricted head height)

