



105 Passingham Ave, Billericay - CM11 2TB

£475,000 Freehold

Discover this inviting extended 3-bedroom semi-detached house with ****NO ONWARD CHAIN**** having undergone a complete TRANSFORMATION throughout.

Council Tax band: D ~ EPC Energy Efficiency Rating: D



tyler estates

01277 626181

www.tylerestates.co.uk



- Porch**
- Entrance Hall**
- Lounge / Diner**
24' 6" x 10' 9" (7.46m x 3.27m)
- Sitting Room / Study**
9' 3" x 8' 7" (2.82m x 2.61m)
- Kitchen**
10' 6" x 7' 11" (3.19m x 2.41m)
- Utility Area with WC**
- Landing**
- Bedroom One**
10' 10" x 10' 8" (3.30m x 3.25m)
- Bedroom Two**
11' 3" x 10' 8" (3.43m x 3.25m)
- Bedroom Three**
7' 9" x 6' 2" (2.36m x 1.87m)
- Bathroom**

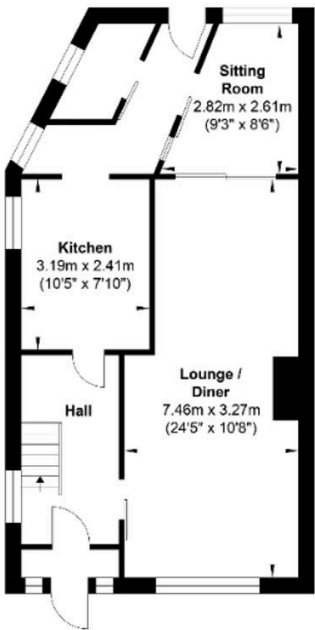

Ground Floor

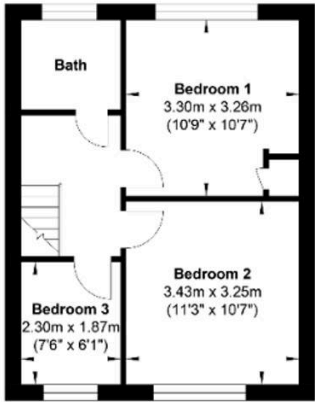

First Floor

Gross Internal Floor Area : 87.62 m2 ... 943.13 ft2

Whilst every attempt has been made to ensure the accuracy of the floor plan contained here, measurements of doors, windows, rooms and any other items are approximate and no responsibility is taken for any error, omission, or mis-statement. This plan is for illustrative purposes only and should be used as such by any prospective purchaser. The services, systems and appliances shown have not been tested and no guarantee as to their operability or efficiency can be given.