



69 Bridgecote Lane, Basildon – SS15 4BW

Offers in excess of £400,000 Freehold

A charming 2 bedroom detached cottage with beamed ceilings on the ground floor, complemented by a conservatory that offers serene views of the low maintenance rear garden boasting an artificial lawn and edged borders creating a neat and welcoming space.

Council Tax band: D ~ EPC Energy Efficiency Rating: C



tyler estates

01277 626181

www.tylerestates.co.uk



Entrance Hall

The entrance hall introduces you to the character found throughout this property, with a stable front door and beamed ceilings.

Kitchen 15' 8" x 12' 2" (4.78m x 3.72m)

This cottage style kitchen incorporates a range of cream units, an undercounter electric oven with electric hob and extractor over.

Lounge 15' 8" x 12' 2" (4.78m x 3.72m)

A spacious lounge, with the continued beamed ceiling, practical laminate flooring and radiator for heating.

Conservatory 9' 10" x 8' 7" (3.00m x 2.62m)

Half brick conservatory is centrally heated with a solid roof, tiled flooring and French doors opening onto the rear garden.

Bedroom 12' 7" x 10' 10" (3.83m x 3.29m)

A generous double bedroom with carpet to the floor, dual aspect windows and bank of triple in-built wardrobe storage.

Bedroom 7' 9" x 7' 9" (2.35m x 2.35m)

A single bedroom with a Velux window to the side.

Bathroom 10' 9" x 4' 11" (3.27m x 1.50m)

Office 9' 6" x 8' 2" (2.90m x 2.48m)

Using part of the garage to make the perfect work from home space.

Store 6' 8" x 8' 11" (2.03m x 2.72m)

Double doors open to the front providing ample space for storage.

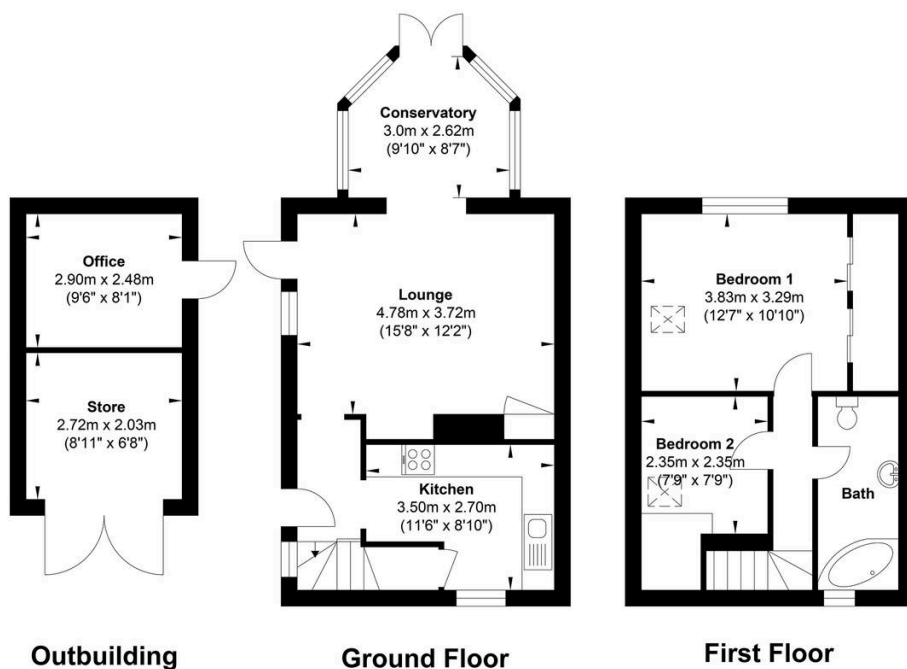

Gross Internal Floor Area : 89.47 m2 ... 963.04 ft2

Whilst every attempt has been made to ensure the accuracy of the floor plan contained here, measurements of doors, windows, rooms and any other items are approximate and no responsibility is taken for any error, omission, or mis-statement. This plan is for illustrative purposes only and should be used as such by any prospective purchaser. The services, systems and appliances shown have not been tested and no guarantee as to their operability or efficiency can be given.