



17 Bramble Tye, Laindon – SS15 5GR

£325,000 Freehold

Council Tax band: C ~ EPC Energy Efficiency Rating: C



tyler estates

01277 626181

www.tylerestates.co.uk



Entrance Hall

Lounge

16' 10" x 11' 7" (5.14m x 3.54m)

Offering good space with a set of French doors leading into the rear garden.

Kitchen

10' 6" x 5' 10" (3.20m x 1.79m)

Located at the front of the property with space for a washing machine and fridge freezer. The kitchen has a gas hob and an electric oven,

Bedroom one

11' 7" x 10' 2" (3.54m x 3.11m)

Located at the rear of the home overlooking the garden.

Bedroom two

11' 7" x 9' 6" (3.54m x 2.90m)

Another good size bedroom with a built in cupboard.

Bathroom

6' 11" x 5' 3" (2.10m x 1.60m)

Newly fitted. Tiled floor and walls with a full length bath, wash hand basin in vanity unit and w.c.

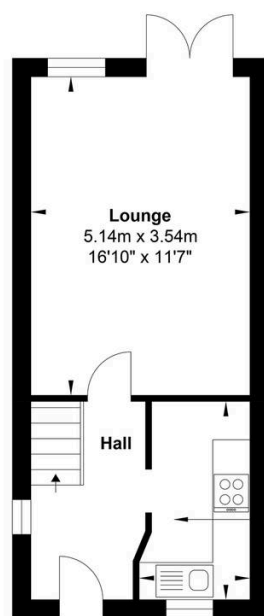

Ground Floor

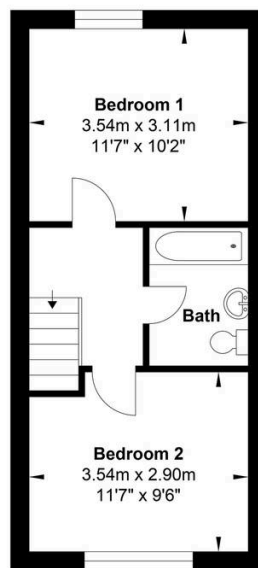

First Floor

Gross Internal Floor Area : 59.76 m2 ... 643.25 ft2

Whilst every attempt has been made to ensure the accuracy of the floor plan contained here, measurements of doors, windows, rooms and any other items are approximate and no responsibility is taken for any error, omission, or mis-statement. This plan is for illustrative purposes only and should be used as such by any prospective purchaser. The services, systems and appliances shown have not been tested and no guarantee as to their operability or efficiency can be given.