



13 Passingham Close, Billericay - CM11 2TH

£439,000 Freehold

A spacious three bedroom semi-detached house with block paved drive for off-street parking located in a small friendly close. An ideal family home within walking distance to local schools, park, shops and bus route. Inside has a light airy feel with delightful south west facing garden.

Council Tax band: D ~ EPC Energy Efficiency Rating: D



tyler estates

01277 626181

www.tylerestates.co.uk



Entrance Hall

14' 8" x 6' 0" (4.47m x 1.82m)

Kitchen

10' 6" x 7' 10" (3.19m x 2.39m)

Lounge/Diner

24' 10" x 10' 8" (7.57m x 3.25m)
(7.57m x 3.25m > 2.66m)

Landing**Bedroom One**

13' 3" x 10' 8" (4.04m x 3.25m)

Bedroom Two

11' 6" x 10' 8" (3.51m x 3.26m)

Bedroom Three

7' 10" x 6' 2" (2.40m x 1.88m)

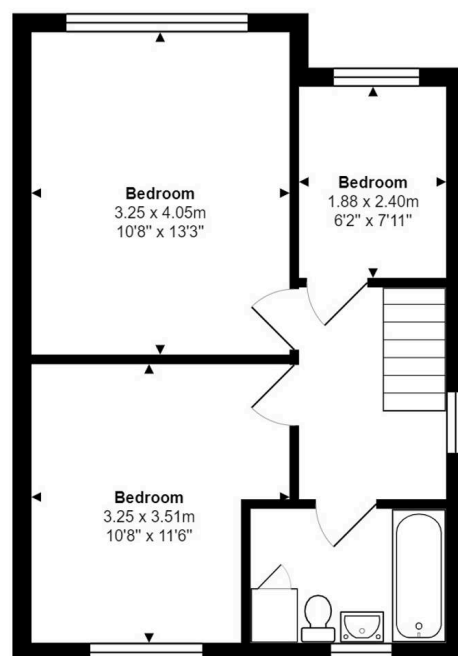
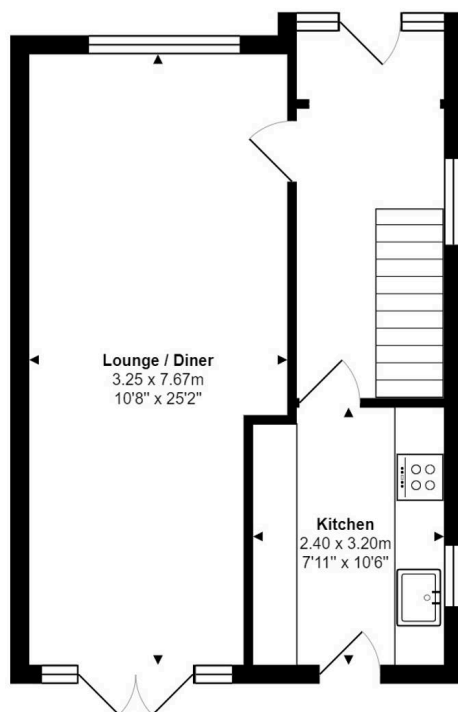
Bathroom

Total Area: 79.3 m² ... 853 ft²

Measurements are approximate for illustrative purposes only and may have been taken from the widest area
Floorplan Copyright The Estate Agents Photographer
www.theestategentsphotographer.co.uk