



SIMPLY HOMES

The Avenue

Welwyn AL6 0PW

Price Guide £1,500,000



The Avenue

Welwyn AL6 0PW





Ground floor and 1st floor total area approx 2189.6 sq. feet (203.4 sq.m.)

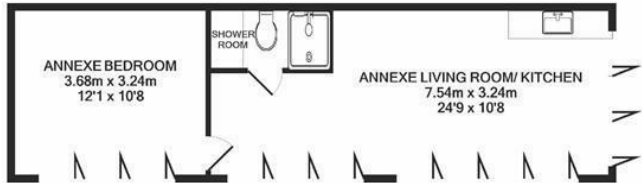

Annexe total approx floor area 391 sq. feet (36.4 sq.m.)

Whilst every attempt has been made to ensure the accuracy of the floor plan contained here, measurements of doors, windows, rooms and any other items are approximate and no responsibility is taken for any error, omission, or mis-statement. This plan is for illustrative purposes only and should be used as such by any prospective purchaser. The services, systems and appliances shown have not been tested and no guarantee as to their operability or efficiency can be given.
Made with Metropix ©2021

TOTAL FLOOR AREA APPROX 2580.6 SQ.FEET (239.8 SQ.M.)



SIMPLY HOMES

115 Fore Street | Hertford | SG14 1AS | 01992 558 557 | sales@simply-homes.co.uk | simply-homes.co.uk | Find us on

