

**AVAILABLE**



APARTMENT

**DACRES ROAD  
LEWISHAM  
LONDON  
SE23 2NS**

Per Month

**£1900 PCM**

**FEATURES**

- Stunning Apartment
- 2 Bathrooms
- Immediate Move In Available
- Modern
- 2 Bedrooms
- Open Plan Kitchen Lounge
- Double Glazing
- Ground Floor Apartment



**SETHS**

## 2 Bedroom Flat located in London

Seths are proud to market this 2 Apartment on Dacres Road in Lewisham, London

Upon entering the Property, there is a Hallway, which provides access to the Lounge, Kitchen, 2 Good sized Room (1 with an Ensuite) and Main Bathroom

There is also a Fitted Kitchen inclusive of Wall and Base Units with Worktops Over, Sink, Integrated Cooker.

The property benefits from Double Glazing and Completed with Stunning Views.

Rent: £1850PCM

Security Deposit: £2130.00

Tenancy Length: 6 or 12 Months

Council Tax Band: D







- Stunning Apartment
- 2 Bedrooms
- 2 Bathrooms
- Open Plan Kitchen Lounge
- Immediate Move In Available
- Double Glazing
- Modern
- Ground Floor Apartment
- Close To Transport Links
- Close To Local Amenities



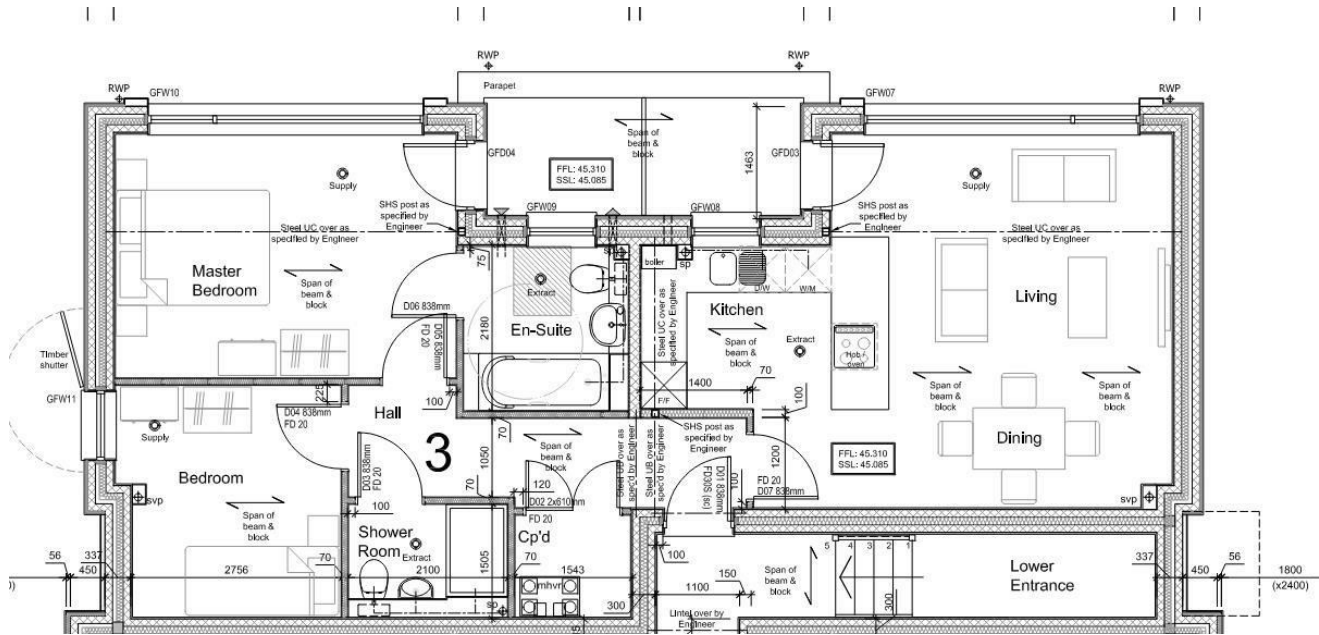

Call us on  
0116 266 9977

let@seths.co.uk  
www.seths.co.uk

Council Tax Band D

### Energy Efficiency Rating

	Current	Potential
<i>Very energy efficient - lower running costs</i>		
(92 plus) <b>A</b>		
(81-91) <b>B</b>	<b>82</b>	<b>82</b>
(69-80) <b>C</b>		
(55-68) <b>D</b>		
(39-54) <b>E</b>		
(21-38) <b>F</b>		
(1-20) <b>G</b>		
<i>Not energy efficient - higher running costs</i>		
<b>England &amp; Wales</b>	EU Directive 2002/91/EC 	



Agents Note: Whilst every care has been taken to prepare these particulars, they are for guidance purposes only. All measurements are approximate and are for general guidance purposes only and whilst every care has been taken to ensure their accuracy, they should not be relied upon and potential buyers are advised to recheck the measurements.

