



Rickmansworth Road

WATFORD, WD18 7JD

£700,000

Introducing a charming four-bedroom detached bungalow nestled along the prestigious Rickmansworth Road in Watford, offering the epitome of comfortable family living within walking distance to the renowned grammar schools. Boasting a desirable location, this property presents an ideal blend of convenience and tranquillity.

Upon entering, you are welcomed by a spacious entrance hall that sets the tone for the rest of the home. The ground floor features a convenient downstairs shower and guest WC, ensuring practicality for both residents and visitors alike.

Externally, this home comes with a garage and private driveway, ensuring ample parking for multiple vehicles. The front and back gardens are mature, providing a peaceful oasis to enjoy outdoor living. With access on all sides, the gardens offer versatility and ease of maintenance.

In summary, this property presents an exceptional opportunity to secure a family home in a highly sought-after location. Don't miss your chance to make this your forever home.

- Four bedroom
- Detached bungalow
- Three toilets & three showers
- Garage and private driveway
- Large entrance hall
- Very close to Watford grammar schools
- Front and rear gardens with side access
- Available now for viewings

Viewing

Please contact our Watford Office on 01923224030 if you wish to arrange a viewing appointment for this property or require further information.



4



2



2



E

Floor Plan

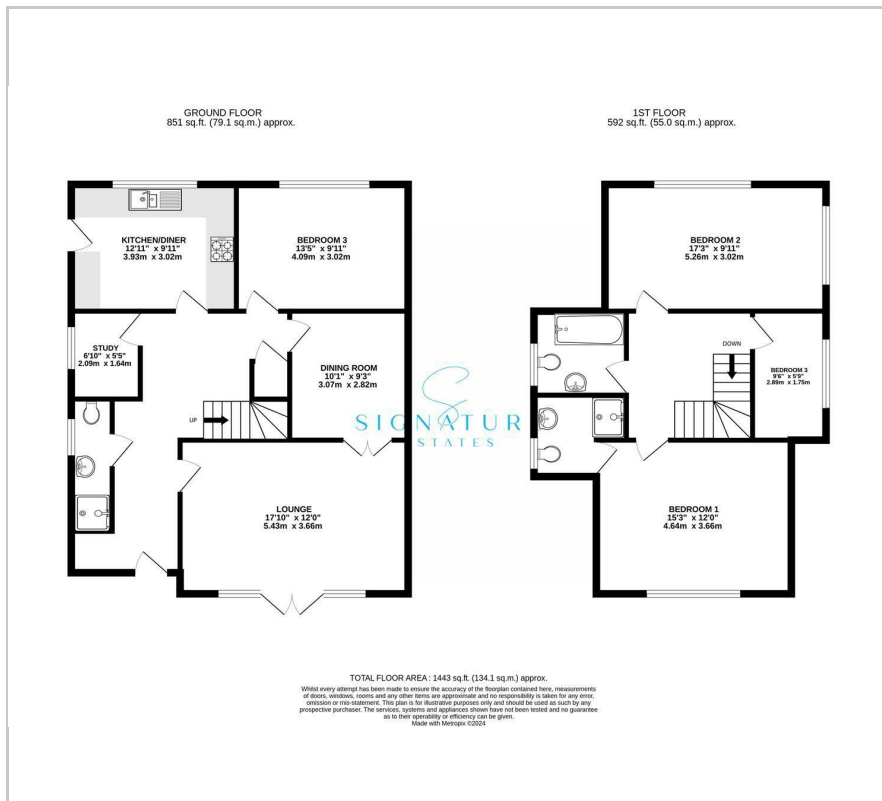

Area Map



Energy Efficiency Graph

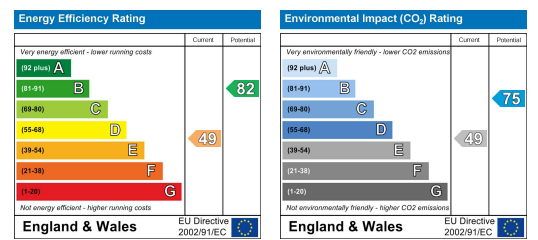

These particulars, whilst believed to be accurate are set out as a general outline only for guidance and do not constitute any part of an offer or contract. Intending purchasers should not rely on them as statements of representation of fact, but must satisfy themselves by inspection or otherwise as to their accuracy. No person in this firm's employment has the authority to make or give any representation or warranty in respect of the property.