

# Crucible Homes



Charles Street  
Rotherham, S63 9LX

£575



## Overview

AVAILABLE NOW!

Two Bedrooms

Spacious Kitchen

Enclosed Rear Patio Area

Close To Local Amenities

Good Transport Links



## Description

OVERVIEW New to the rental market is this two bedroom, mid-terraced home in Goldthorpe, Rotherham. Downstairs there is a living room and a spacious kitchen with built in cupboards, as well as a fridge-freezer, oven and washing machine. There is also a door that leads out on to the rear patio area. Upstairs there is a double bedroom with a storage cupboard, a second smaller bedroom and a family bathroom. The property benefits from being in great condition throughout, being close to local amenities and good transport links.



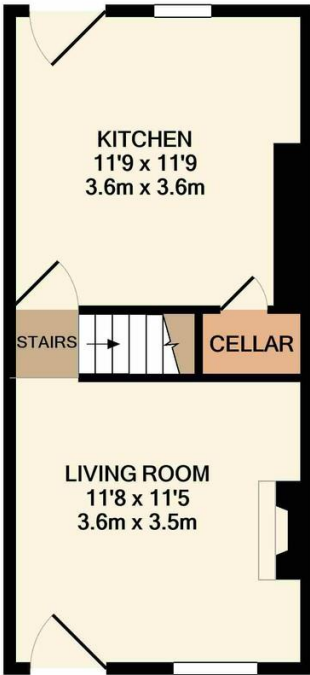

GROUND FLOOR  
APPROX. FLOOR  
AREA 292 SQ.FT.  
(27.1 SQ.M.)

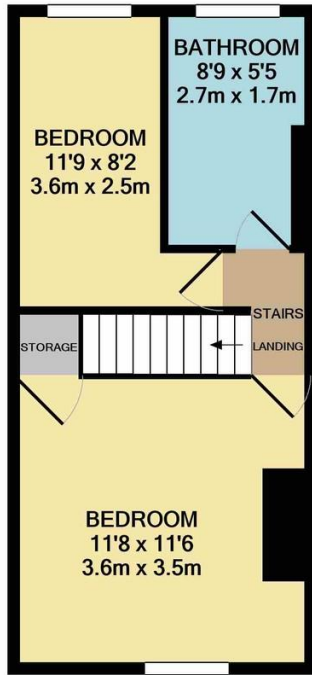

1ST FLOOR  
APPROX. FLOOR  
AREA 288 SQ.FT.  
(26.8 SQ.M.)

TOTAL APPROX. FLOOR AREA 580 SQ.FT. (53.9 SQ.M.)

Whilst every attempt has been made to ensure the accuracy of the floor plan contained here, measurements of doors, windows, rooms and any other items are approximate and no responsibility is taken for any error, omission, or mis-statement. This plan is for illustrative purposes only and should be used as such by any prospective purchaser. The services, systems and appliances shown have not been tested and no guarantee as to their operability or efficiency can be given  
Made with Metropix ©2021

Score	Energy rating	Current	Potential
92+	A		
81-91	B		68   B
69-80	C		
55-68	D	67   D	
39-54	E		
21-38	F		
1-20	G		

