

Crucible Homes



Strauss Crescent
Rotherham, S66 7QJ

£625PCM

Overview

Available now!

Two Bedrooms

Semi-Detached

Patio to the Rear

Off-Road Parking

Spacious Living Room

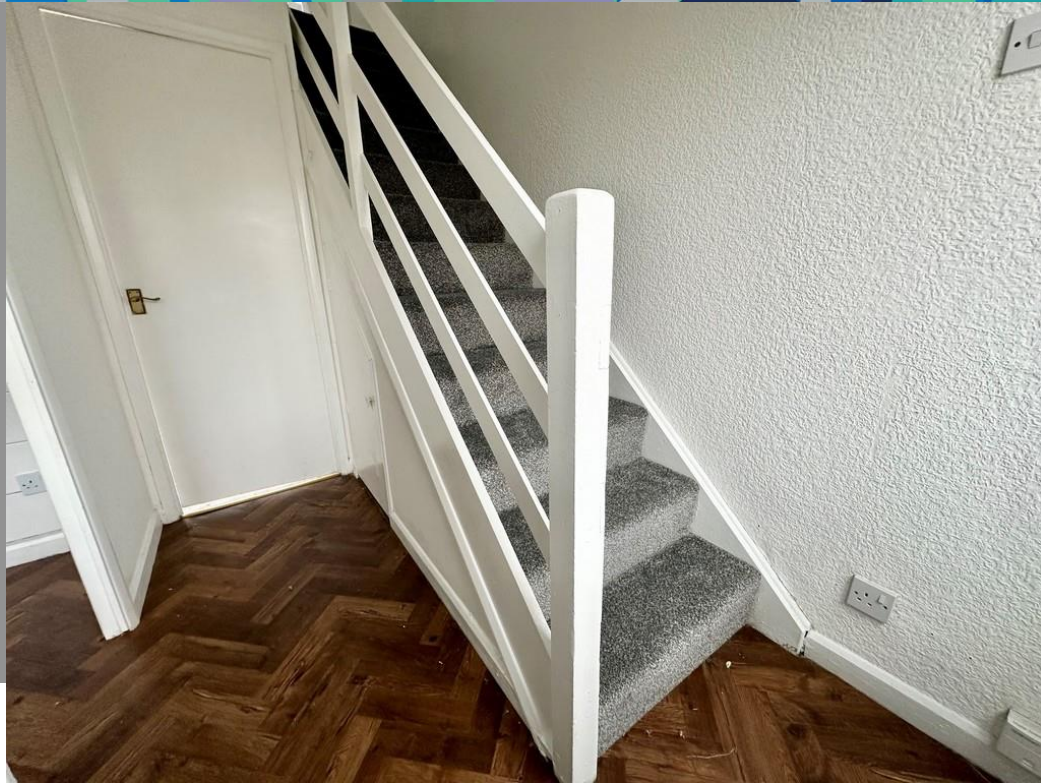

Description

OVERVIEW Crucible Homes present to the rental market this two bedroom semi-detached home located in Maltby. Downstairs there is a kitchen and a spacious living room, with a sliding door that leads out on to the rear patio area. Upstairs there is a double bedroom, a second bedroom and a shower room. This fantastic home also benefits from a driveway that provides enough space for two vehicles, a small front garden, and being close to local amenities and excellent transport links.

Rent - £625 PCM

Deposit - £721

Length of tenancy - 6 months (other options available)

Council tax Band - A



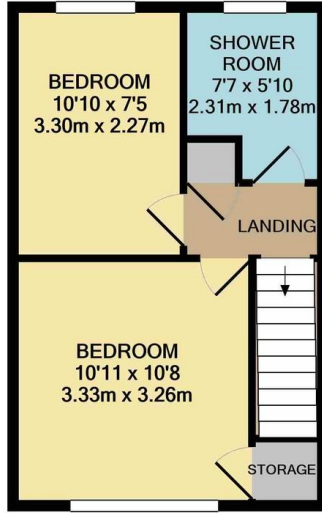
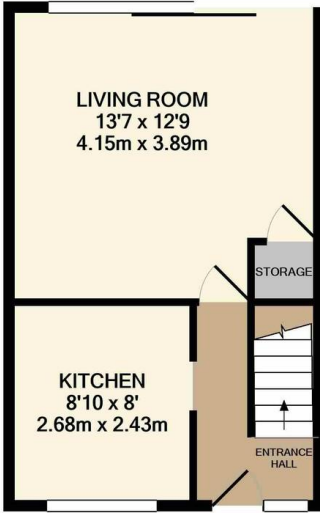

GROUND FLOOR
APPROX. FLOOR
AREA 287 SQ.FT.
(26.6 SQ.M.)

1ST FLOOR
APPROX. FLOOR
AREA 287 SQ.FT.
(26.6 SQ.M.)

TOTAL APPROX. FLOOR AREA 573 SQ.FT. (53.3 SQ.M.)

Whilst every attempt has been made to ensure the accuracy of the floor plan contained here, measurements of doors, windows, rooms and any other items are approximate and no responsibility is taken for any error, omission, or mis-statement. This plan is for illustrative purposes only and should be used as such by any prospective purchaser. The services, systems and appliances shown have not been tested and no guarantee as to their operability or efficiency can be given

Made with Metropix ©2022

Score	Energy rating	Current	Potential
92+	A		
81-91	B		83 B
69-80	C		
55-68	D	65 D	
39-54	E		
21-38	F		
1-20	G		

