

Crucible Homes



Brookhaven Way
Bramley, S66 1WH

£145,000

Overview

Ground Floor Apartment

Two Double Bedrooms

Fitted Robes

Lounge/Diner

EPC Rating - Pending

Council Tax Band - B



Description

SUMMARY Crucible Homes are pleased to be selling this GROUND floor apartment located on the popular estate within Bramley.

This property is ideal for anyone that will be living alone, as the apartment has security entry phone system, giving that extra peace of mind.

The main living area to this apartment is really bright and airy, with the main front window allowing an ample of natural light through.

On approach to the building you enter through the secure entrance door to the communal area, leading to the ground floor apartment.

When entering the apartment you walk into the hallway, giving access to all available rooms.

Lounge area has a front facing UPVC window with an access door into the spacious modern kitchen, which has built in appliances including oven, hob with extractor above.



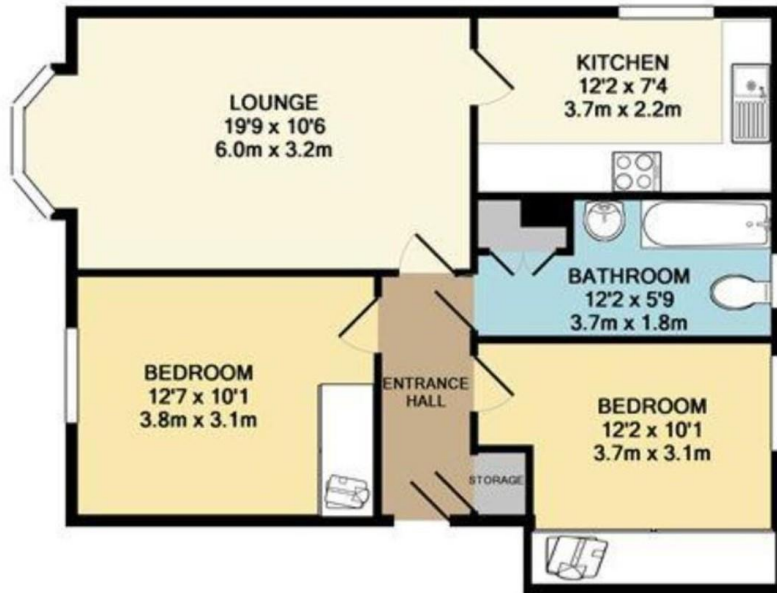

From the hallway you enter into the master bedroom which is to the front of the apartment, benefiting from having freestanding wardrobes. Through to the second bedroom this is to the back of the property, also having benefiting from having built in robes.

Bathroom is fully tiled and fitted with a three piece suit comprising of bath with shower over, wash hand basin and low flush WC. This room benefits from having a double storage cupboard, providing space for certain appliances and personal belongings.

Externally there is allocated parking along with spaces for visitors.

The position of this apartment is ideal for anyone who commutes, as the motorway network is a short drive away, along with being close to amenities which include; shops, schools, major supermarket and doctors surgery.

AGENCY NOTE

EPC Rating - Pending

Council Tax Band - B

