

Crucible

Homes



Pembroke Street
Rotherham, S61 2LY

Guide Price
£90,000

Overview

No Onward Chain

Fantastic INVESTMENT OPPORTUNITY

Freehold

Council Tax Band A

Reputable schools nearby

Close to a range of amenities



Description

***** Investors Dream *****

We are excited to present this TWO bedroom terrace home sold with NO ONWARD CHAIN!!!! Situated in a popular residential area, close to amenities and transport links.

This spacious property is ideal for a first time buyer or investors. The accommodation briefly comprises of lounge, Dining room, kitchen, cellar, two bedrooms, bathroom and a low maintenance garden.

For more information call our Property Experts on 01709 500333.

LOUNGE 12' 0" x 12' 5" (3.681m x 3.788m)

DINING ROOM 12' 4" x 12' 11" (3.776m x 3.944m)

KITCHEN 7' 2" x 7' 8" (2.202m x 2.36m)

MASTER BEDROOM 12' 0" x 11' 11" (3.658m x 3.648m)

BEDROOM 2 12' 11" x 6' 11" (3.938m x 2.129m)

BATHROOM 6' 11" x 9' 11" (2.131m x 3.024m)



GROUND FLOOR

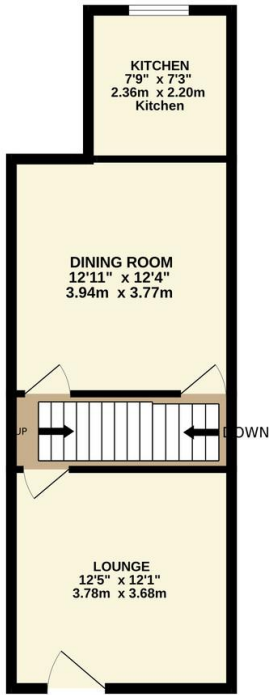

1ST FLOOR

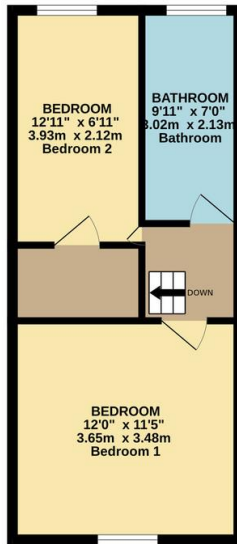

Whilst every attempt has been made to ensure the accuracy of the floorplan contained here, measurements of doors, windows, rooms and any other items are approximate and no responsibility is taken for any error, omission or mis-statement. This plan is for illustrative purposes only and should be used as such by any prospective purchaser. The services, systems and appliances shown have not been tested and no guarantee as to their operability or efficiency can be given.
Made with Metropix (2022)

Score	Energy rating	Current	Potential
92+	A		
81-91	B		89 B
69-80	C		
55-68	D		
39-54	E		
21-38	F	22 F	
1-20	G		



Find us on Facebook **Crucible Sales & Lettings** Follow us on Twitter **@cruciblesalelet** Find us on Instagram **cruciblesalelet**

