

Highmead, Mill Lane, Exton, Exeter, EX3 0PH



A spacious and well-presented detached house with stunning views over the Exe Estuary and beyond to Dartmoor. The property provides a sense of rural seclusion while simultaneously enjoying the benefits of being a short walk from regular bus and train services to Exeter and Exmouth. Surrounded by open countryside, this property is a gentle stroll from the village pub and the popular Exe Estuary Trail. Ideal for multi generational living this four bedroom property has been finished to an excellent standard. The accommodation benefits from a large entrance hallway, open plan kitchen dining room with two sets of bifold doors opening onto the rear deck and lawn, separate lounge, utility room, cloakroom, three double bedrooms, spacious landing which is currently used as a home office, en-suite dressing room and two further en-suite bathrooms. Separate self contained annexe with a lounge, kitchen/dining room, bedroom and en-suite bathroom, currently configured as a Furnished Holiday Let (Air B&B). The property has the benefit of a double garage and parking for 5/6 cars. Situated in a quiet lane in the sought after village of Exton, the property makes an ideal family home.

Offers in the Region of £950,000 Freehold DCX02124

Highmead, Mill Lane, Exton, Exeter, EX3 0PH

Exton is a pleasant village on the Exe estuary between Topsham and Lympstone with easy access to Exeter (6 m) and a useful rail link to the city centre and Exmouth, 4 miles. Mill Lane is a quiet and narrow country road with about 10 dwellings, accessible from the A376 at each end.



THE ACCOMMODATION COMPRISES:

Entrance Hall

Accessed via composite front door with part frosted uPVC double glazed front aspect window. Spotlight. Wood laminate flooring. Radiator. Solid wood door through to

Inner Hallway 12' 8" x 13' 1" (3.87m x 3.98m)

With doors to lounge, bedroom three, cloakroom. Large storage cupboard. Turning staircase to first floor landing. Opening through to the kitchen/diner. Radiator.

Kitchen/Diner 31' 7" x 20' 4" (9.63m x 6.19m)

Side aspect uPVC double glazed window and twin uPVC bi-fold doors with stunning views over the Exe Estuary leading through to the decked area and rear garden. Doors to the utility room and garage. Beautifully fitted range of eye and base level units with inserted sink with mixer tap. Granite work surfaces. Gas cooker point. Further appliance space. Integrated dishwasher. Integrated microwave oven. Spotlights. Breakfast bar. Seating area. TV point. Underfloor heating.



Utility room 12' 11" x 5' 9" (3.94m x 1.76m)

Fitted range of base level units with roll edge work surfaces. One and a half bowl stainless steel sink with mixer tap and drainer. Plumbing for washing machine. Further appliance space. Full height storage cupboard with wall mounted boiler and hot water tank. Tiled flooring.

Lounge 19' 3" x 11' 5" (5.87m x 3.49m)

Rear aspect uPVC double glazed window with stunning views of the Exe Estuary, rear garden and open countryside. French doors opening out onto the decking. Solid wood flooring. Television point. Radiator.



Master Bedroom en-suite 10' 4" x 9' 5" (3.15m x 2.88m)

Side aspect Velux window with views over open countryside. Four piece white suite comprising Jack and Jill basins with mixer taps and large under sink storage draws. Large walk in shower cubicle with rainwater shower. Jacuzzi bath with mixer tap. Low level WC. Spotlights. Storage cupboard. Tiled flooring.

Master Bedroom 14' 10" x 17' 3" (4.53m x 5.27m)

Rear aspect uPVC double glazed French doors leading out onto the decked balcony with stunning views over the Exe Estuary and the surrounding countryside. Television point. Telephone point and into eaves storage.

Bedroom Three 8' 7" x 7' 7" (2.61m x 2.32m)

Front aspect uPVC double glazed window. Television point. Spotlights. Radiator. Door through to



En-suite bathroom

Front aspect frosted uPVC double glazed window. P shaped bath with mixer tap and rainwater shower above. Low level WC. Pedestal wash hand basin with mixer tap. Tiled flooring. Spotlights. Extractor fan. Radiator.

First Floor Landing 12' 4" x 16' 8" (3.77m x 5.09m)

Rear aspect uPVC double glazed window and doors, leading to the master bedroom and bedroom two. Currently configured as a home office with built in office furniture and uninterrupted views over the Exe Estuary when sitting at the desk.

Master Bedroom Dressing Area 16' 3" x 17' 1" (4.96m x 5.21m)

Rear aspect uPVC double glazed French doors leading out to the decked balcony with elevated views over the Exe Estuary and the surrounding countryside. Solid wood flooring. Three built in double wardrobes with hanging space, shelving and extra-deep storage. Matching draws and cupboards with oak pillars providing open access to the master en-suite. Door to master bedroom.



Bedroom Two Dressing Room 6' 8" x 4' 0" (2.04m x 1.21m)

Side aspect uPVC double glazed window. Full height storage cupboards with hanging space and shelving.

En-suite Bathroom

Front aspect frosted uPVC double glazed window. Four piece white suite comprising fully enclosed shower cubicle, low level WC, pedestal wash hand basin, jacuzzi bath with mixer tap and hand held shower. Part tiled walls. Shaver point. Extractor fan. Tiled flooring. Heated towel rail. Spotlights.

Cloakroom

Front aspect frosted uPVC double glazed window. Low level WC. Wash hand basin with mixer tap and storage below. Spotlights. Wood effect laminate flooring. Radiator.

Garage 21' 7" x 19' 7" (6.59m x 5.97m)

Twin up and over doors. Over head storage above. Water tap, Light and power.

Separate Annexe

The annex is totally self-contained. It is accessed via its own garden gate, through its own private part of the garden and through its own front door. The Annex offers three main options to prospective buyers; as a lucrative and easily run holiday let business, as a 'Granny Annex' or as part of the main property. It has been designed so that it can be easily and cheaply reconfigured to provide three further large living spaces in the main property.

Hallway

Doors to the lounge, kitchen/diner and bedroom and large storage cupboard. Radiator.

Lounge 11' 9" x 11' 11" (3.59m x 3.64m)

Rear aspect uPVC double glazed window with stunning views over the Exe Estuary and open countryside. Wood effect laminate flooring. TV point. Radiator.



Open plan Kitchen/Diner 13' 11" x 12' 6" (4.23m x 3.80m)

Main entrance via a rear aspect uPVC double glazed French doors open onto the decked area with stunning views over the estuary and open countryside. Fitted range of eye and base level units with roll edge work surfaces. Sink with mixer tap and single drainer. Integrated oven and hob with extractor fan above. Plumbing for washing machine. Wood effect laminate flooring. Seating area. Television point. Radiator.



Bedroom 11' 8" x 9' 11" (3.56m x 3.03m)

Front aspect uPVC double glazed window. Television point. Wood effect laminate flooring. Radiator. Door to



Ensuite Bathroom

Three piece suite comprising P shaped bath with mixer tap and hand held shower above. Low level WC. Pedestal wash hand basin with mixer tap. Part tiled walls. Spotlights. Extractor fan. Heated towel rail. Front aspect frosted window.

Rear Gardens

South facing rear garden mainly laid to lawn with large decked area and stunning views out over the estuary and countryside beyond. Storage space to the side. Access to the front of the property.

Front Driveway and Gardens

Shingle driveway with off road parking for approximately eight vehicles and further hard standing. Vehicular access to the double garage. Pedestrian access to the front door.



GROUND FLOOR
2126 sq.ft. (197.5 sq.m.) approx.

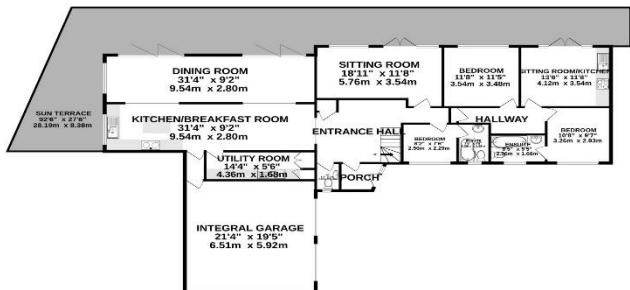

1ST FLOOR
1165 sq.ft. (108.2 sq.m.) approx.

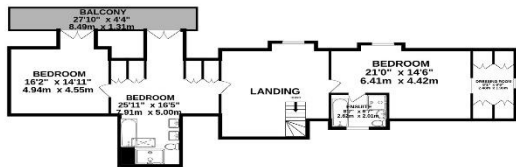

TOTAL FLOOR AREA : 3291 sq.ft. (305.7 sq.m.) approx.

Whilst every attempt has been made to ensure the accuracy of the floorplan contained here, measurements of doors, windows, rooms and any other items are approximate and no responsibility is taken for any error, omission or mis-statement. This plan is for illustrative purposes only and should be used as such by any prospective purchaser. The services, systems and appliances shown have not been tested and no guarantee as to their operability or efficiency can be given.

Made with Metropix ©2024

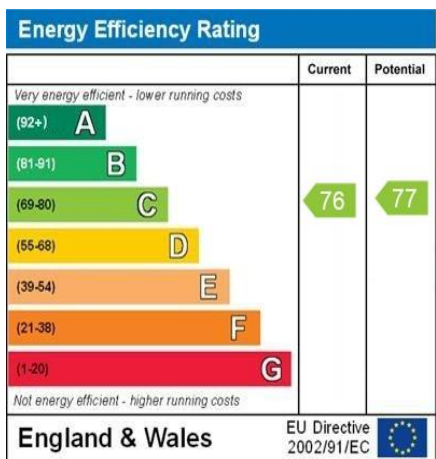

WWW.EPC4U.COM