



Mr D Ginger – 5*
Would thoroughly recommend! Chad and the team have kept us well informed all the way through the process, even during the difficult lockdown period and have made all parts of the journey as stress free as possible.

Mr M Muggeridge – 5*
I was extremely happy with the service I received from the beginning; with Louis and Chad who looked after the negotiation and sale of the property, right through to the completion of the sale with Nicola. Nicola was incredibly efficient with all the paperwork which needed completing and continued to keep me updated and in the loop throughout the process. She was helpful and offered exceptional customer service. I would not hesitate to recommend this

Mr D Tomlinson – 5*
The staff at SJ Smith were great and made the moving process go as smoothly as possible. A big thank you.

Mr K Ziolkowski – 5*
Hello everyone. I just sold my property with S.J. Smith and I'm really happy with my decision. They are very professional. Special thanks to Mr Robert who has done professional valuation of the property, professional photos and professional advice. Special thanks for Mr Chad who has been with me through whole process of selling. He always been available (even when days off), very active in communication with other involved parties. I can honestly recommend SJ Smith as a really professional team.

Mr J O'Shea – 5*
Very good professional service. Very responsive and pro-active in getting the purchase completed. Would recommend their services.

Mrs W Teverson – 5*
We originally signed up with Purple Bricks (purely cost saving) but Chad tempted us to give SJ Smith an opportunity – and I admit it is a different service to that of an online agency, you get what you pay for and they provided a professional service all the way through, we were delighted and would highly recommend this local agency to anyone buying or selling in the area.

Mr S Dymo – 5*
Chad at Smiths was very very good. Great communication. Very helpful, would like to thank Chad and Nicola for all their help. Done a great job. Would definitely recommend Smiths.

Mr J – 5*
There is a reason why you see so many SJ Smith sale boards around Sunbury, Ashford and Staines compared to the other companies! As first time buyers we had no idea what to expect but from start to finish the service we received from them was exceptional. Louis showed us around the property and was very professional. No hard sale and let us take our time also very knowledgeable answering my questions about the property and surrounding area. He and Chad helped secure the sale through negotiating and agreeing a price. Nicola was an absolute god send during the process and helped keep us sane throughout. Quick to respond to our queries and persistent with keeping things moving. We are now settled in our new home and forever grateful to SJ Smith for their efforts in making it happen!

Mrs A J Tyler – 5*
Great service from start to finish. Lovely friendly service from Louis and Rob and exceptional after sales service from Nicola. Highly recommended.



6 Station Approach
Ashford
Middlesex
TW15 2QN

t: 01784 243333
e: ashford@sjsmithestateagents.co.uk
www.sjsmithestateagents.co.uk



8 Wellington Court, Ashford, Surrey , TW15 3RR Guide Price £315,000 - Leasehold

Presented in excellent condition throughout, this generously proportioned two double bedroom first-floor maisonette is offered to the market with no onward chain and is conveniently located just 0.5 miles from Ashford mainline station and the amenities of the High Street. The property benefits from a 965-year lease, no service charges, an allocated parking space positioned directly outside the front door, and use of a well-maintained communal front garden. The accommodation comprises a private front entrance with stairs rising to a bright and airy triple-aspect living room, offering ample space for both lounge and dining furniture and further enhanced by a wall-mounted TV unit. Leading from the living room is a separate modern fitted kitchen, equipped with a gas hob and space for the usual appliances. A hallway then provides access to the remainder of the accommodation, including a stylishly refitted bathroom suite, an airing/storage cupboard, and loft access. The principal bedroom is a well-proportioned double and benefits from fitted wardrobes, while the second bedroom is also a comfortable double, making the layout ideal for sharers, first-time buyers, or investors.

Approximate Gross Internal Area
62.25 sq m / 670 sq ft

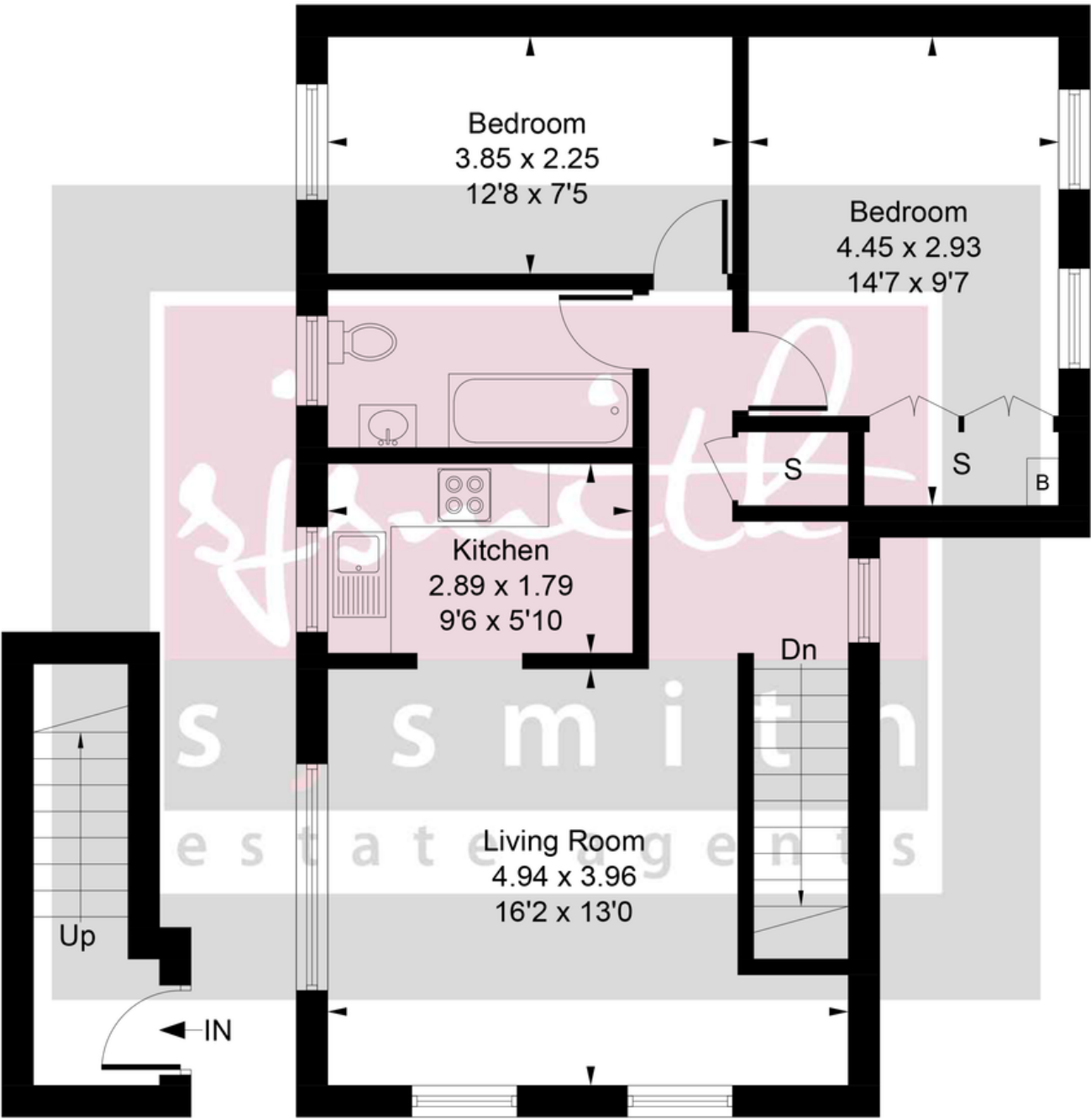
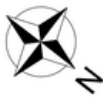

Ground Floor **First Floor**

Whilst every attempt has been made to ensure the accuracy of the floor plan contained here, measurements of doors, windows, rooms and any other items are approximate and no responsibility is taken for any error, omission, or mis-statement. This plan is for illustrative purposes only and should be used as such by any prospective purchaser.

- NO ONWARD CHAIN
- 965 YEAR LEASE
- ALLOCATED PARKING
- CLOSE TO LOCAL AMENITIES
- USE OF A FRONT GARDEN
- EXCELLENT CONDITION
- 0.5 MILES TO ASHFORD STATION
- EPC RATING BAND C



Council Tax

Spelthorne Borough Council, Tax Band C being £2,144.69 for 2025/26 Council tax bands can be reassessed by local authorities at any point, the council tax band is only taken at point of listing and should not be relied on as current banding

Lease and service charge information, all to be confirmed via solicitors;

Tenure: Leasehold 965 years remaining on the lease

Service Charge: £0

Ground rent:

Agent note Under Consumer Protection Regulations we have endeavoured to make these details as reliable and as accurate as possible. The accuracy is not guaranteed and does not form part of any contract as the details are prepared as a general guide. We have not carried out a detailed survey or tested any appliances, specific fittings, or services (gas/electric). Room sizes should not be relied upon for carpets or furnishing nor should internal photos as these are intended as a guide only and may have changed since. It should not be assumed that any furniture/fittings are included. Lease, ground rent, maintenance or any other charges have been provided by the vendor and their accuracy cannot be guaranteed. We always advise a buyer should obtain verification on points via a solicitor.