



Pond Cottage
Ashley, Cambridgeshire

DAVID
BURR



Pond Cottage, 1 Chapel Row, Ashley, Cambridgeshire, CB8 9ED

Ashley is one of Cambridgeshire's most picturesque villages with local amenities including a restaurant, public house, village shop and a church, this village is also in the catchment area for one of East Cambridgeshire's most popular schools in Bottisham. The nearby horseracing town of Newmarket (3.5 miles) offers a range of amenities such as schools, shops, supermarkets, restaurants and leisure facilities. The market town of Bury St Edmunds (12 miles) and Cambridge (13 miles) offer a wider range of amenities.

An idyllically positioned three-bedroom cottage measuring close to 1,800 sq. ft of accommodation in the vastly popular Cambridgeshire village of Ashley. The property boasts an unrivalled position in the village immediately overlooking the well-known and adored Ashley pond. The accommodation consists of a new kitchen/dining room, sitting room, conservatory, three bedrooms and two bathrooms. Externally enjoying ample driveway parking, a single garage and a beautifully presented rear garden complete with summer house and tool shed.

A well-presented and perfectly positioned three-bedroom house in Ashley.

Ground Floor

CONSERVATORY An enjoyable space with windows to side and rear aspects, tiled floor and a door leading to the rear garden terrace.

INNER HALL Fitted storage and stairs rising to the first floor.

KITCHEN / DINING ROOM A newly fitted kitchen with matching base and wall units with worktops over and an inset double sink and drainer. Integrated appliances include a dishwasher, washing machine, electric oven, 4-ring hob with extractor above and further space for freestanding appliances. Tiled floor, windows to front aspect and ample dining space. Complete with Watchman oil level monitor.

SITTING ROOM A wonderful triple aspect room with windows to front and rear aspects, French doors leading to the rear garden terrace and an open fireplace.

BEDROOM 2 Window to front aspect and an **ENSUITE** which is extensively tiled with a wet-room styled shower, wash hand basin, WC and heated towel rail.

First Floor

LANDING Velux window to front aspect and fitted storage and airing cupboard.

BEDROOM 1 A large fitted **WALK-IN WARDROBE** and windows to front aspect.

BEDROOM 3 Fitted wardrobes and a window to rear aspect.

BATHROOM Fitted with a bath and shower over, wash hand basin, heated towel rail, WC and window to front aspect.

Outside

The property enjoys driveway parking for three vehicles that in turn leads to the **SINGLE GARAGE**. There is a pathway leading from the garage to the garden of the property that is predominately lawned with an incredible selection of established trees, shrubs and plants throughout, with a further two paved terraces, tool shed and **SUMMER HOUSE**.

Pond Cottage, 1 Chapel Row, Ashley, Cambridgeshire, CB8 9ED

Material Information

SERVICES Oil fired central heating. Mains water, drainage and electricity.
Note, none of these services have been tested by the agent.

LOCAL AUTHORITY East Cambridgeshire District Council.

COUNCIL TAX BAND D.

TENURE Freehold.

WHAT3WORDS neck.centrally.fades

EPC D.

COMMUNICATION SERVICES: (Broadband): Yes Speed up to 80 Mbps download, up to 20 Mbps upload.. **Phone signal:** Likely with all major providers.

VIEWING by prior appointment through David Burr estate agents.

NOTICE Whilst every effort has been made to ensure the accuracy of these sales details, they are for guidance purposes only and prospective purchasers or lessees are advised to seek their own professional advice as well as to satisfy themselves by inspection or otherwise as to their correctness. No representation or warranty whatsoever is made in relation to this property by David Burr or its employees nor do such sales details form part of any offer or contract.



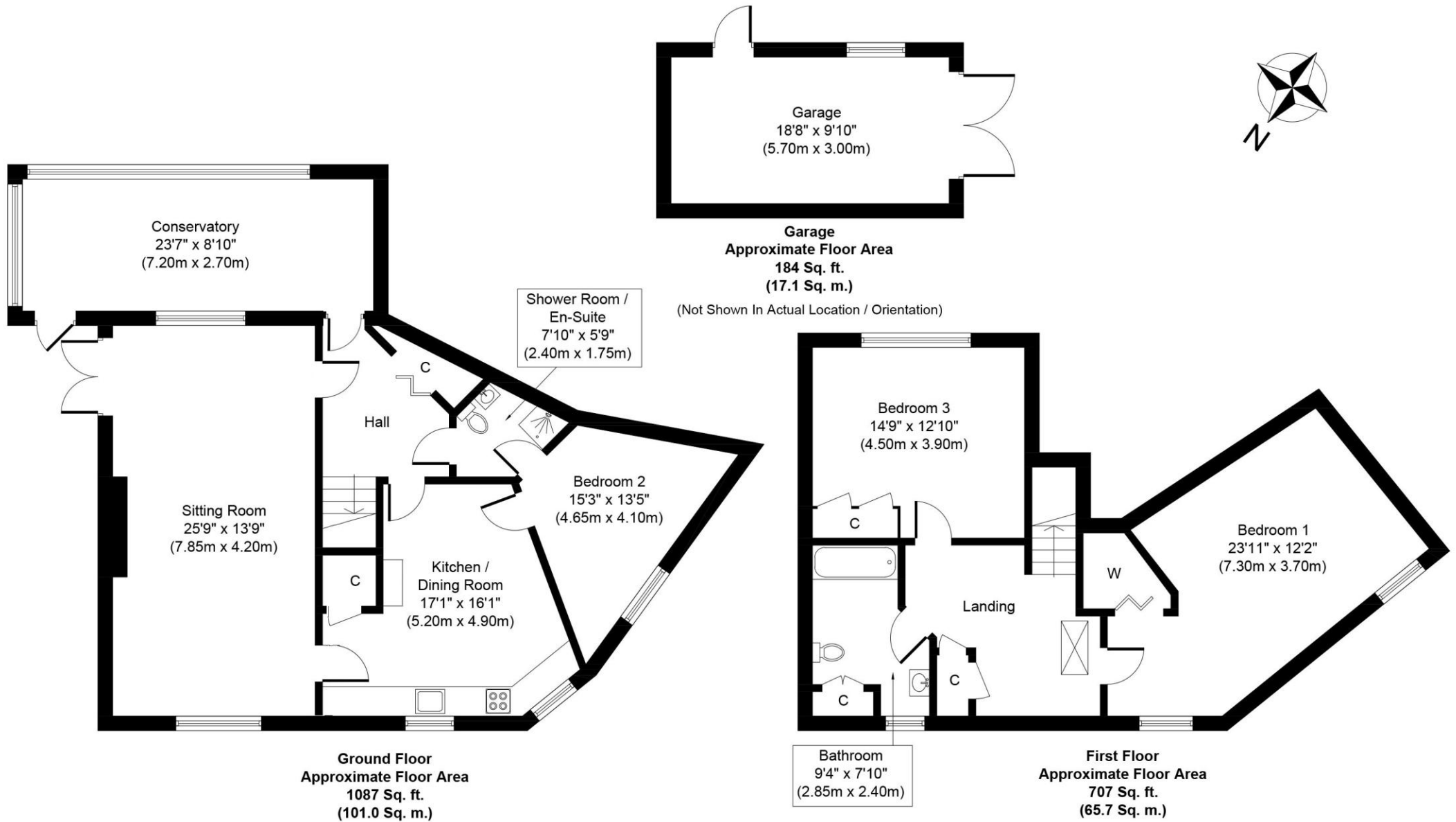

Whilst every attempt has been made to ensure the accuracy of the floor plan contained here, measurements of doors, windows, rooms and any other items are approximate and no responsibility is taken for any error, omission, or mis-statement. The measurements should not be relied upon for valuation, transaction and/or funding purposes. This plan is for illustrative purposes only and should be used as such by any prospective purchaser or tenant. The services, systems and appliances shown have not been tested and no guarantee as to their operability or efficiency can be given.

