

**FOR SALE**



**Meadow Court Road, Earl Shilton**  
**£280,000**

  
**MARTIN & CO**



## Meadow Court Road, Earl Shilton

3 Bedrooms, 1 Bathroom

**£280,000**

- NO CHAIN AND VIEWING ADVISED!
- RECENTLY REFURBISHED
- GOOD SIZED FRONT LOUNGE
- REAR MODERN KITCHEN/DINER WITH APPLIANCES

NO CHAIN! A THREE BEDROOM DETACHED HOUSE IN EARL SHILTON. Comprising entrance hallway, lounge, rear kitchen/diner, first floor landing with three bedrooms and family bathroom. Double glazed and gas central heating. Garage and front drive and rear garden. VIEWING ADVISED!

PORCH 3' 10" x 6' 1" (1.19m x 1.86m) Front entrance porch leading to the lounge.

LOUNGE 16' 11" x 11' 11" (5.17m x 3.64m) Decorated in a neutral colour, this room over looks the front of the house and driveway. Decorated in a neutral colour with a carpeted floor. Stairs to the first floor and secondary heating.

KITCHEN/DINER 16' 11" x 12' 3" (5.17m x 3.74m) Modern kitchen/diner with white fronted kitchen units and wooden work surfaces. There's room for a dining table adjacent to the patio door. Side door to the rear of the garage. New appliances are included with the sale and boiler also brand new.

FIRST FLOOR LANDING Carpeted landing providing access to all bedrooms and bathroom. Storage cupboard



**BATHROOM 9' 6" x 7' 3" (2.92m x 2.22m)** Modern white suite comprising WC, sink and bath with shower over

**REAR BEDROOM 11' 4" x 11' 11" (3.46m x 3.64m)** Overlooking the rear garden, this room is decorated in a neutral colour.

**FRONT BEDROOM 11' 4" x 12' 5" (3.46m x 3.80m)** Decorated in a neutral colour this double bedroom overlooks the front of the property.

**SINGLE BEDROOM 6' 9" x 8' 2" (2.07m x 2.50m)** Single bedroom having a carpeted floor and decorated in a neutral colour.

**GARAGE AND REAR GARDEN** Single brick built garage with front lawn and driveway. Good sized rear lawned garden and patio area.





Score	Energy rating	Current	Potential
92+	A		
81-91	B		84 B
69-80	C	69 C	
55-68	D		
39-54	E		
21-38	F		

## Martin & Co Hinckley

99-109 Castle Street • Hinckley • LE10 1DA  
T: 01455 636349 • E: hinckley@martinco.com

01455 636349  
<http://www.martinco.com>

MARTIN&CO

**Accuracy:** References to the Tenure of a Property are based on information supplied by the Seller. The Agent has not had sight of the title documents. A Buyer is advised to obtain verification from their Solicitor. Items shown in photographs including but not limited to carpets, fixtures and fittings are not included unless specifically mentioned within the sales particulars. They may however be available by separate negotiation. Buyers must check the availability of any property and make an appointment to view before embarking on any journey to see a property. No person in the employment of the agent has any authority to make any representation about the property, and accordingly any information given is entirely without responsibility on the part of the agents, sellers or licensors. Any property particulars are not an offer or contract, nor form part of one. **Sonic / Laser Tape:** Measurements taken using a sonic / laser tape measure may be subject to a small margin of error. **All Measurements:** All Measurements are Approximate. Services Not tested. The Agent has not tested any apparatus, equipment, fixtures and fittings or services and so cannot verify that they are in working order, or fit for the purpose. A Buyer is advised to obtain verification from their Solicitor or Surveyor.

GROUND FLOOR

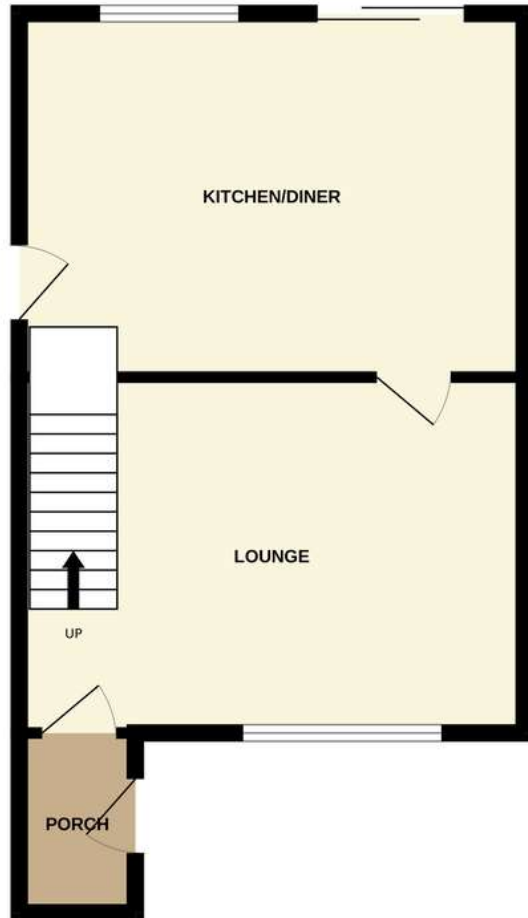

1ST FLOOR

