

St Albans Office
10 High Street, St Albans
Herts AL3 4EL
01727 228428
stalbans@cassidyandtate.co.uk

Marshalswick Office
59 The Quadrant, St Albans,
Herts AL4 9RD
01727 832383
marshalswick@cassidyandtate.co.uk

Wheathampstead Office
39 High Street, Wheathampstead,
Herts AL4 8BB
01582 831200
wheathampstead@cassidyandtate.co.uk

Cassidy
& Tate
Your Local Experts



Award Winning Agency



www.cassidyandtate.co.uk

HATFIELD ROAD
ST. ALBANS
AL4 0DU

£2,000 Per Month

EPC Rating: B Council Tax Band: New Build

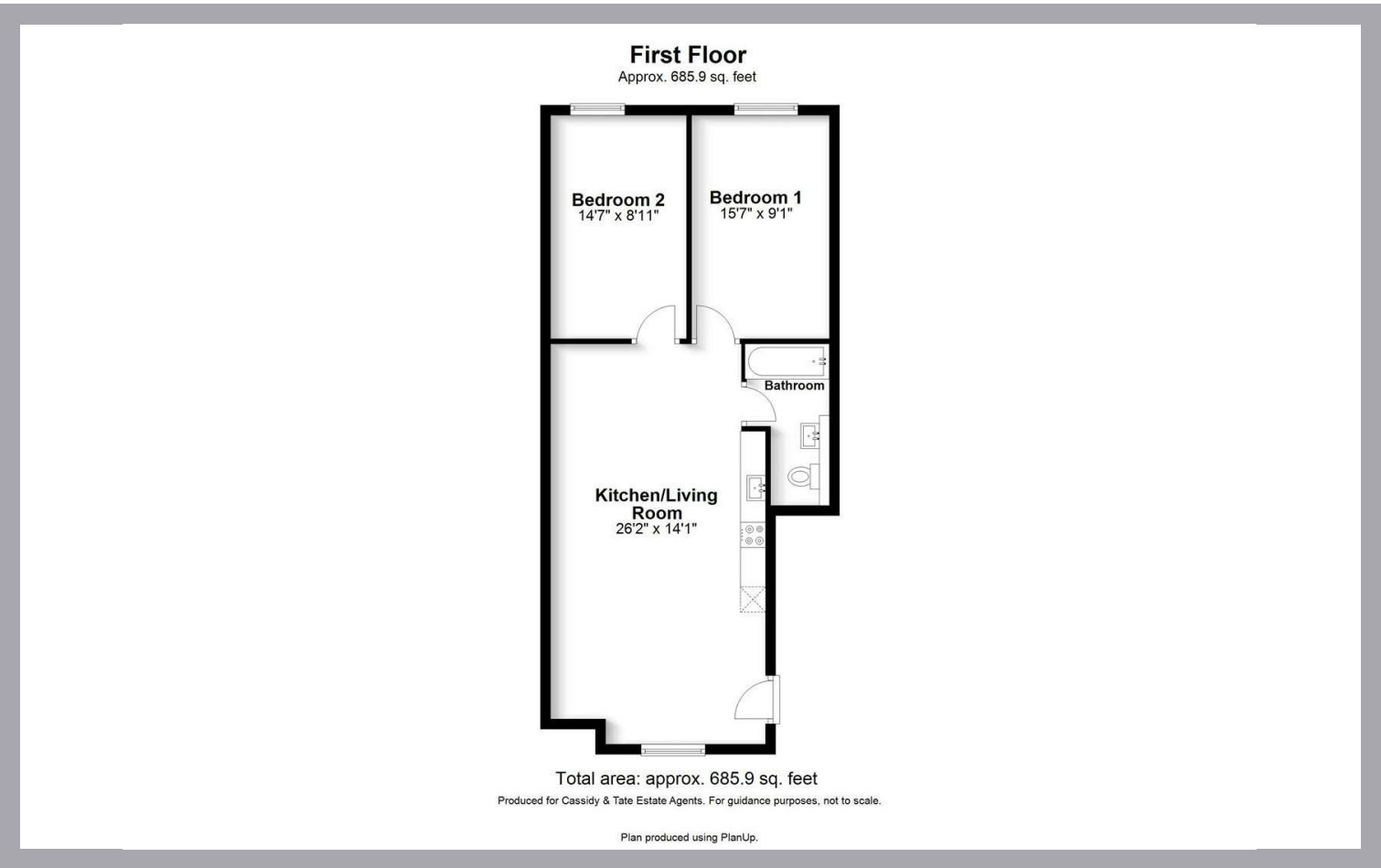

Cassidy & Tate have taken all reasonable steps to ensure the accuracy of the details supplied in our marketing material however, details are provided as a guide only and we advise prospective purchasers to confirm details upon inspection of the property. Cassidy & Tate will not be held liable for any costs which are incurred as a result of discrepancies.

All The Ingredients Needed For A Fabulous Lifestyle

A Brand New Development of 8 Luxury apartments. The apartment boast's an open living space, stunning fitted kitchen with integrated appliances, two bedrooms, and a stylish bathroom. This Top floor apartment has the further added bonus of an allocated parking space. Located on Hatfield rd, just a short walk from local amenities, and two amazing local schools - Oakwood JMI and Beaumont secondary school. St. Albans is renowned for its rich history and vibrant community, offering a plethora of amenities, including shops, restaurants, and parks, all within easy reach. The location also benefits from excellent transport links, making it an ideal base for commuters.



Specialists in Bespoke Properties

- Brand New Apartment
- Open Plan Living
- Stylish Bathroom
- One weeks holding fee based on the asking price £461.53
- Top Floor
- Two Bedrooms
- Private Allocated Parking
- Five weeks deposit based on the asking price £2307.69

| Energy Efficiency Rating | | |
|---|---------|-----------|
| | Current | Potential |
| Very energy efficient - lower running costs | | |
| (92 plus) A | | |
| (81-91) B | | |
| (69-80) C | | |
| (55-68) D | | |
| (39-54) E | | |
| (21-38) F | | |
| (1-20) G | | |
| Not energy efficient - higher running costs | | |
| England & Wales | | |
| EU Directive 2002/91/EC | | |

| Environmental Impact (CO ₂) Rating | | |
|---|---------|-----------|
| | Current | Potential |
| Very environmentally friendly - lower CO ₂ emissions | | |
| (92 plus) A | | |
| (81-91) B | | |
| (69-80) C | | |
| (55-68) D | | |
| (39-54) E | | |
| (21-38) F | | |
| (1-20) G | | |
| Not environmentally friendly - higher CO ₂ emissions | | |
| England & Wales | | |
| EU Directive 2002/91/EC | | |