

RODERICK THOMAS

ESTATE AGENTS & CHARTERED SURVEYORS









Insert Text





Insert Text



Daisy Cottage, Florida Street, Castle Cary, BA7 7AE

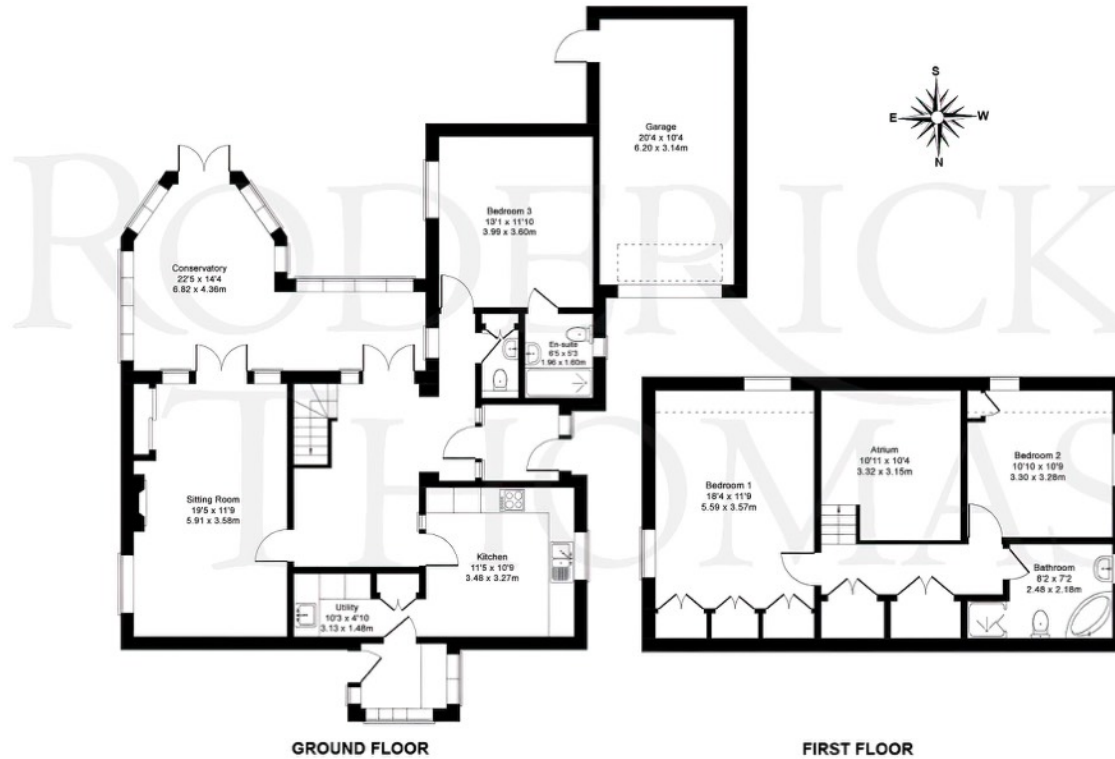

Gross Internal Area approximately:
 Ground Floor - 1367 sq ft - 127 sq m
 First Floor - 624 sq ft - 58 sq m
 Total - 1991 sq ft - 185 sq m

This plan produced for Roderick Thomas and is not to scale and is for illustrative purposes only. Whilst every attempt has been made to ensure the accuracy of the details and measurements depicted there is no guarantee as to their veracity and no responsibility is taken for error, omission or misrepresentation or any of the details shown. Where room dimensions are not square, the measurements depicted are of the maximum length or width of the room and this may be taken into account when estimating the total floor area of the building. With the exception of eaves storage, Approximate Gross Internal Area includes fitted / built in cupboards, hallways and staircases. The services, systems and appliances shown have not been tested and no guarantee as to their operability or efficiency can be given.

IMPORTANT NOTICE - Roderick Thomas, their clients and any joint agents state that these details are for general guidance only and accuracy cannot be guaranteed. They do not constitute any part of any contract. All measurements are approximate and floor plans are to give a general indication only and are not measured accurate drawings. No guarantees are given with regard to planning permission or fitness for purpose. No apparatus, equipment, fixture or fitting has been tested. Items shown in photographs are not necessarily included. Purchasers must satisfy themselves on all matters by inspection or otherwise.

2 High Street, Castle Cary, Somerset, BA7 7AW- Tel: 01963 351993 - E: cc@roderickthomas.co.uk

