

LEASEHOLD

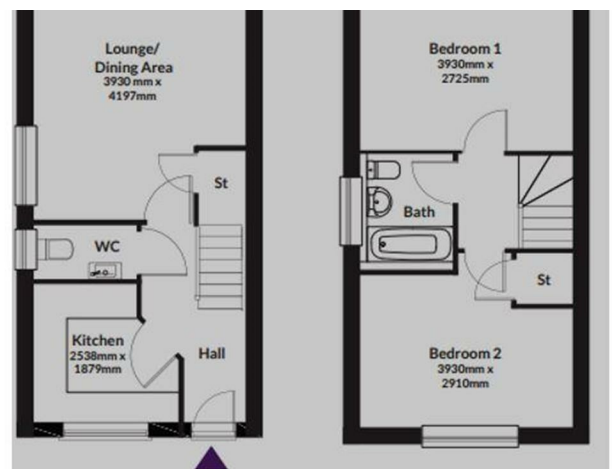

House - End Terrace (EPC Rating:)

**PLOT 11, 11 FIELD MAPLE CLOSE, ASHWELL,
BALDOCK, HERTFORDSHIRE, SG7 5BA**

Shared Ownership

£132,125



First Step



2 Bedroom House - End Terrace located in Baldock

2 BED shared ownership HOUSE £132,125 for a 35% share... 2 PARKING SPACES... EV charger... Integrated oven, hob, extractor.... VINYL & CARPETS included... TO RESERVE CALL US TODAY...



PLOT 11 - 2 BED

Council Tax Band

Energy Performance Graph

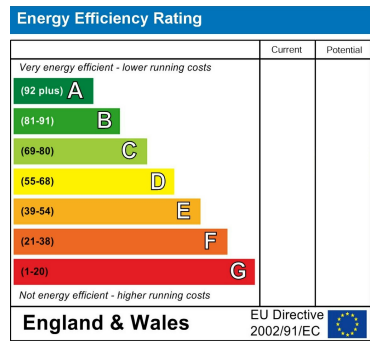

Call us on
01462 659 730
sales@firststep.ltd
www.firststep.ltd

Agents Note: Whilst every care has been taken to prepare these particulars, they are for guidance purposes only. All measurements are approximate and are for general guidance purposes only and whilst every care has been taken to ensure their accuracy, they should not be relied upon and potential buyers are advised to recheck the measurements.