

LEASEHOLD



House - Mews (EPC Rating: C)

38 MIDDLEMARCH, FAIRFIELD, HITCHIN, HERTS, SG5 4JJ

Price Guide

£325,000



First Step



2 Bedroom House - Mews located in Fairfield, Hitchin

CHAIN FREE... Peaceful Location... PRIVATE GARDEN... 2 DOUBLE bedrooms... UPGRADED Kitchen with NEFF appliances... LIGHT Lounge/Diner with doors to rear garden... UPGRADED BATHROOM... ALLOCATED Parking...

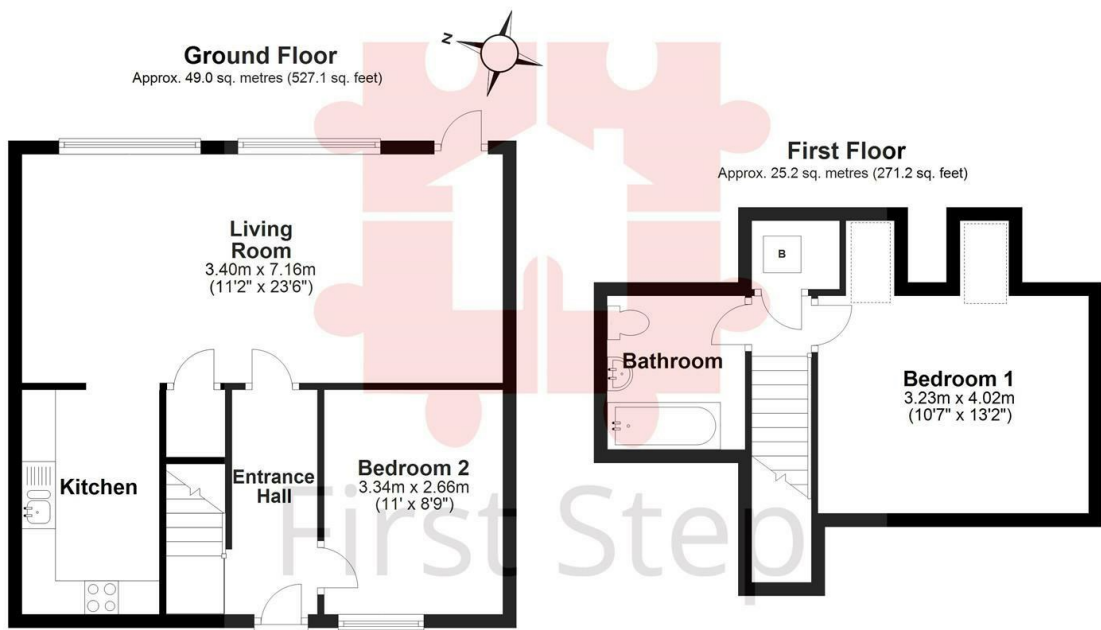

Total area: approx. 74.2 sq. metres (798.3 sq. feet)

Council Tax Band
C

Energy Performance Graph

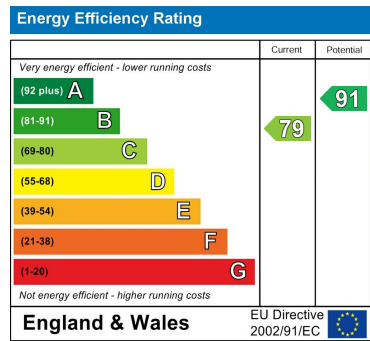

Call us on
01462 659 730
sales@firststep.ltd
www.firststep.ltd

Agents Note: Whilst every care has been taken to prepare these particulars, they are for guidance purposes only. All measurements are approximate and are for general guidance purposes only and whilst every care has been taken to ensure their accuracy, they should not be relied upon and potential buyers are advised to recheck the measurements.