

FREEHOLD



House - Semi-Detached (EPC Rating: C)

84 CHURCH ROAD, STOTFOLD, HITCHIN, HERTS, SG5 4NG

Offers Over

£400,000



First Step



3 Bedroom House - Semi-Detached located in Hitchin

3 DOUBLE bedrooms... STUDY/TV Room... Kitchen and SEPARATE DINING room... CONSERVATORY... Bathroom/Shower Room... Cloakroom/UTILITY ROOM... Low maintenance GARDEN... DRIVEWAY PARKING for 3 CARS...

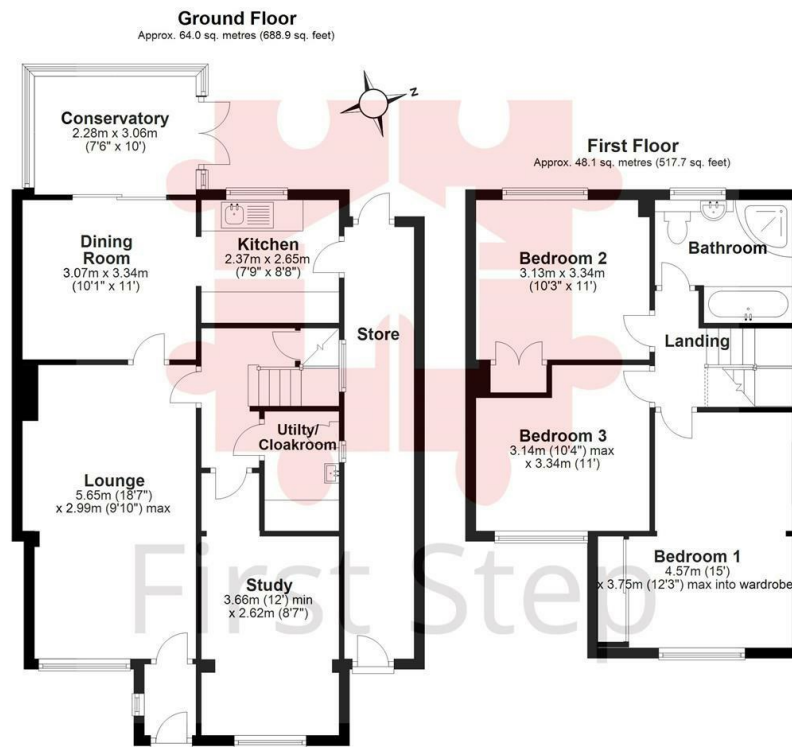

Total area: approx. 112.1 sq. metres (1206.6 sq. feet)

Council Tax Band
D

Energy Performance Graph

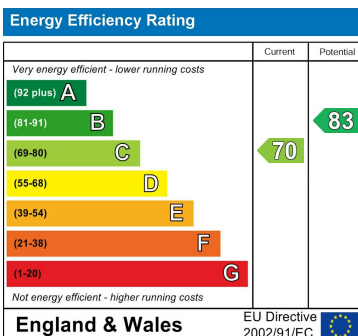

Call us on
01462 659 730
sales@firststep.ltd
www.firststep.ltd

Agents Note: Whilst every care has been taken to prepare these particulars, they are for guidance purposes only. All measurements are approximate and are for general guidance purposes only and whilst every care has been taken to ensure their accuracy, they should not be relied upon and potential buyers are advised to recheck the measurements.



First Step