

LEASEHOLD



Apartment (EPC Rating: C)

**43 RICHMOND HOUSE, 61-71 VICTORIA AVENUE,
SOUTHEND-ON-SEA, ESSEX, SS2 6FP**

Shared Ownership

£90,000



First Step



C

2 Bedroom Apartment located in Southend-On-Sea

****SHARED OWNERSHIP**** MODERN and SPACIOUS two bedroom 6th floor apartment with in a landmark development, Richmond House. ONLY £90,000 for a 40% share.

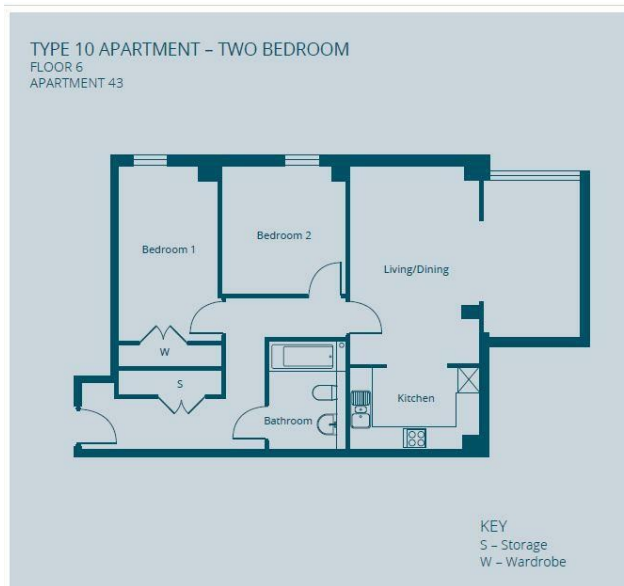

DIMENSIONS			
Living/Dining	6.08m	x	4.6m
Kitchen	3.39m	x	2.14m
Bedroom 1	4.60m	x	2.62m
Bedroom 2	3.38m	x	3.27m
Total	82m ²		883ft ²

BLOCKPLAN

Council Tax Band

D

Energy Performance Graph

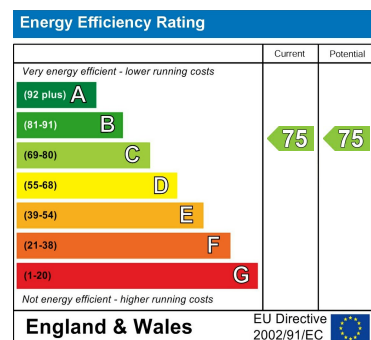

Call us on

01462 659 730

sales@firststep.ltd

www.firststep.ltd

Agents Note: Whilst every care has been taken to prepare these particulars, they are for guidance purposes only. All measurements are approximate and are for general guidance purposes only and whilst every care has been taken to ensure their accuracy, they should not be relied upon and potential buyers are advised to recheck the measurements.



First Step