

FREEHOLD



House - Semi-Detached (EPC Rating: C)

**10 HARDY WAY, FAIRFIELD, HITCHIN,
HERTFORDSHIRE, SG5 4GH**

Price Guide

£425,000



First Step



C

3 Bedroom House - Semi-Detached located in Fairfield, Hitchin

CHAIN FREE... 3 DOUBLE bedrooms... ENTERTAINING Kitchen/Dining Room... BOOT ROOM... Main EN-SUITE and WALK-IN WARDROBE... GARAGE & PARKING... OAK flooring... Garden HOME OFFICE/SHED...

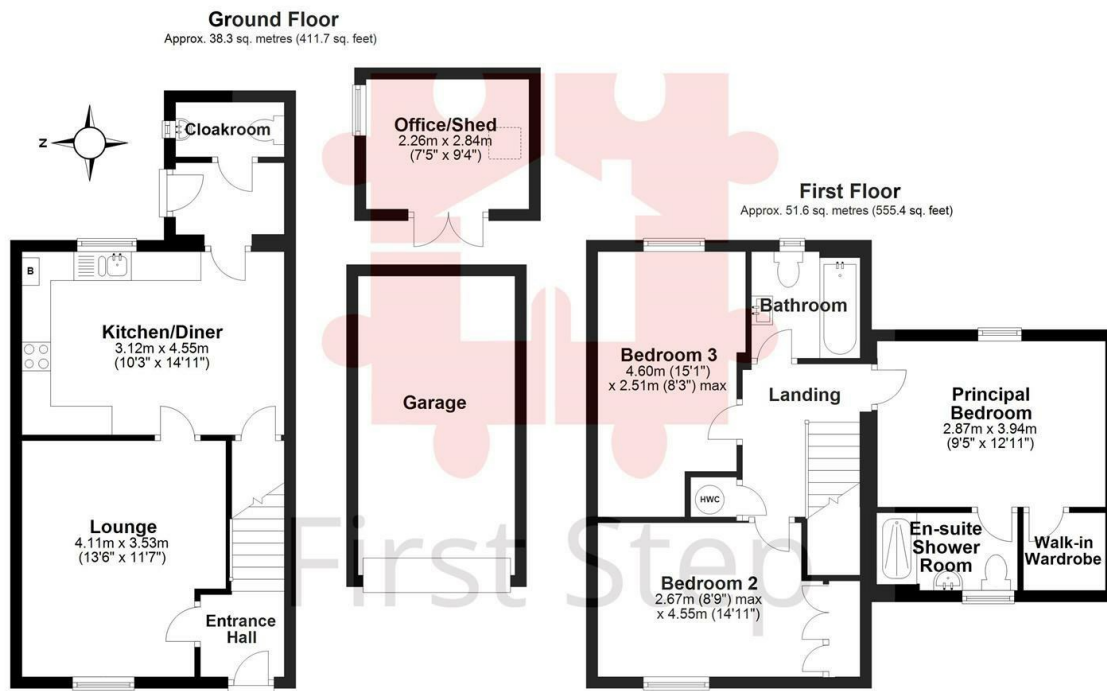

Total area: approx. 89.8 sq. metres (967.1 sq. feet)

Council Tax Band

D

Energy Performance Graph

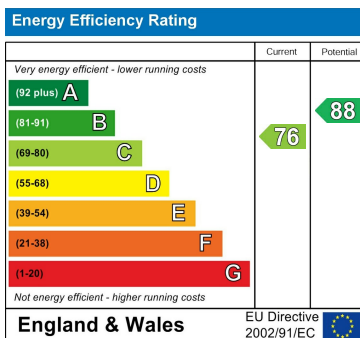

Call us on

01462 659 730

sales@firststep.ltd

www.firststep.ltd

Agents Note: Whilst every care has been taken to prepare these particulars, they are for guidance purposes only. All measurements are approximate and are for general guidance purposes only and whilst every care has been taken to ensure their accuracy, they should not be relied upon and potential buyers are advised to recheck the measurements.



First Step