

FREEHOLD



House - Semi-Detached (EPC Rating: C)

**23 FENNEL AVENUE, STOTFOLD, HITCHIN, HERTS,
SG5 4LJ**

**Offers Over
£330,000**



First Step



C

2 Bedroom House - Semi-Detached located in Stotfold, Hitchin

IDEAL FIRST PURCHASE... WEST Facing Garden... PEACEFUL location... Driveway PARKING for 4 CARS... 2 DOUBLE Bedrooms... DUAL ASPECT Lounge/Diner... DOWNSTAIRS Cloakroom... CLOSE to Local Amenities...

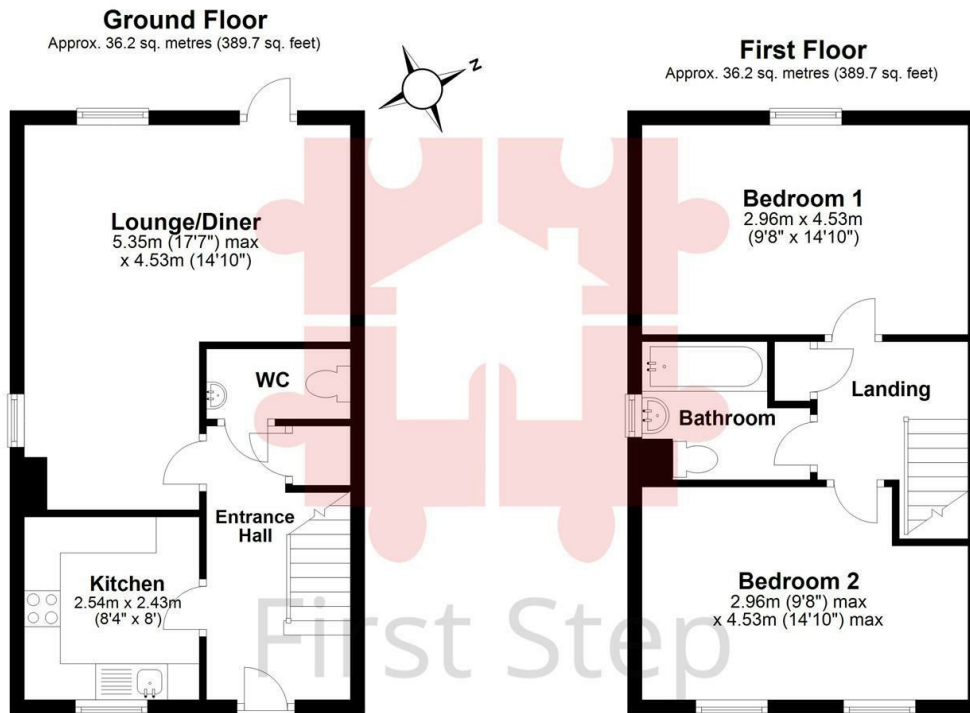

Total area: approx. 72.4 sq. metres (779.4 sq. feet)

Floor Plan measurements are approximate & for illustrative purposes only. While we do not doubt the floor plans accuracy, we make no guarantee, warranty or representation as to the accuracy and completeness of the floor plan. Plan produced using PlanUp.

Council Tax Band

C

Energy Performance Graph

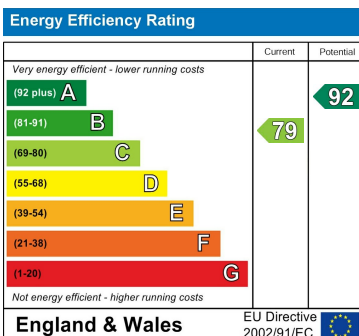

Call us on

01462 659 730

sales@firststep.ltd

www.firststep.ltd

Agents Note: Whilst every care has been taken to prepare these particulars, they are for guidance purposes only. All measurements are approximate and are for general guidance purposes only and whilst every care has been taken to ensure their accuracy, they should not be relied upon and potential buyers are advised to recheck the measurements.



First Step