

FREEHOLD



House - Mid Terrace (EPC Rating: D)

**2 MELBOURNE CLOSE, STOTFOLD HITCHIN, HERTS,
SG5 4LB**

Offers Over

£339,995



First Step



D

3 Bedroom House - Mid Terrace located in Stotfold Hitchin

VIDEO ATTACHED... Beautifully Presented... IDEAL LOCATION... UPGRADED Kitchen... DOWNSTAIRS Cloakroom... NEWLY Fitted BATHROOM... 3 GOOD Sized Bedrooms... GARAGE Plus DRIVEWAY PARKING for 2 CARS... EXCELLENT storage...

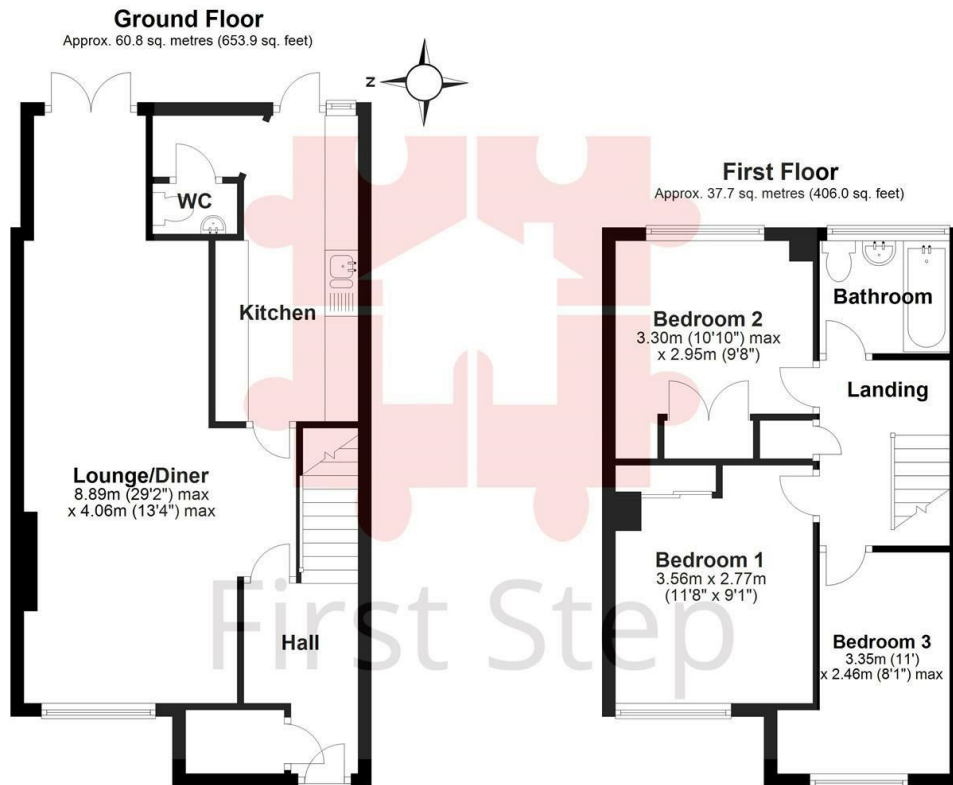

Total area: approx. 98.5 sq. metres (1059.9 sq. feet)

Council Tax Band

C

Energy Performance Graph

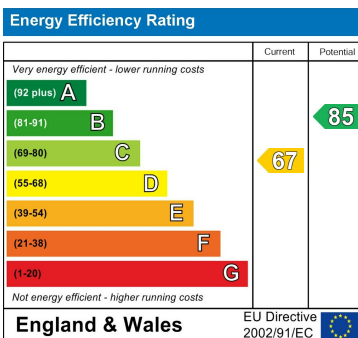

Call us on

01462 659 730

sales@firststep.ltd

www.firststep.ltd

Agents Note: Whilst every care has been taken to prepare these particulars, they are for guidance purposes only. All measurements are approximate and are for general guidance purposes only and whilst every care has been taken to ensure their accuracy, they should not be relied upon and potential buyers are advised to recheck the measurements.



First Step