

FREEHOLD



Bungalow - Detached (EPC Rating: E)

17 THE GARDENS, STOTFOLD, HITCHIN, HERTS, SG5 4HD

Price Guide

£725,000



First Step



4 Bedroom Bungalow - Detached located in Stotfold, Hitchin

1648 sq ft... VIDEO attached... DETACHED bungalow on LARGE PLOT... Situated in a peaceful sought after CUL-DE-SAC location... 4 DOUBLE bedrooms... DOUBLE GARAGE... Driveway parking for 4 CARS... GARDEN Room... Large Kitchen with BREAKFAST Room... Large SECLUDED GARDEN with GREEN HOUSE and GARDEN STORE...

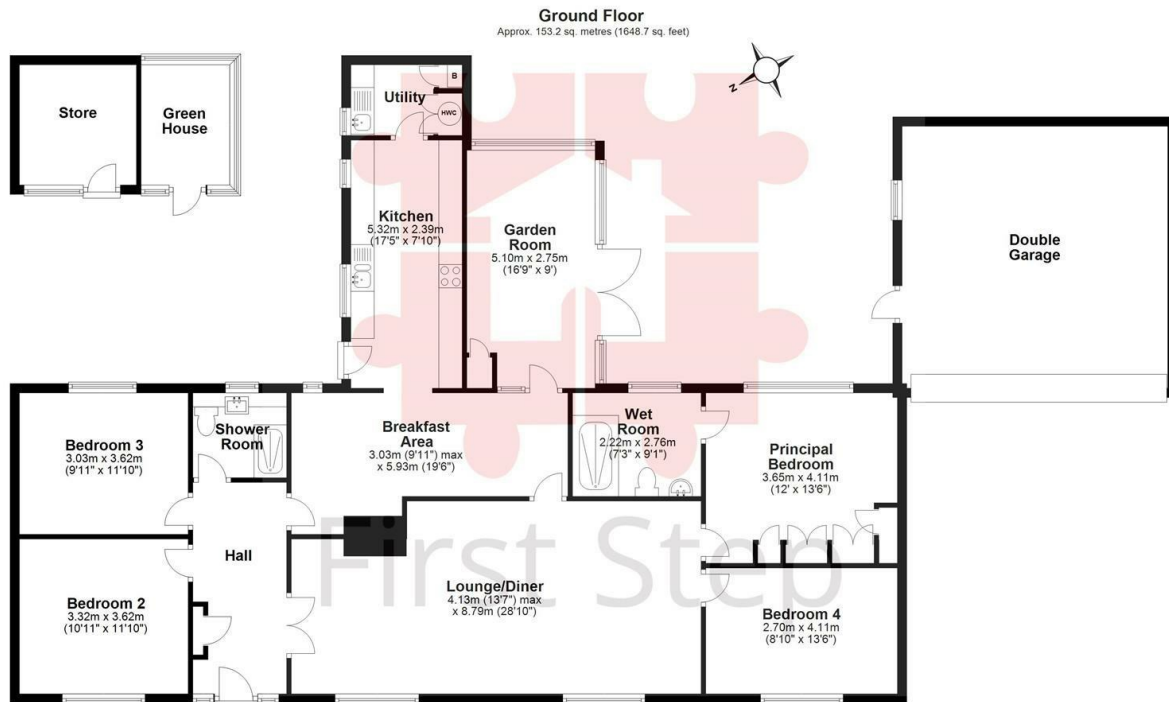

Total area: approx. 153.2 sq. metres (1648.7 sq. feet)

Council Tax Band

F

Energy Performance Graph

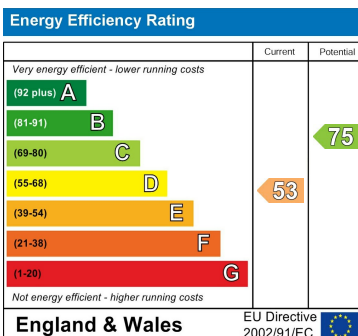

Call us on

01462 659 730

sales@firststep.ltd

www.firststep.ltd

Agents Note: Whilst every care has been taken to prepare these particulars, they are for guidance purposes only. All measurements are approximate and are for general guidance purposes only and whilst every care has been taken to ensure their accuracy, they should not be relied upon and potential buyers are advised to recheck the measurements.



First Step