

FREEHOLD



House - Detached (EPC Rating: B)

**2 HAWTHORN CROFT, STOTFOLD, HITCHIN, HERTS,  
SG5 4RT**

**Price Guide**

**£485,000**



First Step



4



2



1



B

# 4 Bedroom House - Detached located in Hitchin

CHAIN FREE... BEAUTIFULLY PRESENTED DETACHED HOME.. 4 DOUBLE bedrooms... TOP Floor Principal Bedroom with EN-SUITE... ENTERTAINING kitchen/Diner... UTILITY ROOM... SOUTH FACING Garden... GARAGE plus Driveway

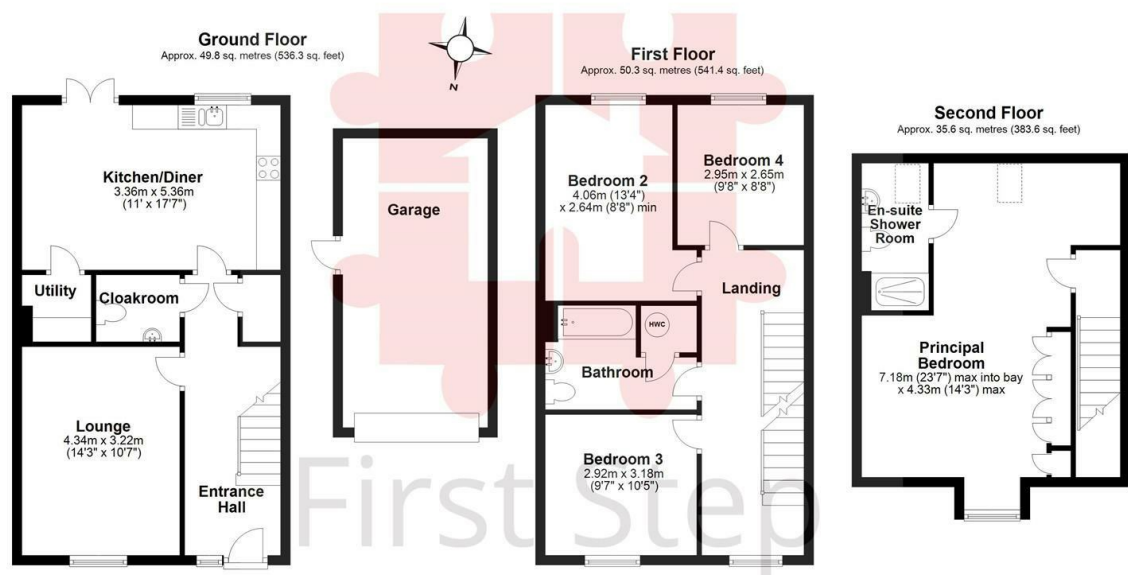

Total area: approx. 135.8 sq. metres (1461.3 sq. feet)

Council Tax Band  
**E**  
Energy Performance Graph

Call us on  
**01462 659 730**  
**sales@firststep.ltd**  
**www.firststep.ltd**

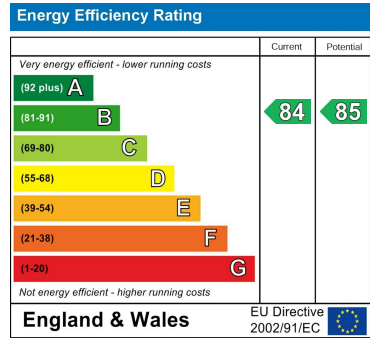

Agents Note: Whilst every care has been taken to prepare these particulars, they are for guidance purposes only. All measurements are approximate and are for general guidance purposes only and whilst every care has been taken to ensure their accuracy, they should not be relied upon and potential buyers are advised to recheck the measurements.