

LEASEHOLD



Apartment (EPC Rating: D)

**98 HERTFORDSHIRE WING, KINGSLEY AVENUE,  
FAIRFIELD PARK, HITCHIN, HERTS, SG5 4FX**

**Price Guide**

**£275,000**



First Step



# 2 Bedroom Apartment located in Fairfield Park, Hitchin

GROUND FLOOR Apartment... 2 DOUBLE BEDROOMS... Open Plan Living... Character FEATURE BEAMS... Allocated Parking space... EXCELLENT STORAGE... Beautifully presented... Ample visitor parking...

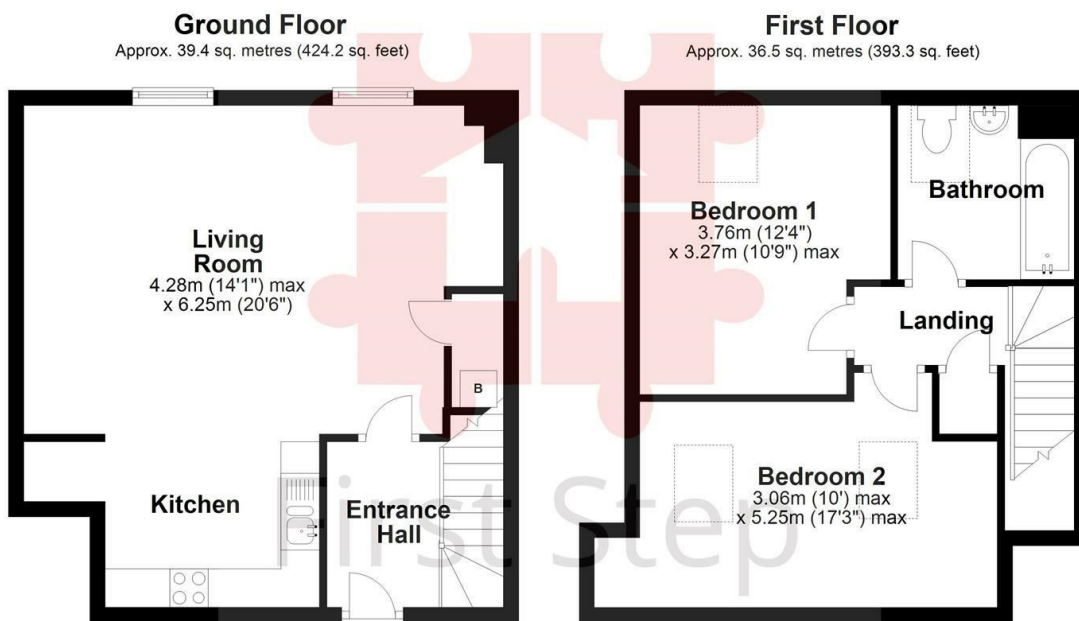

Total area: approx. 76.0 sq. metres (817.5 sq. feet)

Council Tax Band

**D**

Energy Performance Graph

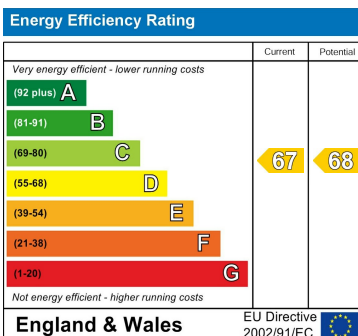

Call us on

**01462 659 730**

**sales@firststep.ltd**

**www.firststep.ltd**

Agents Note: Whilst every care has been taken to prepare these particulars, they are for guidance purposes only. All measurements are approximate and are for general guidance purposes only and whilst every care has been taken to ensure their accuracy, they should not be relied upon and potential buyers are advised to recheck the measurements.



**First Step**