

FREEHOLD



House - Townhouse (EPC Rating: C)

**3 GLADSTONE DRIVE, FAIRFIELD, HITCHIN, HERTS,
SG5 4FQ**

Price Guide

£495,000



First Step



5 Bedroom House - Townhouse located in Fairfield, Hitchin

5 DOUBLE BEDROOM family home... ENTERTAINING Kitchen/Breakfast Room... SEPARATE Dining Room... UTILITY Room.. 3 BATHROOM/SHOWER ROOMS... Lounge with French doors leading to PRIVATE rear garden... GARAGE Plus Parking...

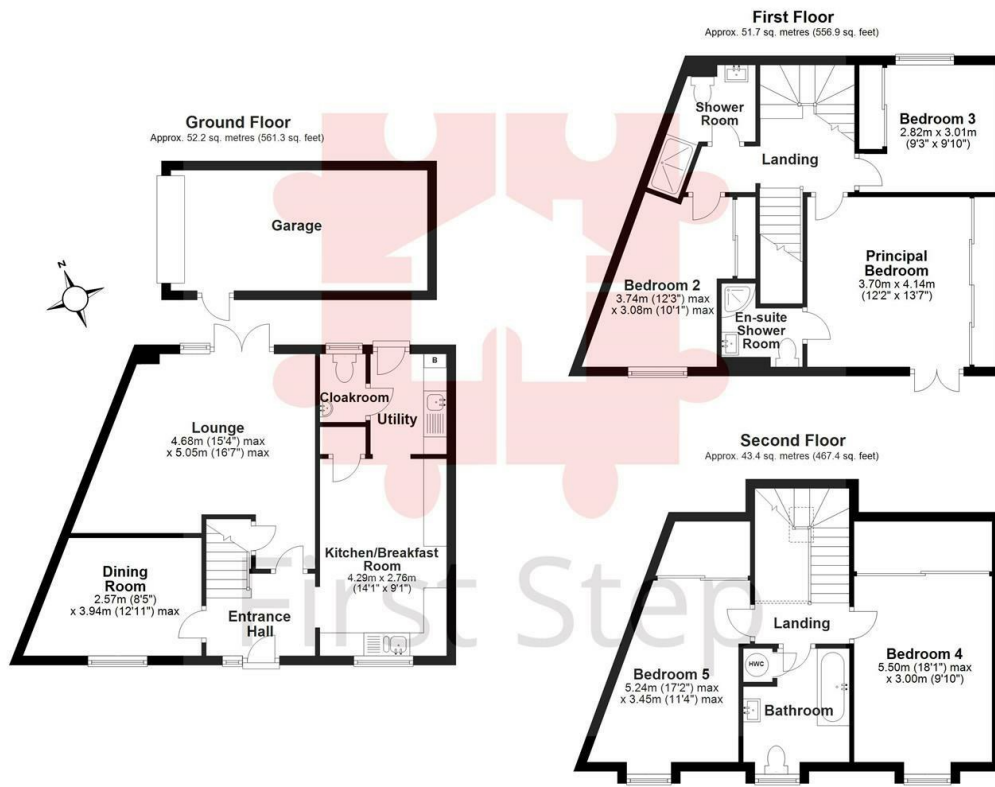

Total area: approx. 147.3 sq. metres (1585.6 sq. feet)

Council Tax Band

F

Energy Performance Graph

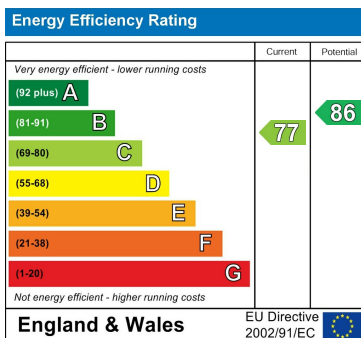

Call us on

01462 659 730

sales@firststep.ltd

www.firststep.ltd

Agents Note: Whilst every care has been taken to prepare these particulars, they are for guidance purposes only. All measurements are approximate and are for general guidance purposes only and whilst every care has been taken to ensure their accuracy, they should not be relied upon and potential buyers are advised to recheck the measurements.



First Step