

FREEHOLD



House - Detached (EPC Rating: D)

## **PENIBLE HOUSE, 28A ICKWELL ROAD, NORTHILL, BIGGLESWADE, BEDS, SG18 9AB**

**Offers Over**  
**£800,000**



First Step





# 4 Bedroom House - Detached located in Biggleswade

CHAIN FREE... Stunning COUNTRYSIDE VIEWS... Approx 1 ACRE plot... Large WEST FACING garden... leading to PRIVATE PADDOCK... IDYLIC VILLAGE location... DOUBLE GARAGE... Driveway parking for 5 VEHICLES... Master EN-SUITE... 4 DOUBLE BEDROOMS...

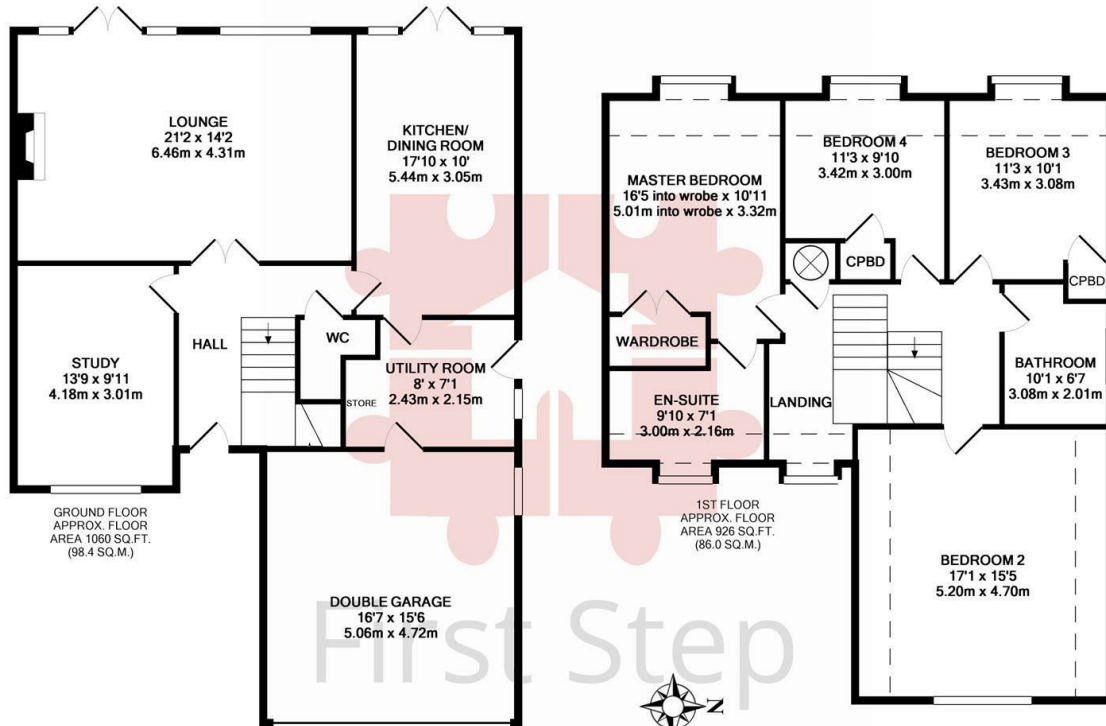

NO28AIR  
 TOTAL APPROX. FLOOR AREA 1985 SQ.FT. (184.4 SQ.M.)  
 Whilst every attempt has been made to ensure the accuracy of the floor plan contained here, measurements of doors, windows, rooms and any other items are approximate and no responsibility is taken for any error, omission, or mis-statement. This plan is for illustrative purposes only and should be used as such by any prospective purchaser. The services, systems and appliances shown have not been tested and no guarantee as to their operability or efficiency can be given  
 Made with Metropix ©2019

Council Tax Band

G

Energy Performance Graph

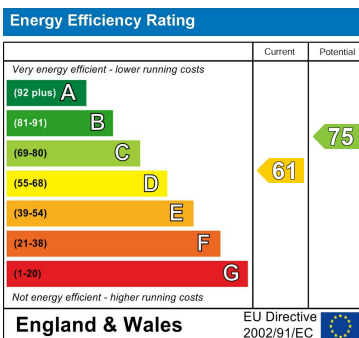

Call us on

01462 659 730

sales@firststep.ltd

www.firststep.ltd

Agents Note: Whilst every care has been taken to prepare these particulars, they are for guidance purposes only. All measurements are approximate and are for general guidance purposes only and whilst every care has been taken to ensure their accuracy, they should not be relied upon and potential buyers are advised to recheck the measurements.



First Step