

First Step

01462 659 730 

info@firststep.ltd 

DETACHED HOUSE

76 NORTON ROAD, STOTFOLD, HITCHIN, HERTS, SG5 4PG

GUIDE PRICE £495,000



SUMMARY

CHAIN FREE... DETACHED CHARACTER PROPERTY... Dual aspect Living Room... SEPARATE DINING ROOM... Kitchen Plus Utility... 2 GOOD SIZED BEDROOMS... SOUTH WEST FACING garden... GARAGE Plus Driveway Parking... SET BACK from the road overlooking GREEN AREA TO FRONT ASPECT...

Guide Price £495,000

76 Norton Road, Stotfold, Hitchin, Herts, SG5 4PG

- CHAIN FREE
- CHARACTER DETACHED HOME
- ENORMOUS POTENTIAL TO EXTEND
- DUAL ASPECT LIVING ROOM
- SEPARATE DINING ROOM
- KITCHEN PLUS UTILITY
- TWO GOOD SIZED BEDROOMS
- LARGE SOUTH WEST FACING GARDEN
- GARAGE PLUS DRIVEWAY PARKING
- CUL-DE-SAC LOCATION OVERLOOKING GREEN AREA

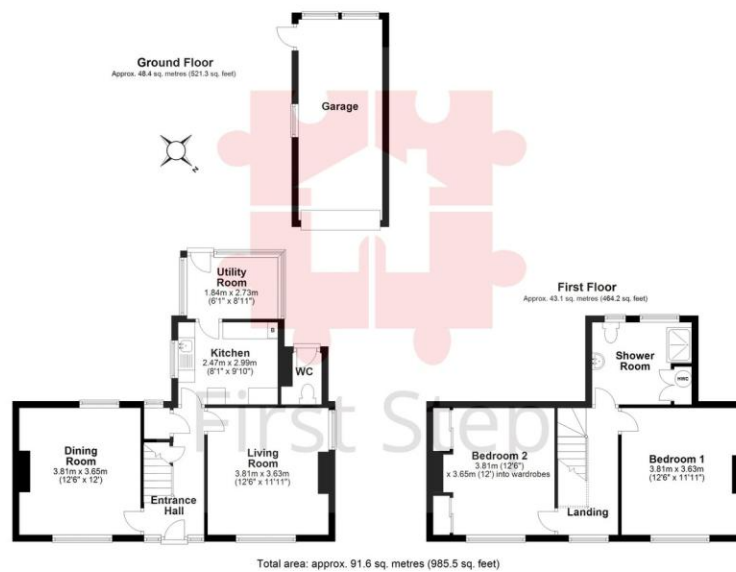

WATERLOO FARM
Stotfold Road, Arlesey, Bedfordshire, SG15 6XP

CONTACT
01462 659 730 www.firststep.ltd

Agents Note: Whilst every care has been taken to prepare these sales particulars, they are for guidance purposes only. All measurements are approximate and for general guidance purposes only and whilst every care has been taken to ensure their accuracy, they should not be relied upon and potential buyers are advised to recheck the measurements