



11 Sherwood Hall , East Finchley, N2 0TA

We offer this two bedroom second floor apartment situated in this popular block off East End Road, N2. The bright and airy property offers spacious living through out whilst further benefitting off street parking, communal gardens, is offered chain free with a share of freehold.

£400,000

11 Sherwood Hall

, East Finchley, N2 0TA



- Reception
- Bathroom
- Share of Freehold
- Kitchen
- Off Street Parking
- Chain Free
- Two Bedrooms
- Communal Gardens

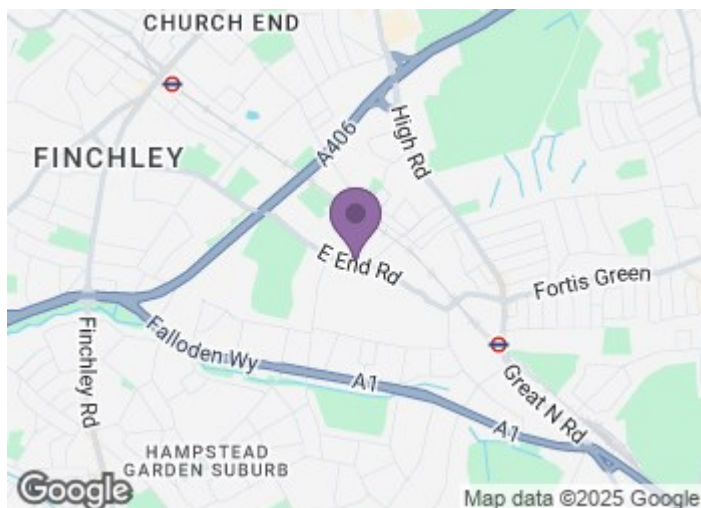

[Directions](#)





Floor Plan

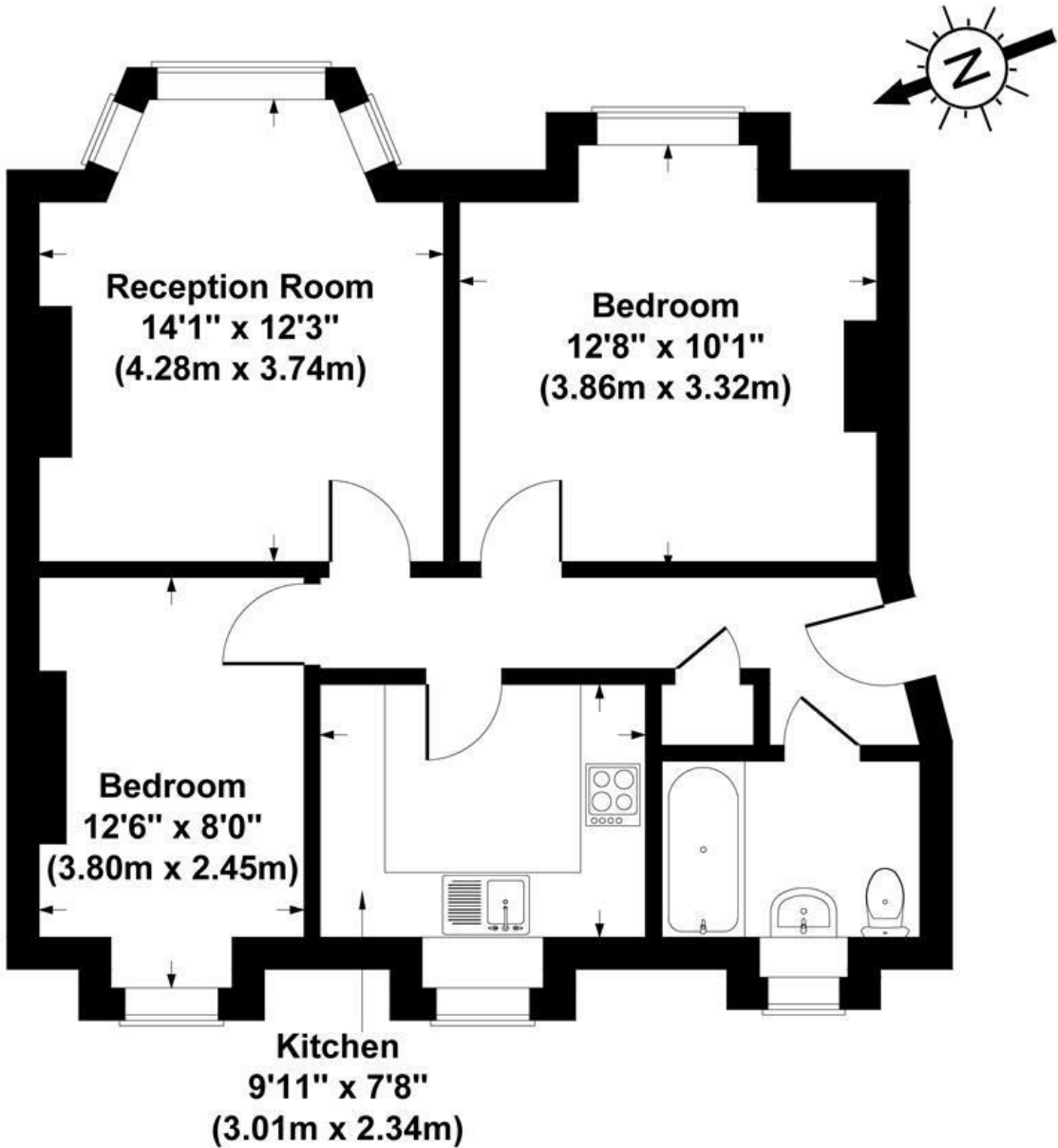

Second Floor

Sherwood Hall, London, N2

Gross Internal Area 624 sq ft / 58 sq metres

Not to Scale. Produced by The Plan Portal 2023

For Illustrative Purposes Only.

These particulars, whilst believed to be accurate are set out as a general outline only for guidance and do not constitute any part of an offer or contract. Intending purchasers should not rely on them as statements of representation of fact, but must satisfy themselves by inspection or otherwise as to their accuracy. No person in this firms employment has the authority to make or give any representation or warranty in respect of the property.

Energy Efficiency Rating		
	Current	Potential
Very energy efficient - lower running costs		
(92 plus) A		
(81-91) B		
(69-80) C		
(55-68) D		
(39-54) E		
(21-38) F		
(1-20) G		
Not energy efficient - higher running costs		
England & Wales		
EU Directive 2002/91/EC		