

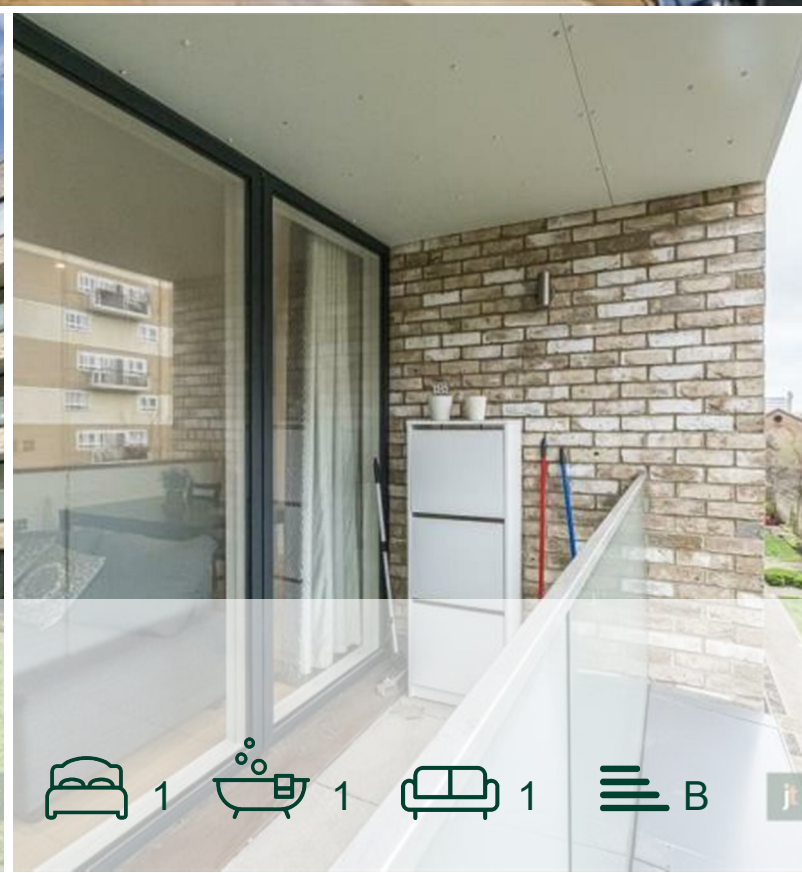

Cambridge Avenue, Maida  
Vale, NW6

£425,000



# Cambridge Avenue, Maida Vale, NW6

£425,000



## Summary Description

Nestled in the heart of London, this modern and beautifully presented one-bedroom apartment offers a delightful living experience. The property boasts a generous open-plan reception room and kitchen leading onto a private balcony, creating a bright and inviting space perfect for both relaxation and entertaining. The spacious double bedroom provides a comfortable retreat, while the stunning family bathroom adds a touch of luxury to your daily routine.

Situated in a prime location, this home is just a short stroll away from the vibrant areas of Maida Vale and Little Venice, where you can enjoy an array of shops, cafes, and picturesque canals. Additionally, the convenience of Kilburn Park station being mere steps away ensures easy access to the rest of London, making commuting a breeze.

This property is offered chain-free, allowing for a smooth and straightforward purchase process. Whether you are a first-time buyer or looking to downsize, this charming house presents an excellent opportunity to embrace the best of London living. Don't miss the chance to make this lovely home your own.

## Area Map

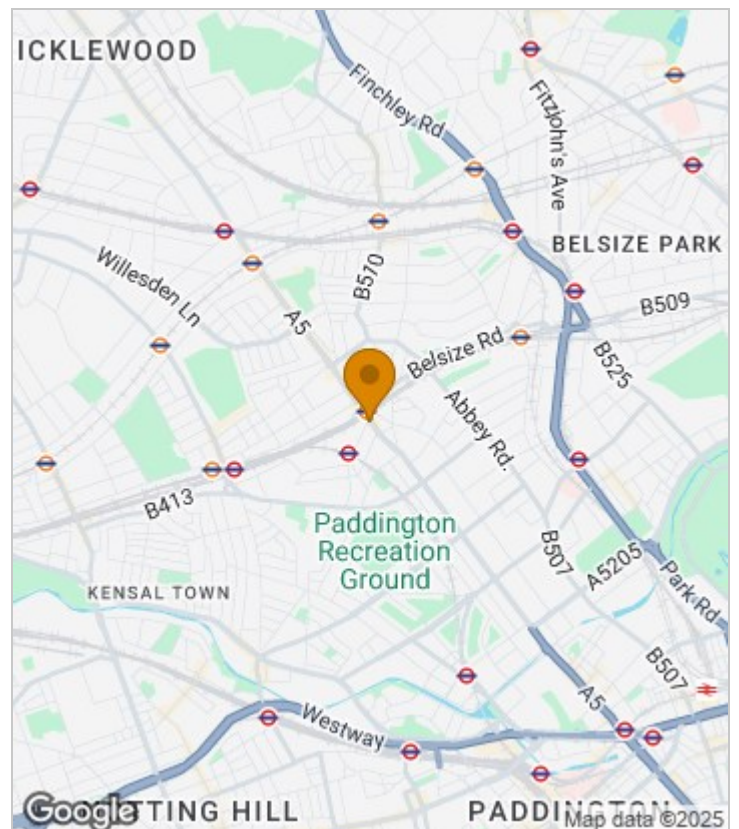



## Floor Plan

jorgensenturner  
estate agents

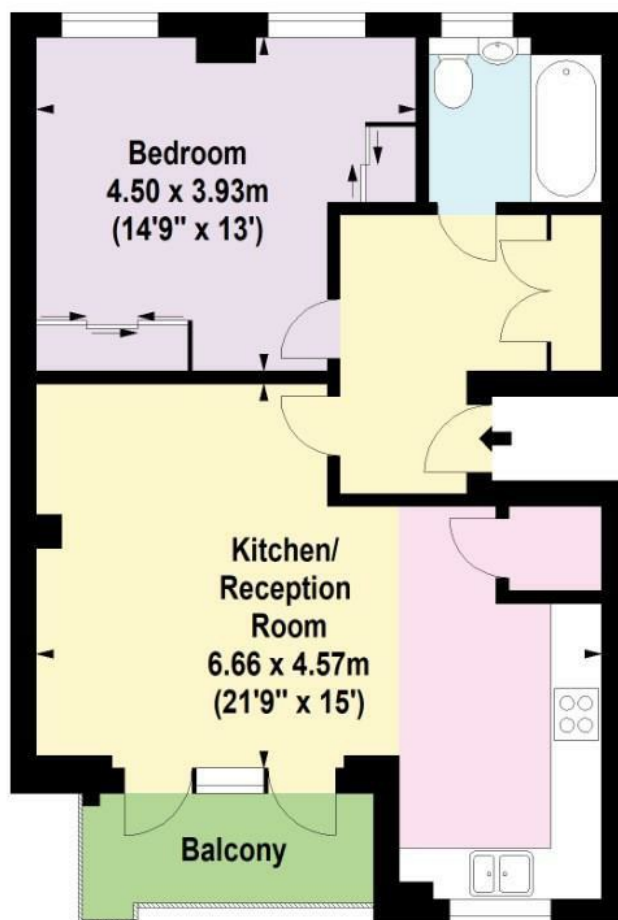

First Floor

For Identification Purposes Only. Not To Scale. © www.totalvista.uk 2023

Cambridge Avenue, NW6

Approx. Gross Internal Area  
58.90 Sq M - 634 Sq Ft



TOTAL VISTA

## Energy Efficiency Graph

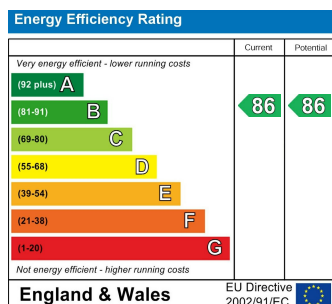

## Viewing

Please contact our Sales QP Office on 0207 604 4040 if you wish to arrange a viewing appointment for this property or require further information.

- Spacious open-plan reception room and kitchen
- Private balcony
- Modern throughout
- A short walk from Kilburn Park station
- Walking distance to Maida Vale and Little Venice
- Chain free

For further information contact:

Sales QP, 2a Brondesbury Road, London, NW6 6AS

Tel: 0207 604 4040 Email: [info@jorgensenturner.com](mailto:info@jorgensenturner.com) <https://www.jorgensenturner.com/>

## Disclaimer

These particulars, whilst believed to be accurate are set out as a general outline only for guidance and do not constitute any part of an offer or contract. Intending purchasers should not rely on them as statements of representation of fact, but must satisfy themselves by inspection or otherwise as to their accuracy. No person in this firm's employment has the authority to make or give any representation or warranty in respect of the property.

