



Canterbury Road, North  
Maida Vale, NW6

£325,000

2 0 0 C

# Canterbury Road, North Maida Vale, NW6

£325,000

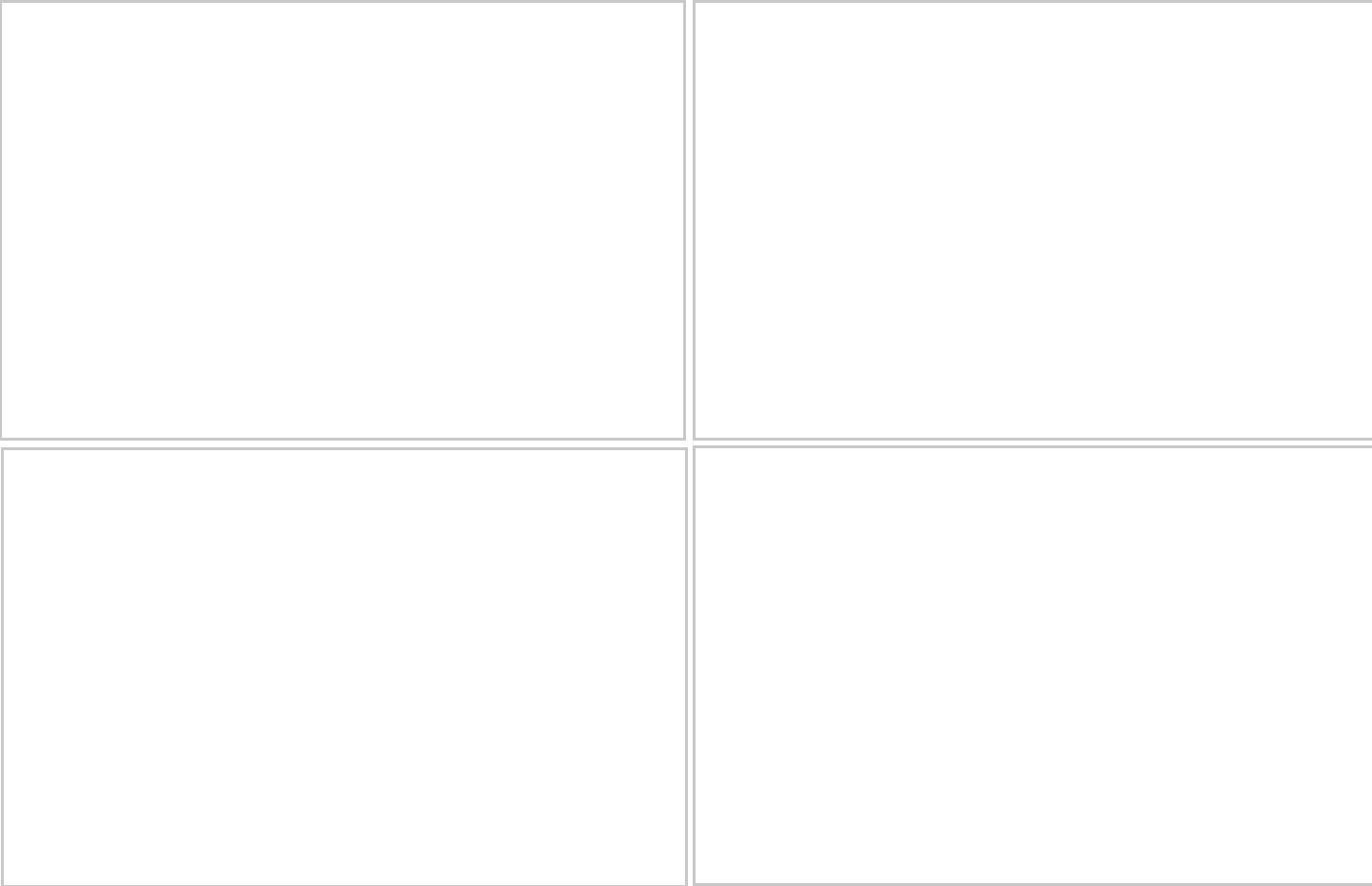

## Summary Description

Set on the lower ground floor of this historic former public house this unmodernised property presents an excellent investment opportunity for those looking to add their personal touch and increase its value. The property has been very realistically priced in order to attract an immediate sale and would suit a cash buyer or a buyer with a significant cash deposit.

Situated conveniently close to Kilburn Park Tube station, commuting is a breeze, making this property ideal for those who value easy access to transportation. Additionally, the short walk to Queens Park and Maida Vale offers a delightful escape to green spaces and local amenities. As the ongoing development of the immediate area continues , there is significant potential for future capital appreciation.

## Area Map

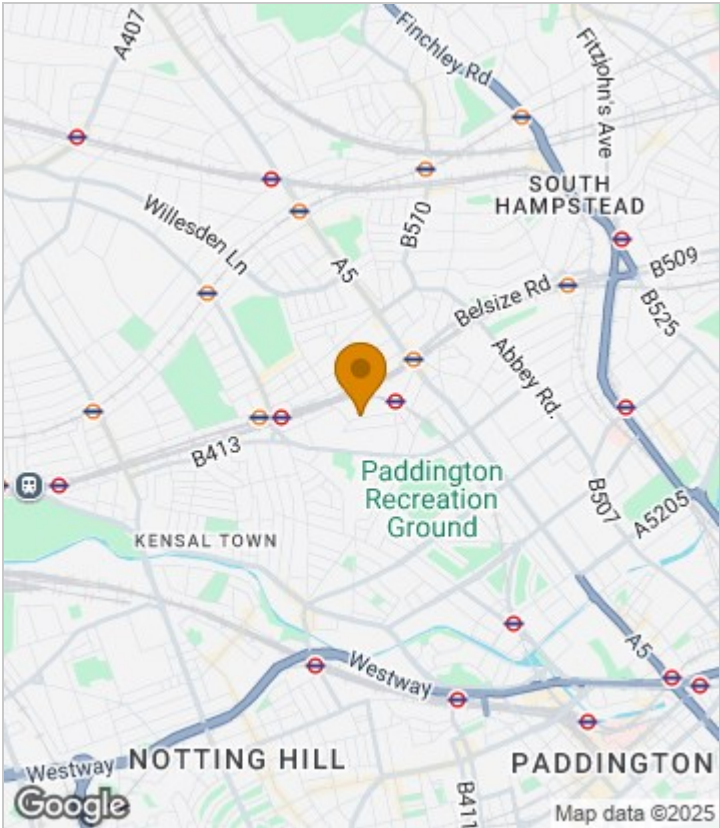



Floor Plan

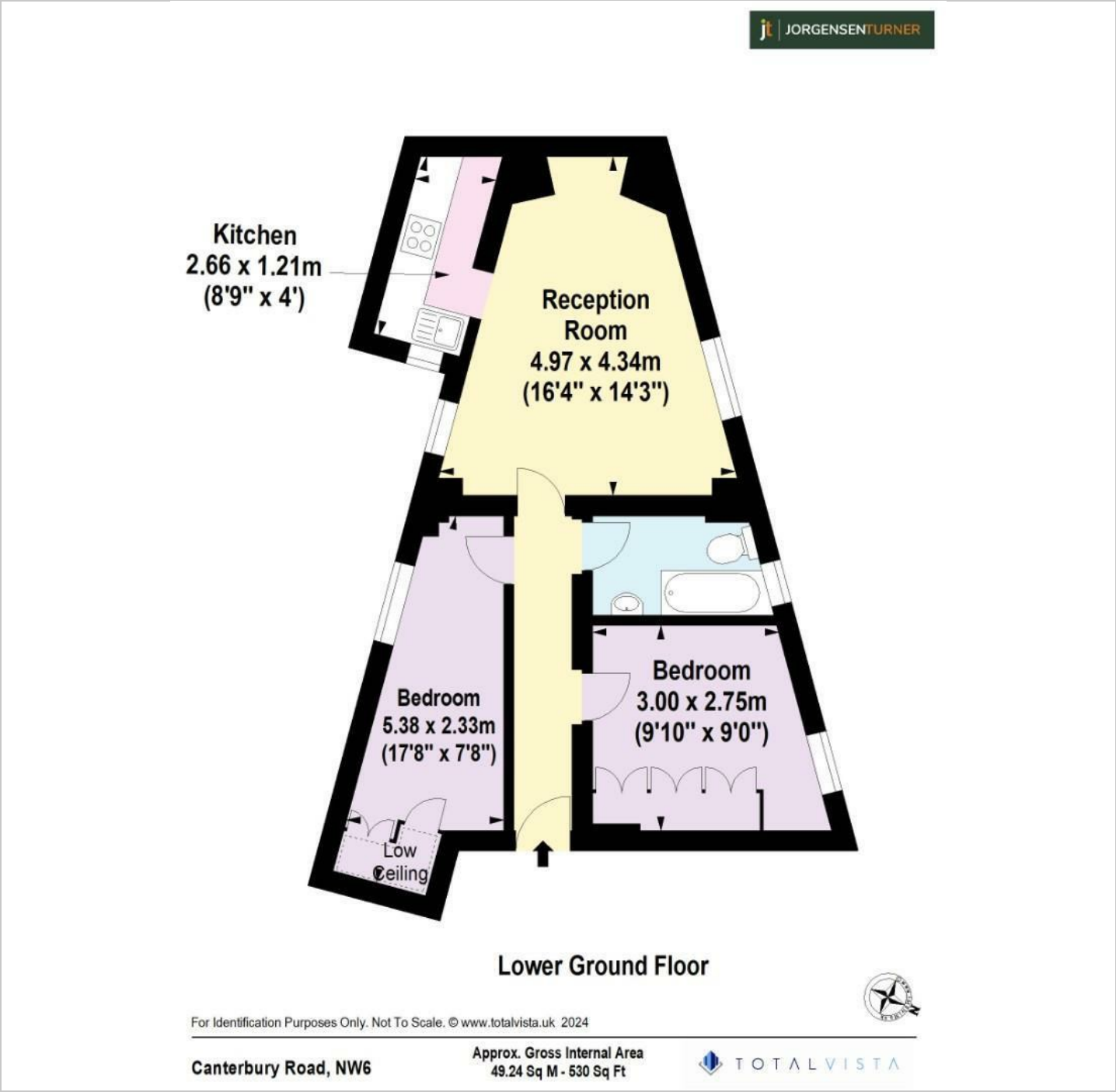

Energy Efficiency Graph

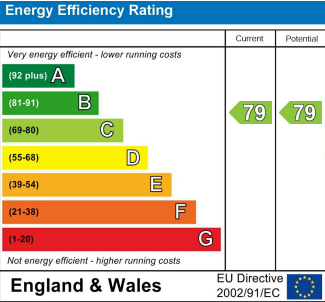

Viewing

Please contact our Sales QP Office on 0207 604 4040 if you wish to arrange a viewing appointment for this property or require further information.

For further information contact:  
Sales QP, 2a Brondesbury Road, London, NW6 6AS  
Tel: 0207 604 4040 Email: info@jorgensenturner.com https://www.jorgensenturner.com/

Disclaimer

These particulars, whilst believed to be accurate are set out as a general outline only for guidance and do not constitute any part of an offer or contract. Intending purchasers should not rely on them as statements of representation of fact, but must satisfy themselves by inspection or otherwise as to their accuracy. No person in this firms employment has the authority to make or give any representation or warranty in respect of the property.

