

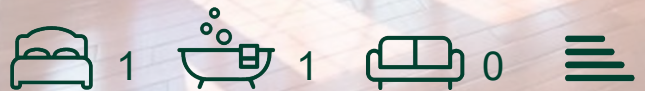

Willesden Lane, London

£1,395 Per Month



Willesden Lane, London

£1,395 Per Month



Summary Description

Lovely and bright studio is available from 8th of November. Presented in a very good condition, charming studio flat offers great living space, modern kitchen, large bathroom and good storage. This property comes unfurnished, other features are double glazed windows, wooden floor throughout. Off street parking available for extra £50p/m. Extra £150 payable for the landlord for all the bills.

Close to Brondesbury Park, Brondesbury and Willesden Green stations, has great connections to central London. One week's holding deposit required, 5 weeks damage deposit required. Please call Jorgensen Turner Estate agents to arrange a viewing. EPC rating D.

Area Map

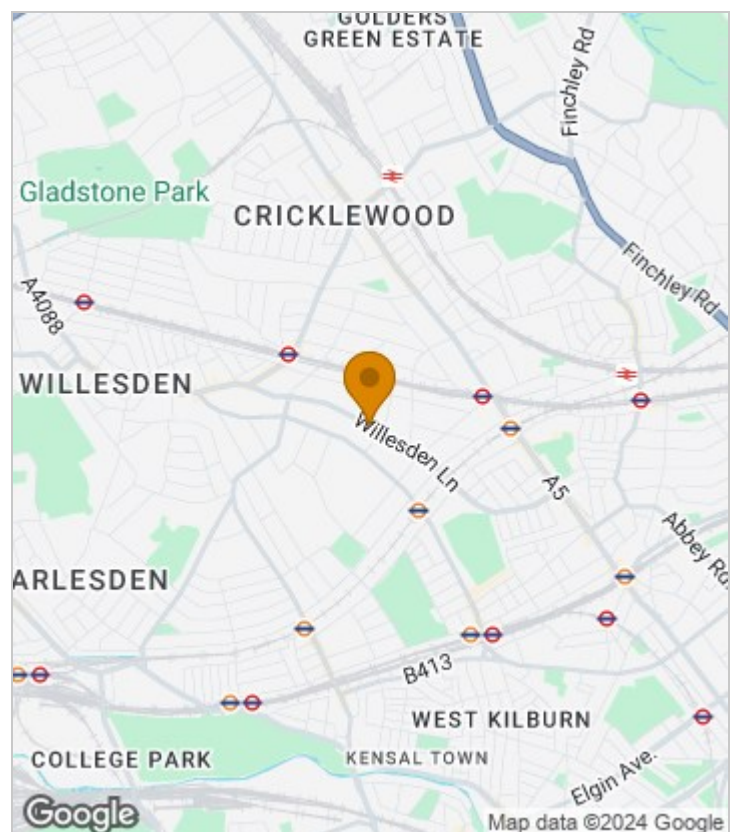

Floor Plan

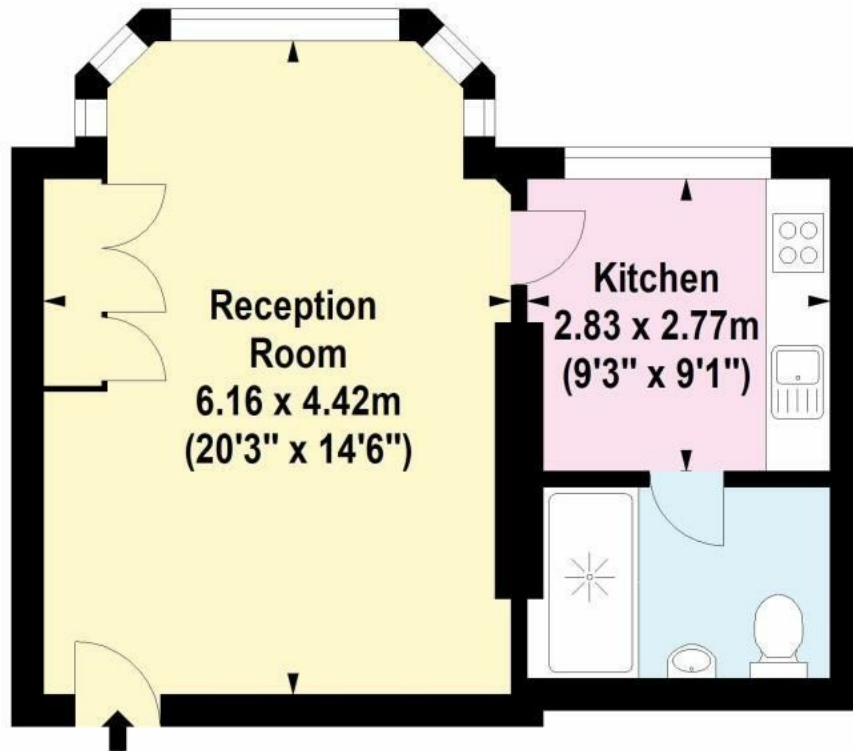

First Floor

For Identification Purposes Only. Not To Scale. © www.totalvista.uk 2022



Willesden Lane, NW6

Approx. Gross Internal Area
39.58 Sq M - 426 Sq Ft



Energy Efficiency Graph

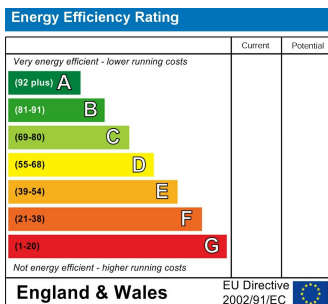

Viewing

Please contact our Lettings QP Office on 0207 604 4040 if you wish to arrange a viewing appointment for this property or require further information.

- Large studio flat
- Good storage
- Bright flat
- Large and modern kitchen
- High ceiling

For further information contact:

Lettings QP, 2a Brondesbury Road, London, NW6 6AS

Tel: 0207 604 4040 Email: info@jorgensenturner.com <https://www.jorgensenturner.com/>

Disclaimer

These particulars, whilst believed to be accurate are set out as a general outline only for guidance and do not constitute any part of an offer or contract. Intending purchasers should not rely on them as statements of representation of fact, but must satisfy themselves by inspection or otherwise as to their accuracy. No person in this firm's employment has the authority to make or give any representation or warranty in respect of the property.

