

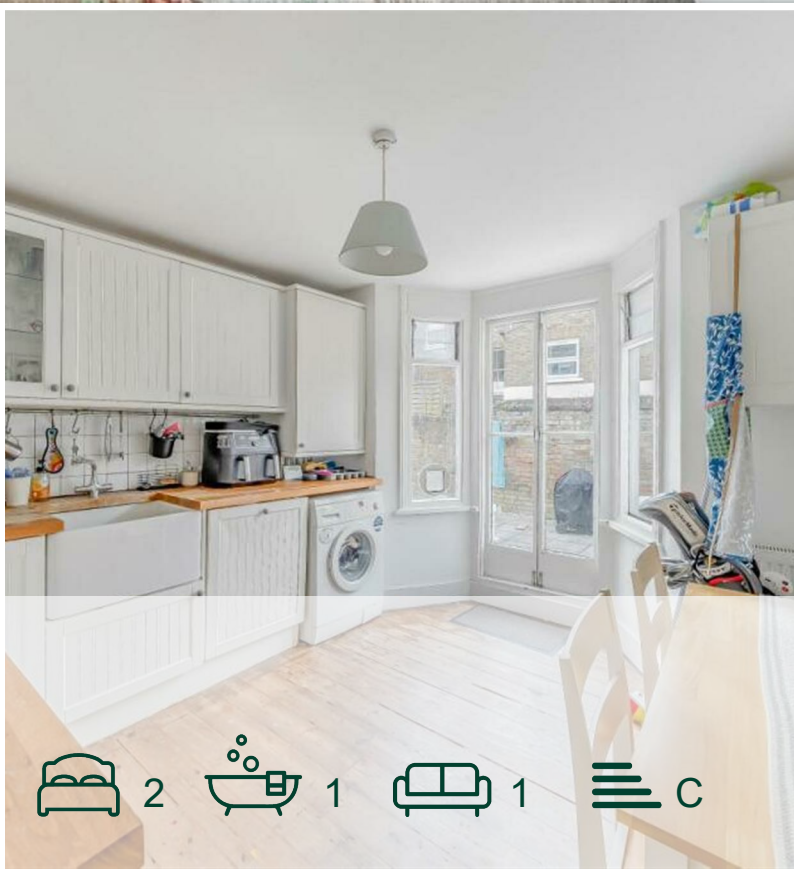

Priory Park Road, London,
NW6

£535,000



2 1 1 C

Priory Park Road, London, NW6

£535,000



Summary Description

Welcome to this charming Victorian flat conversion nestled in the heart of London. This delightful property, built in 1885, boasts a characterful 14' bay fronted sitting room that exudes elegance and style.

Step inside this Victorian conversion and be greeted by a space filled with original features that whisper stories of the past. With two cosy bedrooms, this property offers the perfect retreat for those seeking a touch of history in their home.

The highlight of this flat is the beautiful kitchen/breakfast room that leads out to a south-facing garden. Imagine starting your day with a cup of tea in the tranquil garden, basking in the warmth of the sun.

Whether you are a first-time buyer looking for a unique property with character or a seasoned homeowner appreciating the beauty of Victorian architecture, this flat in Priory Park Road is sure to capture your heart. Don't miss the opportunity to own a piece of London's history in this Victorian gem.

Area Map

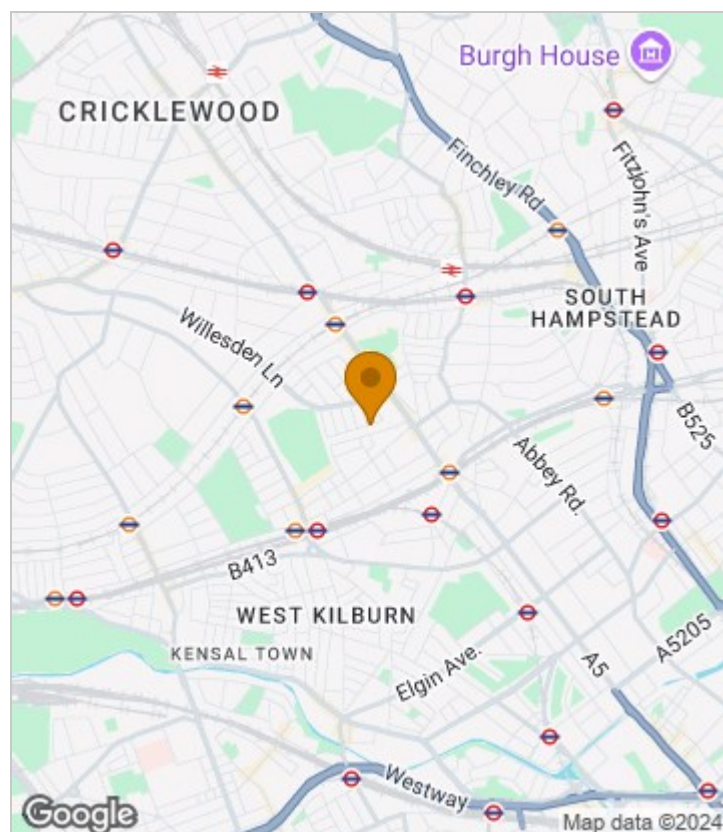



Floor Plan

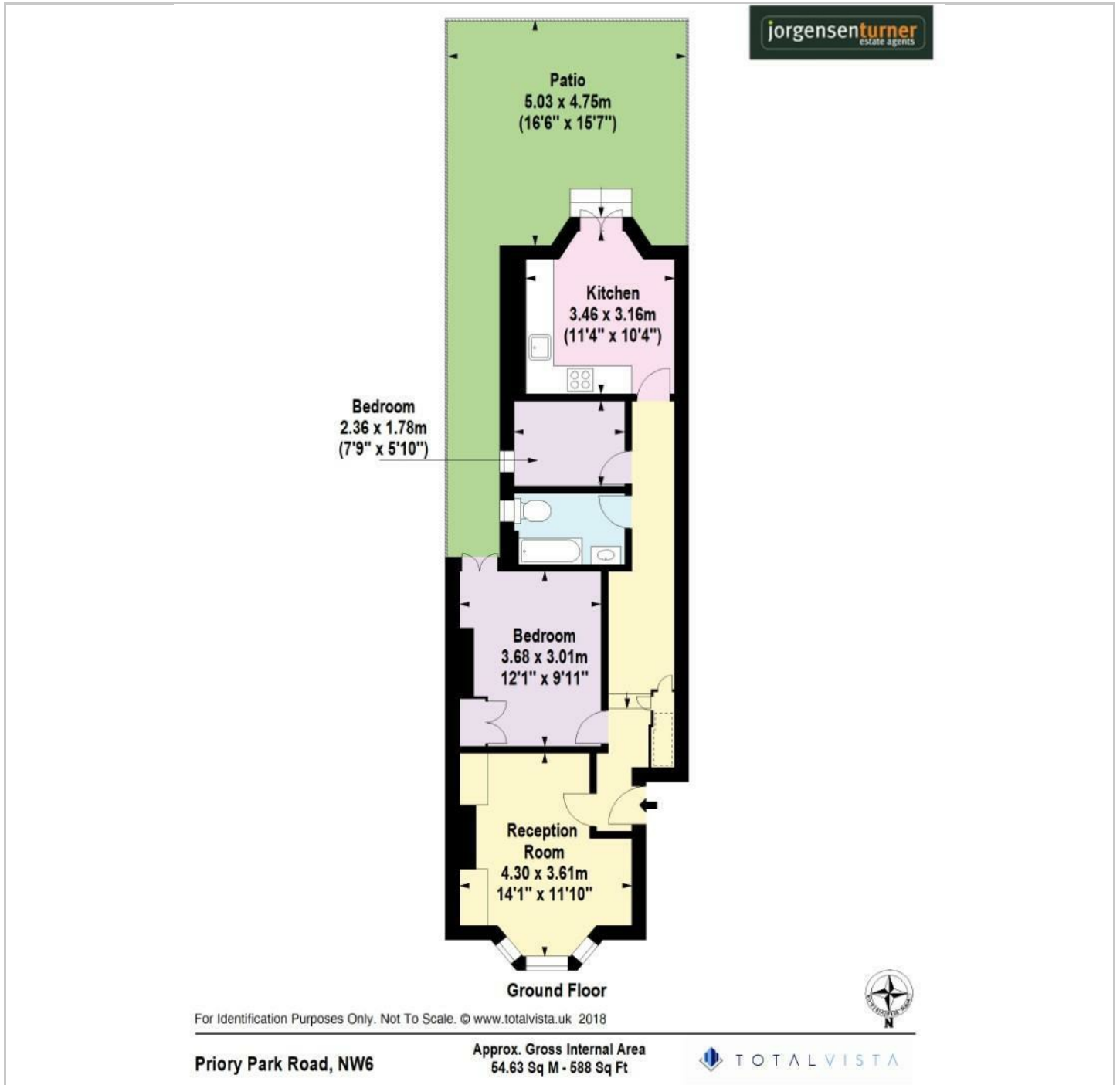

Energy Efficiency Graph

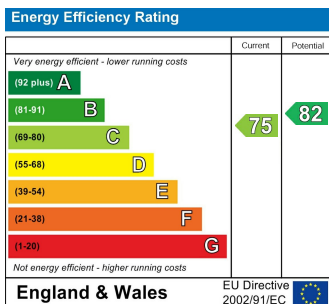

Viewing

Please contact our Sales QP Office on 0207 604 4040 if you wish to arrange a viewing appointment for this property or require further information.

- Two bedroom flat in a period
- Separate kitchen conversion
- Private garden
- Bright and spacious
- Walking distance to Salusbury Road
- Located on a quiet residential road

For further information contact:

Sales QP, 2a Brondesbury Road, London, NW6 6AS

Tel: 0207 604 4040 Email: info@jorgensenturner.com <https://www.jorgensenturner.com/>

Disclaimer

These particulars, whilst believed to be accurate are set out as a general outline only for guidance and do not constitute any part of an offer or contract. Intending purchasers should not rely on them as statements of representation of fact, but must satisfy themselves by inspection or otherwise as to their accuracy. No person in this firm's employment has the authority to make or give any representation or warranty in respect of the property.

