



Flat 20, Graceville Court Rose Creek Gardens, Great Sankey, Warrington, Cheshire, WA5 3TU
£925 PCM



Flat 20, Graceville Court Rose Creek Gardens, Great Sankey, Warrington,
Cheshire, WA5 2TH
£925 PCM

Modern top floor two bedroom apartment located within the popular Chapelford Village estate and is within walking distance of Sainsburys and Chapelford Farm family restaurant. The property comes with two double bedrooms, one with en-suite shower room and built in wardrobes, three piece bathroom suite with shower over the bath, open plan living room with Juliette balcony and fully fitted kitchen with fridge freezer, utility cupboard with washer/dryer, brand new carpets throughout there is also lift access to each floor and allocated parking.

AVAILABLE BEINNING OF AUGUST 2025

Description



Council Tax Band:



Floor Plans

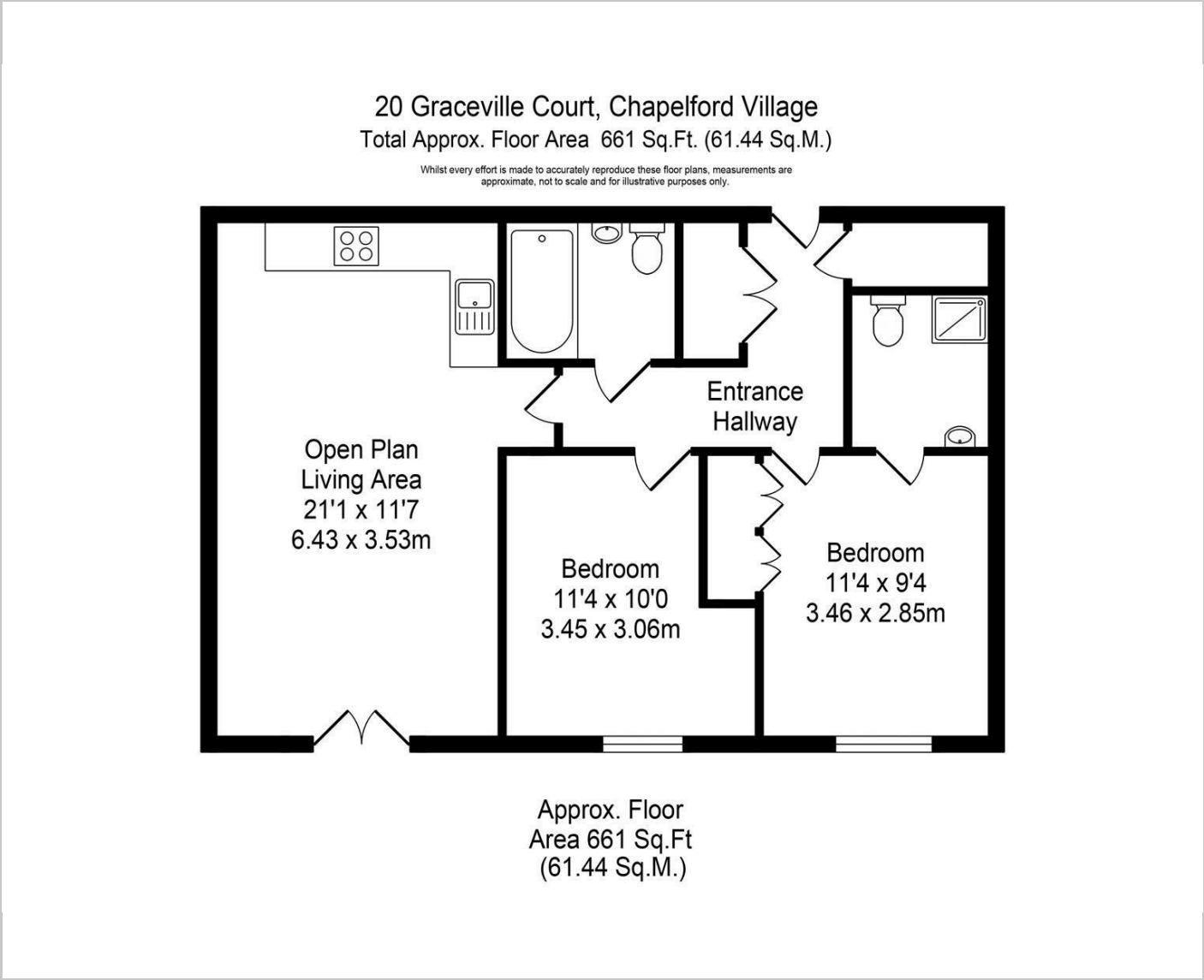

Area Map

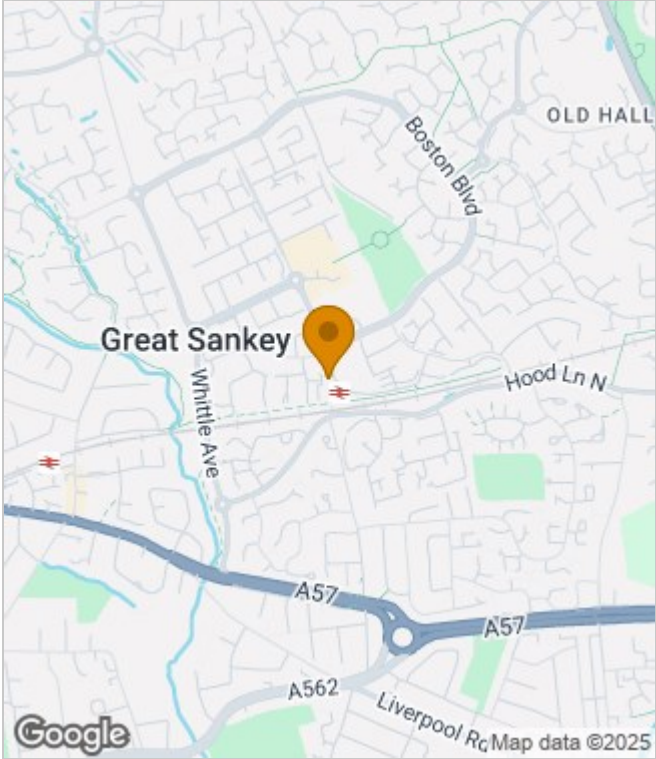

Energy Performance Graph

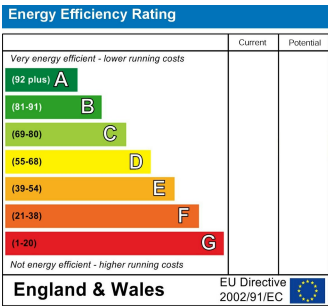

These particulars, whilst believed to be accurate are set out as a general outline only for guidance and do not constitute any part of an offer or contract. Intending purchasers should not rely on them as statements of representation of fact, but must satisfy themselves by inspection or otherwise as to their accuracy. No person in this firms employment has the authority to make or give any representation or warranty in respect of the property.