



**DECLAN  
JAMES** ESTATE  
AGENTS



12 Grove Avenue, Lymm, WA13 0HF  
£300,000



12 Grove Avenue, Lymm, WA13 0HF

£300,000

AN EXTREMELY STYLISH COTTAGE WITH ORIGINAL FEATURES SITUATED WITHIN WALKING DISTANCE OF LYMM VILLAGE AND LOCAL AMENITIES. The Cottage comprises a porch, dining room with exposed brick fireplace open to the lounge area with cast iron fireplace. Modern kitchen leading into the contemporary extension with doors into the courtyard garden. Upstairs there are two double bedrooms and a bathroom with separate shower room. Small garden to the front and courtyard to the rear.

## Description



## Situation



null

Council Tax Band: C

Available:

## Floor Plans

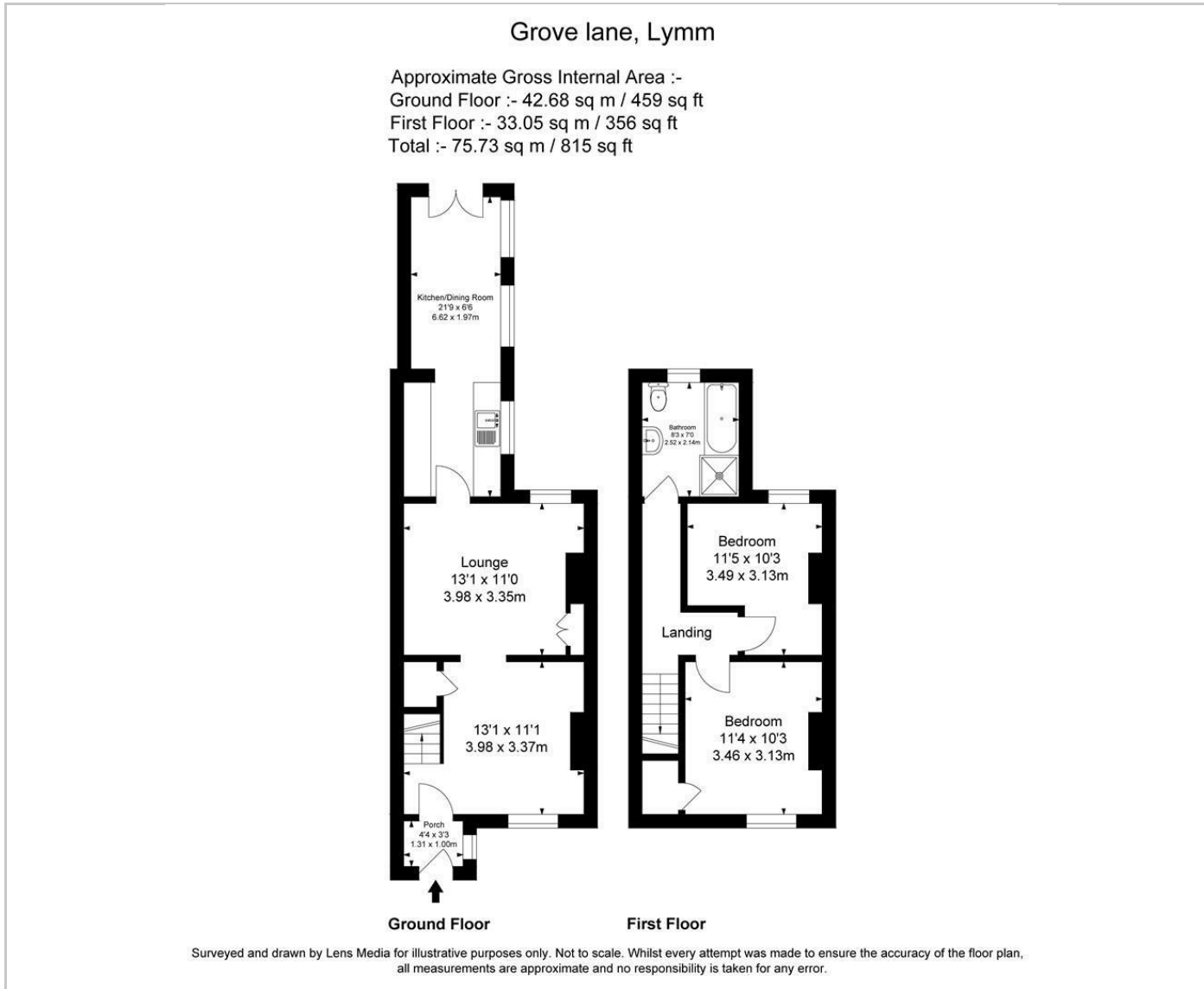

## Area Map

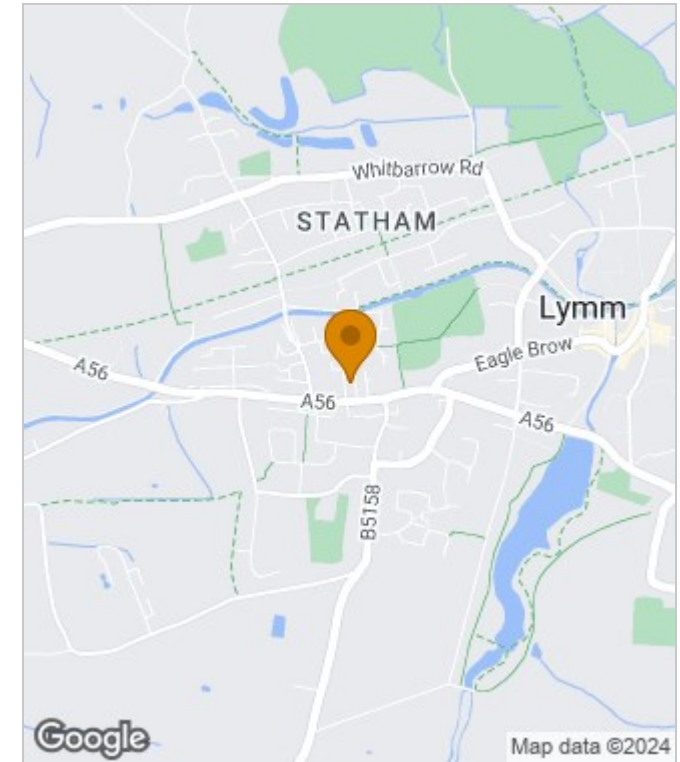

## Energy Performance Graph

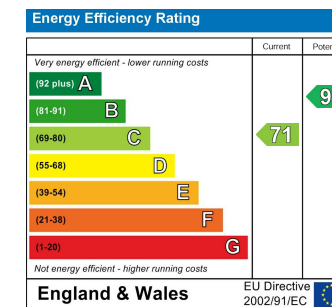

These particulars, whilst believed to be accurate are set out as a general outline only for guidance and do not constitute any part of an offer or contract. Intending purchasers should not rely on them as statements of representation of fact, but must satisfy themselves by inspection or otherwise as to their accuracy. No person in this firm's employment has the authority to make or give any representation or warranty in respect of the property.