



Newfield Cottage West Hyde, Lymm, WA13 0HA
£1,650 Per Month



Newfield Cottage West Hyde, Lymm, WA13 0HA

£1,650 Per Month

Newfield Cottage is a delightful period property which is one of Lymm's original Fustian cottages, it beautifully combines history, charm, and character. This enchanting cottage features an inviting open-plan kitchen diner, which flows seamlessly into a utility room, making daily living both practical and enjoyable. The living room boasts an open fire and exposed brickwork adding a touch of warmth and character and creating a cosy atmosphere.

The rooms are bright and spacious and offer flexible living space.

With four well-proportioned bedrooms, 3 of which are doubles it offers ample space for families or those seeking a comfortable home. The property is complemented by a pretty, good-sized courtyard garden, providing a lovely outdoor space for relaxation or entertaining guests.

This charming cottage is a rare find, offering a unique blend of historical allure and modern living in a sought-after location.

Newfield Cottage is ideally located within walking distance to Lymm Village, where you can explore local parks, charming shops, and delightful eateries.

Description

- Charming Original Fustian Cottage
- 4 Great Size Bedrooms
- Open Plan Kitchen Diner
- Feature Open Fire and Exposed Brick Work
- Pretty Court Yard Garden
- Walking Distance to Lymm Village
- Close to Local Parks and Bridgewater Canal



Council Tax Band: D

Floor Plans

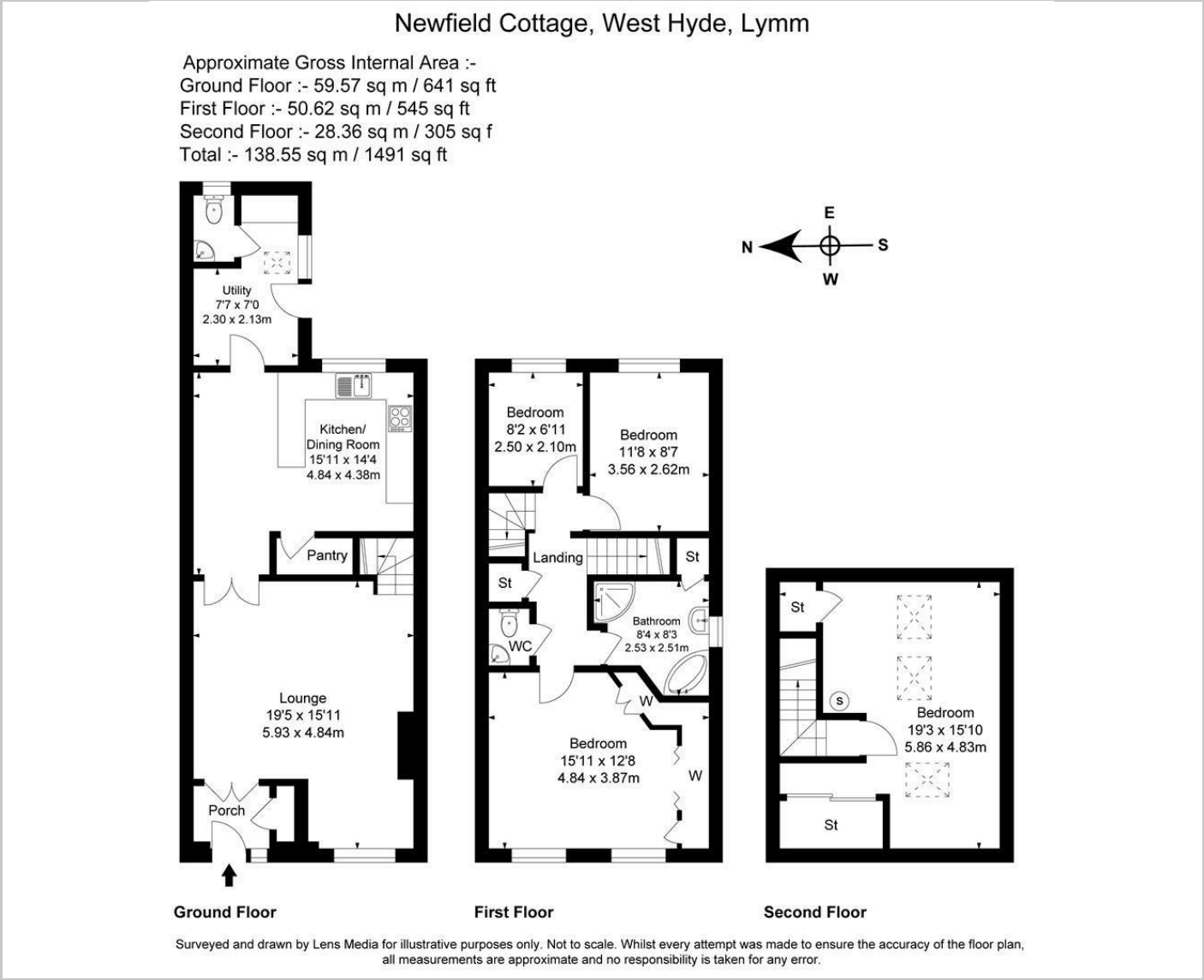

Area Map

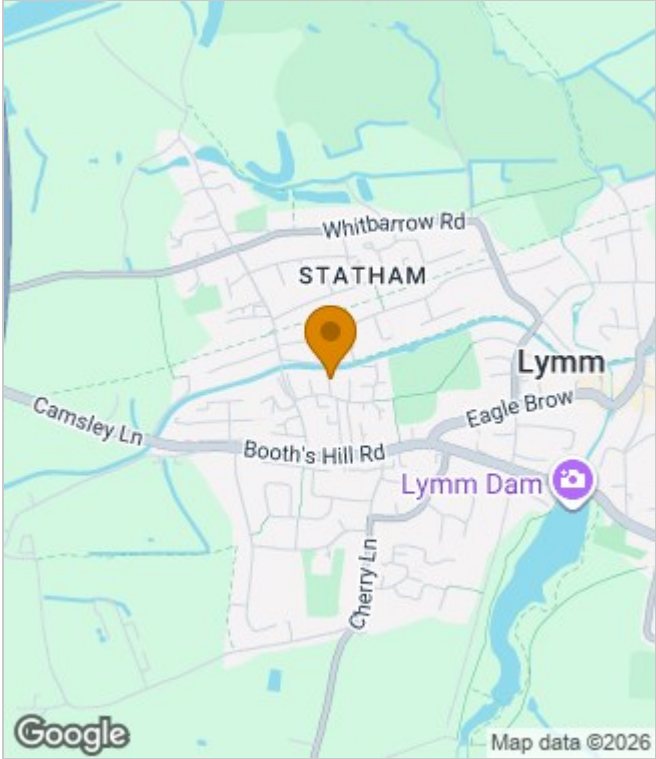

Energy Performance Graph

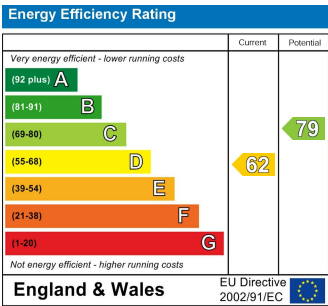

These particulars, whilst believed to be accurate are set out as a general outline only for guidance and do not constitute any part of an offer or contract. Intending purchasers should not rely on them as statements of representation of fact, but must satisfy themselves by inspection or otherwise as to their accuracy. No person in this firms employment has the authority to make or give any representation or warranty in respect of the property.