



21 Canal Bank, Lymm, WA13 9NR

£850,000



21 Canal Bank, Lymm, WA13 9NR

£850,000

SOLD BEFORE GOING TO MARKET

FABULOUS DETACHED PROPERTY SITUATED ON THE BANKS OF THE BRIDGEWATER CANAL WITH FAR REACHING VIEWS OVER THE ROOFTOPS AT THE REAR. This amazing Old Forge comprises a ground floor utility/kitchen, two reception rooms and shower room. This area could be utilised as an annexe with access out into the garden. On the first floor there is a dining area, fully fitted modern kitchen and access to a cantilever conservatory with far reaching views over towards Winter Hill. There is a lovely lounge/dining room and porch to the front. On the second floor there is a master bedroom and ensuite overlooking the Bridgewater Canal, two further double bedrooms, one is being used as a dressing room and family bathroom with roll top bath and separate shower cubicle. The property can be approached from Barsbank Lane along the Bridgewater Canal tow path leading through electric double gates to the detached double garage. The rear garden is a particular feature of this property with mature shrubs and trees, patios, summer house and further rear vehicular access. The views over the Bridgewater Canal are fabulous with wildlife and narrowboats passing by and within walking distance of Lymm Village Centre.

Description



Council Tax Band:

Floor Plans

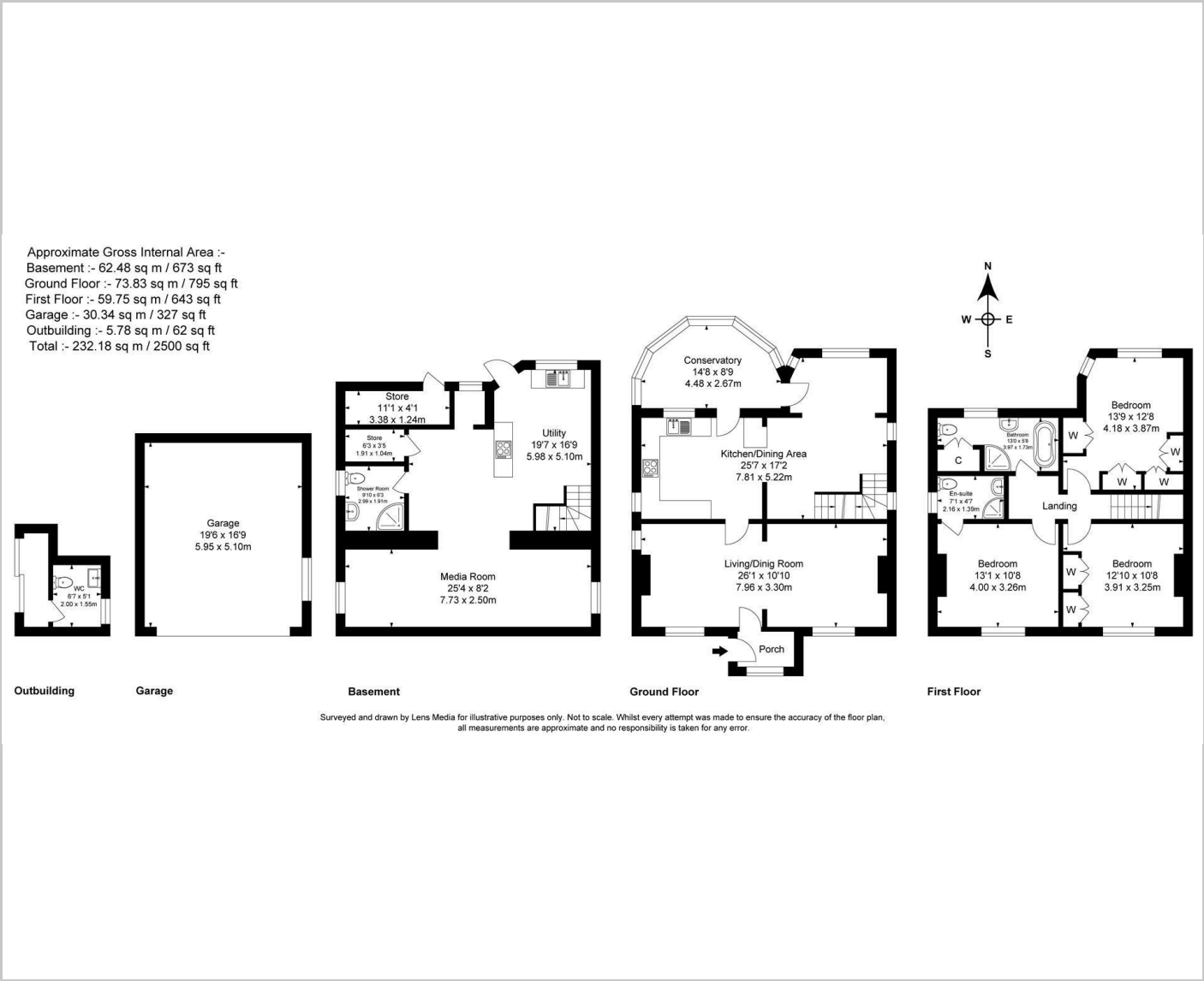

Area Map



Energy Performance Graph

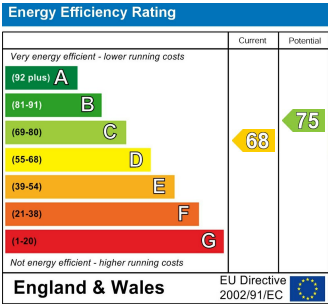

These particulars, whilst believed to be accurate are set out as a general outline only for guidance and do not constitute any part of an offer or contract. Intending purchasers should not rely on them as statements of representation of fact, but must satisfy themselves by inspection or otherwise as to their accuracy. No person in this firms employment has the authority to make or give any representation or warranty in respect of the property.