



Oak Lawn Crouchley Lane, Lymm, WA13 0TH  
**£6,000 Per Month**





## Oak Lawn Crouchley Lane, Lymm, WA13 0TH

£6,000 Per Month

This unique 4/5 bedroomed detached house offers a perfect blend of modern luxury and serene countryside living. Recently extended and fully renovated, the property boasts an impressive four spacious double rooms, providing ample space for family and guests and offering stunning views from every window.

As you approach the property through the gated entrance, you are welcomed into a home that exudes sophistication and high specification finishes throughout. The three reception rooms are thoughtfully designed, offering versatile spaces for relaxation, entertainment, or family gatherings, the open plan kitchen / dining living space with central island is a standout feature with bi-fold doors onto the rear garden.

The property features three modern and stylish bathrooms, and a great size utility/boot room.

Externally the property has a newly laid resin driveway, a triple garage, and the stunning lawned areas surround the property as do the field views.

This remarkable home is not just a place to live; it is a lifestyle choice, offering both privacy and the charm of rural living while being conveniently located near local amenities. Whether you are looking for a family home or a peaceful retreat, this property on Crouchley Lane is sure to impress. Don't miss the opportunity to make this exquisite house your new home.



## Description



Council Tax Band: G

Floor Plans

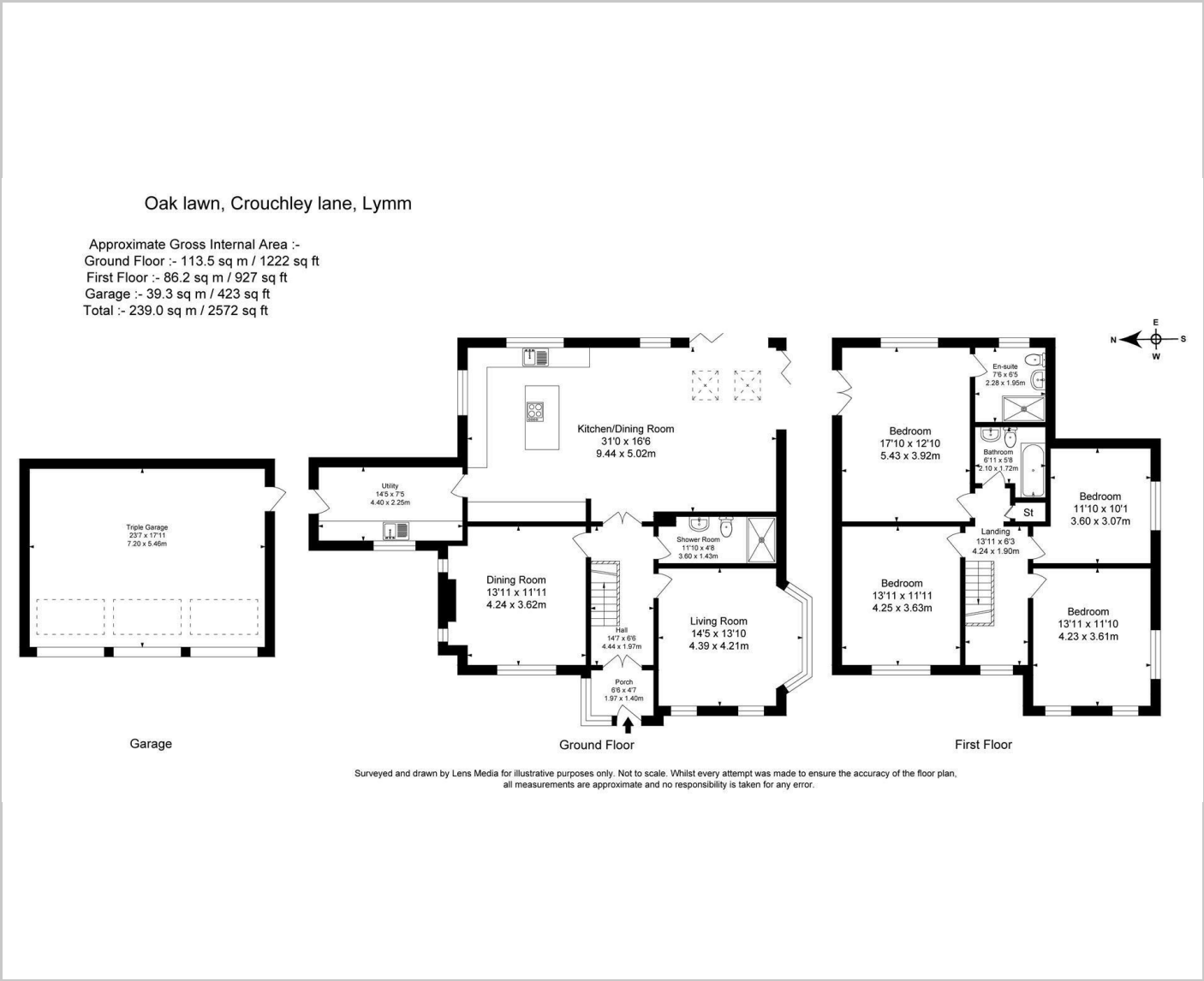

Area Map

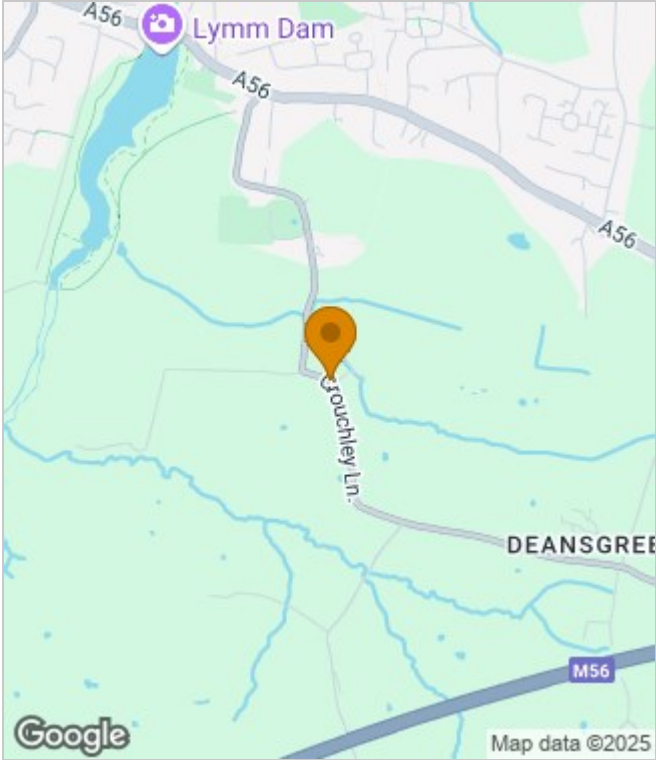

Energy Performance Graph

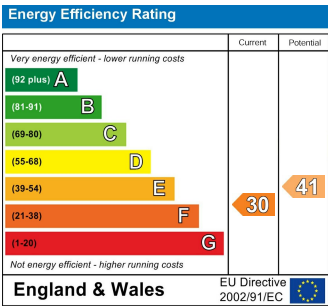

These particulars, whilst believed to be accurate are set out as a general outline only for guidance and do not constitute any part of an offer or contract. Intending purchasers should not rely on them as statements of representation of fact, but must satisfy themselves by inspection or otherwise as to their accuracy. No person in this firms employment has the authority to make or give any representation or warranty in respect of the property.