



Vincent House, 34 Queen Street, Knutsford, WA16 6HZ  
£1,200 Per Month



Vincent House, 34 Queen Street, Knutsford, WA16 6HZ

£1,200 Per Month

A modern spacious ground floor two bedroom apartment. Great location close to the town centre and Tatton Park. The property comprises of an open plan modern kitchen, large living/dining room. 2 bedrooms both with en-suite. Private parking and communal gardens.

## Description



Council Tax Band: D

## Floor Plans

### Queen street, Knutsford

Approximate Gross Internal Area :- 74.81 sq m / 805 sq ft

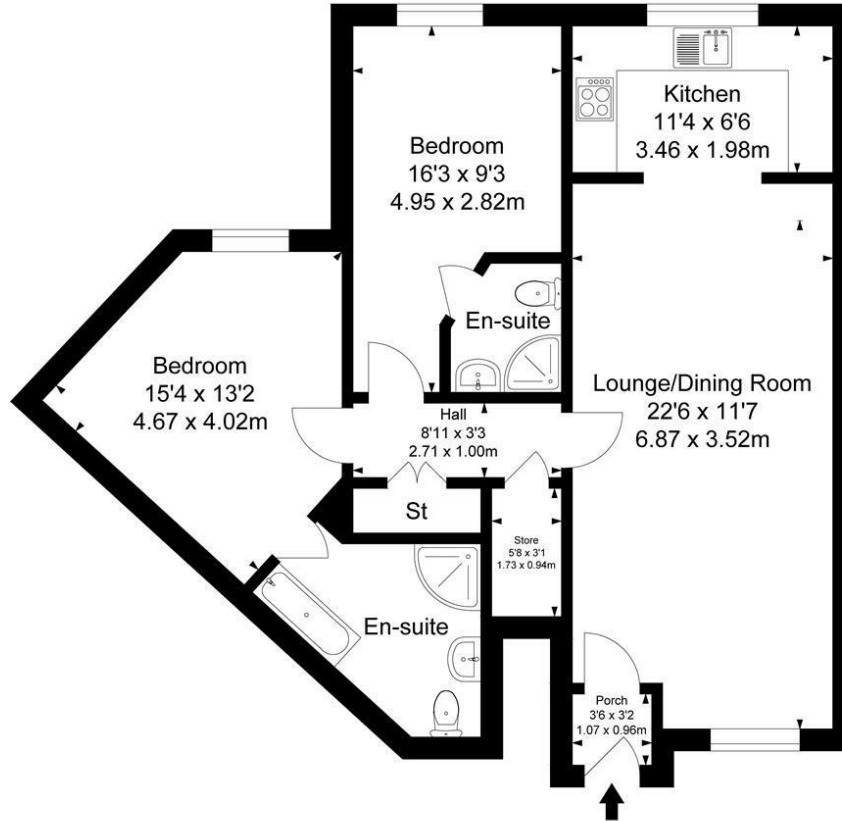

Surveyed and drawn by Lens Media for illustrative purposes only. Not to scale. Whilst every attempt was made to ensure the accuracy of the floor plan, all measurements are approximate and no responsibility is taken for any error.

## Area Map

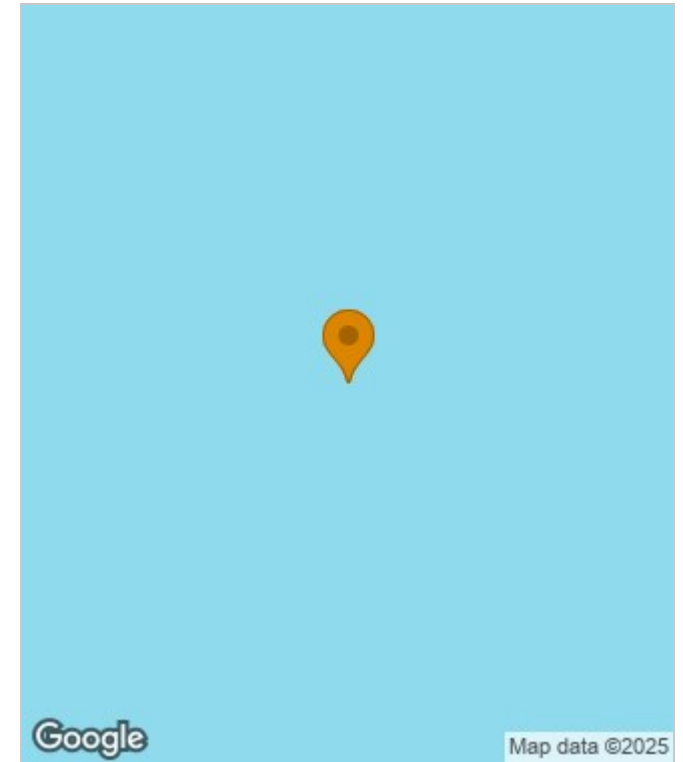

## Energy Performance Graph

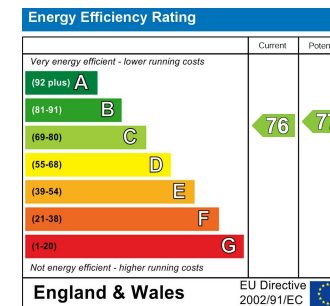

These particulars, whilst believed to be accurate are set out as a general outline only for guidance and do not constitute any part of an offer or contract. Intending purchasers should not rely on them as statements of representation of fact, but must satisfy themselves by inspection or otherwise as to their accuracy. No person in this firms employment has the authority to make or give any representation or warranty in respect of the property.