



1 Sandmoor Place, Lymm, Cheshire, WA13 0LQ

**£130,000**



1 Sandmoor Place, Lymm, Cheshire, WA13 0LQ

£130,000

FABULOUS GROUND FLOOR APARTMENT. Hall, lounge with two windows, double bedroom to the rear, bathroom and separate kitchen with space for a small table. Ideal for a first time buyer, downsizer or buy to let.

## Description



Council Tax Band: B

Floor Plans

Sandmoor Place, Lymm

Approximate Gross Internal Area :-  
Ground Floor :- 39.24 sq m / 422 sq ft  
Total :- 39.24 sq m / 422 sq ft

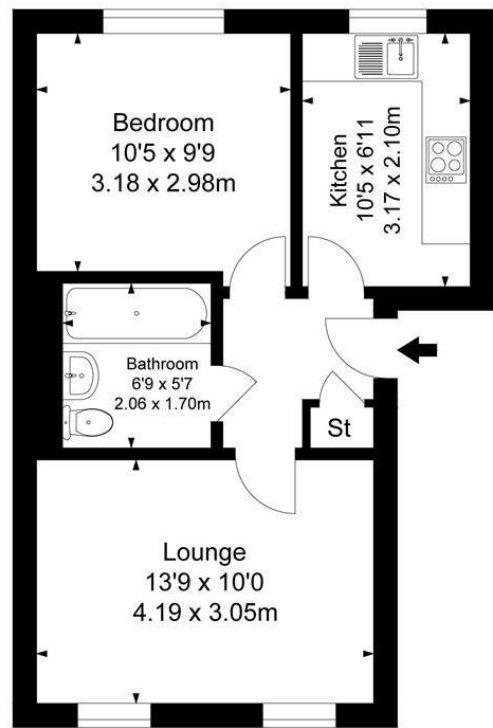

Ground Floor

Whilst every effort is made to accurately reproduce these floor plans, measurements are approximate, not to scale and for illustrative purposes only

Area Map

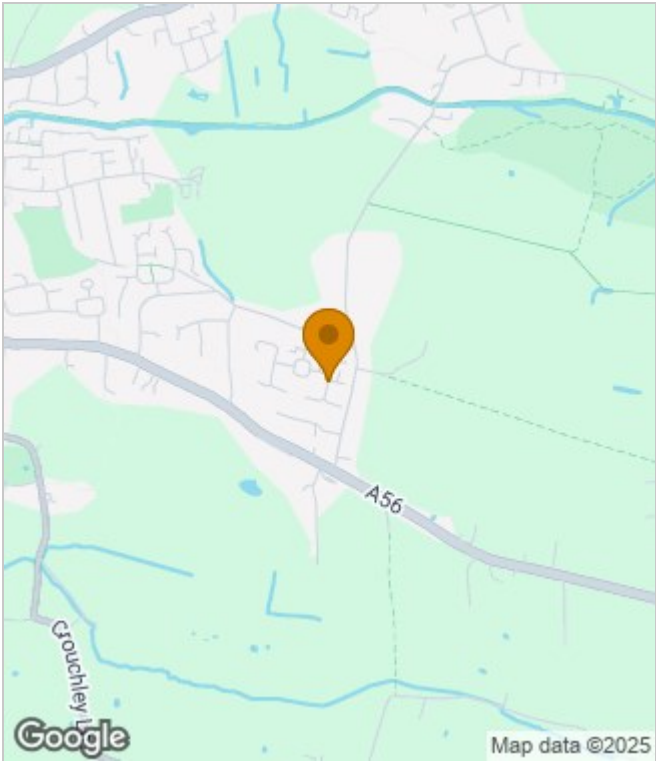

Energy Performance Graph

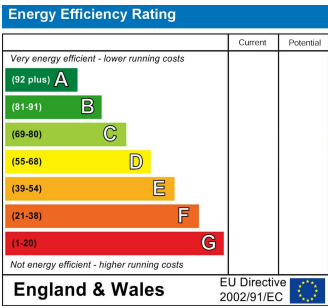

These particulars, whilst believed to be accurate are set out as a general outline only for guidance and do not constitute any part of an offer or contract. Intending purchasers should not rely on them as statements of representation of fact, but must satisfy themselves by inspection or otherwise as to their accuracy. No person in this firms employment has the authority to make or give any representation or warranty in respect of the property.